



For Sale: Leasehold  
Guide Price £155,000 to £165,000  
Church Street, Crawley, RH11

- Double Bedroom
- Open Plan Kitchen / Living Room
- Close to Town Centre
- Close to Rail Links

Arington 

Guide Price: £155,000 to £165,000. Arington are pleased to offer a one double bedroom first floor apartment in a purpose built block. The apartment is well located for access to Crawley town centre, rail links and Goffs park. The apartment consists of an open plan kitchen / living room, separate WC, bathroom and double bedroom. Council Tax Band: A.

- Internal** Door to...
- Living Room** Window. Opening and door to...
- Kitchen** Fitted with a range of floor and wall units with a granite effect worktop with inset four-point hob with oven under and extractor over. Space and plumbing for a washing machine. Part tiled walls.
- Hallway** Doors to...
- WC** Low level WC.
- Bedroom** Windows. Airing cupboard. Door to...
- Bathroom** Fitted with a suite comprising of a panelled bath and pedestal basin. Part tiled walls.
- Other**
  - Lease: 99 Years from 25th March 2007.
  - Ground Rent: TBC
  - Service charge: TBC



# Room Details

## Internal

Living Room 11'8" x 9'2" (3.56m x 2.79m)

Kitchen 8'7" x 5'6" (2.62m x 1.68m)

Bedroom 11'9" x 10'9" (3.58m x 3.28m)

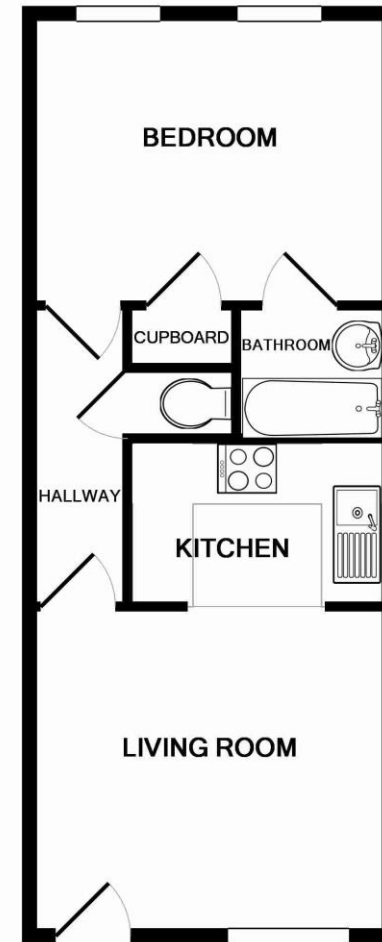

TOTAL APPROX. FLOOR AREA 352 SQ.FT. (32.7 SQ.M.)

Whilst every attempt has been made to ensure the accuracy of the floor plan contained here, measurements of doors, windows, rooms and any other items are approximate and no responsibility is taken for any error, omission, or mis-statement. This plan is for illustrative purposes only and should be used as such by any prospective purchaser. The services, systems and appliances shown have not been tested and no guarantee as to their operability or efficiency can be given

Made with Metropix ©2016

Descriptions of the property are subjective and are used in good faith as an opinion and NOT as a statement of fact. Please make further specific enquires to ensure that our descriptions are likely to match any expectations you may have of the property. We have not tested any services, systems or appliances at this property. We strongly recommend that all the information we provide be verified by you on inspection, and by your Surveyor and Conveyancer.