



For Sale: Leasehold
Keymer Road, West Sussex, BN6

- Two Double Bedrooms
- Views of the South Downs National Park
- Top Floor
- (Second Floor)

Arington 

Arington

Arington are pleased to offer to market a two-bedroom top floor apartment, with far reaching views of the South Downs National Park. The apartment is in need of modernisation and consists of a 17' living room, master bedroom and second double bedroom all with South facing windows overlooking Hassocks high street and with far reaching views over the properties opposite to the South Downs and Jack & Jill windmills. In addition to the living room and bedrooms are a 23' kitchen / dining room, bathroom and entrance hall. The apartment has a door entry system, Gas Fired Central Heating and Double Glazing. The apartment additionally benefits from an allocated parking space. Located on Keymer Road in Hassocks the apartment is centrally located with shops, cafes and the main line train station (approx. 0.1 mile) all within easy reach. The apartment has a low lease of 99 years from 9th September 1974 and would suit cash buyers. Council Tax Band: C. EPC: TBC.

Vendors Views:

I have loved living in this light filled flat and within a village with a great community. The location could not be better with the high street down stairs and the station up the road, so you can pop down to Brighton for the nightlife or commute up to London on the fast train service. In addition, for lazy Sunday afternoons, a walk along the South Downs to a country pub is perfect. It's been a great place to settle.

Other:

Lease: 99 Years from 9th September 1974

Ground Rent: £20 per annum

Service Charge: £600 for the 6 month period to 30th September 2019.



Room Details

Entrance Hall	6'11" x 6'6" (2.11m x 1.98m)
Living Room	17'11" x 12'0" (5.46m x 3.66m)
Bedroom	14'10" x 10'0" (4.52m x 3.05m)
Master Bedroom	14'10" max x 10'11" (4.52m max x 3.33m)
Bathroom	10'2" x 6'11" (3.10m x 2.11m)
Kitchen / Dining Room	23'5" x 6'11" (7.14m x 2.11m)

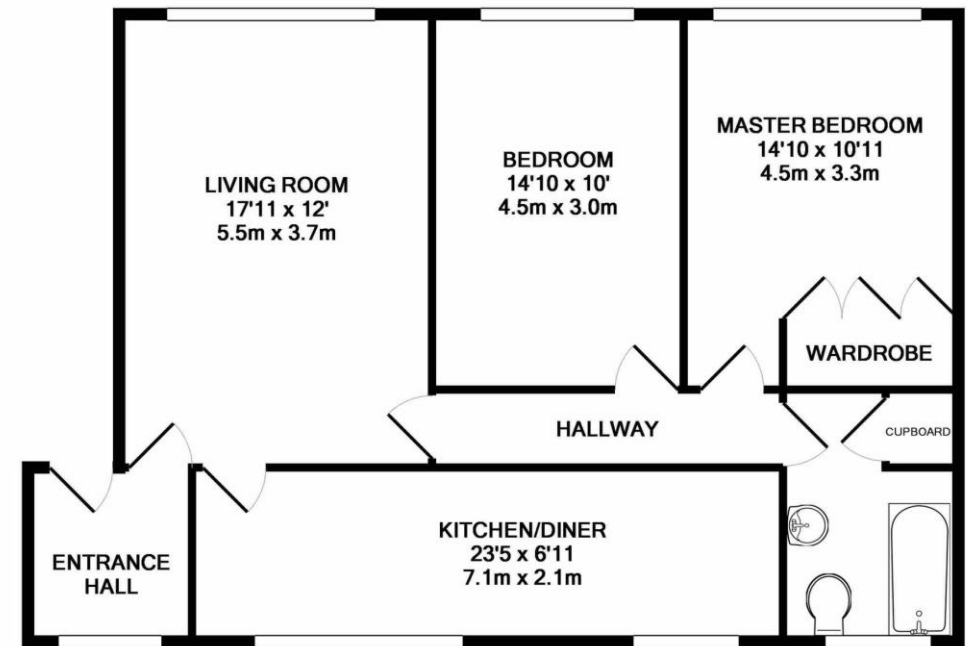

TOTAL APPROX. FLOOR AREA 851 SQ.FT. (79.1 SQ.M.)

Whilst every attempt has been made to ensure the accuracy of the floor plan contained here, measurements of doors, windows, rooms and any other items are approximate and no responsibility is taken for any error, omission, or mis-statement. This plan is for illustrative purposes only and should be used as such by any prospective purchaser. The services, systems and appliances shown have not been tested and no guarantee as to their operability or efficiency can be given
Made with Metropix ©2019

Descriptions of the property are subjective and are used in good faith as an opinion and NOT as a statement of fact. Please make further specific enquires to ensure that our descriptions are likely to match any expectations you may have of the property. We have not tested any services, systems or appliances at this property. We strongly recommend that all the information we provide be verified by you on inspection, and by your Surveyor and Conveyancer.

