



For Sale: OIEO £190,000 Leasehold
Keymer Court, West Sussex, RH15

- Two Double Bedrooms
- Modern Bathroom
- Modern Fitted Kitchen
- Communal Parking

Arington 

Arlington are pleased to offer this recently renovated and well presented ground floor two double bedroom apartment, located within easy reach of Burgess Hill train station and town centre. In addition to the two double bedrooms is a modern fitted kitchen, modern bathroom with bath with shower over and light and spacious feeling living / dining room. The apartment is double glazed and has GFCH. The apartment will benefit from an extended lease with approx. 146 years remaining. Externally, is communal permit parking and communal gardens. Council Tax Band: B. A viewing is highly recommended.

Entrance Hall	Meter cupboard. Fuse box. Door to the bathroom and opening to...
Living / dining room	Window to the front. Doors to both bedrooms. Open plan to...
Kitchen	Fitted with a range of modern floor and wall units with wood effect worktop and tiled splashbacks. Fitted single oven with inset hob over and stainless-steel extractor above. Fitted stainless steel single sink with drainer. Window to the rear. Boiler fitted in cupboard. Space for fridge / freezer.
Bathroom	Fitted with a modern white suite comprising of a WC, wall hung basin and panelled bath with shower attachment. Tiled floor and walls. Towel radiator. Two windows.
Master Bedroom	Window to the front.
Bedroom	Window to the rear.
Other	Lease: 189 years from 25th December 1976. Ground Rent: Peppercorn (zero) Service charge: for the period 1 st January 2020 to 31 st December 2020 - £960.00



Room Details

Living / dining room	15'6" x 12'5" (4.72m x 3.78m)
Kitchen	9'9" x 6'2" (2.97m x 1.88m)
Master Bedroom	12'1" x 9'11" (3.68m x 3.02m)
Bedroom	10'5" max x 9'3" (3.18m max x 2.82m)

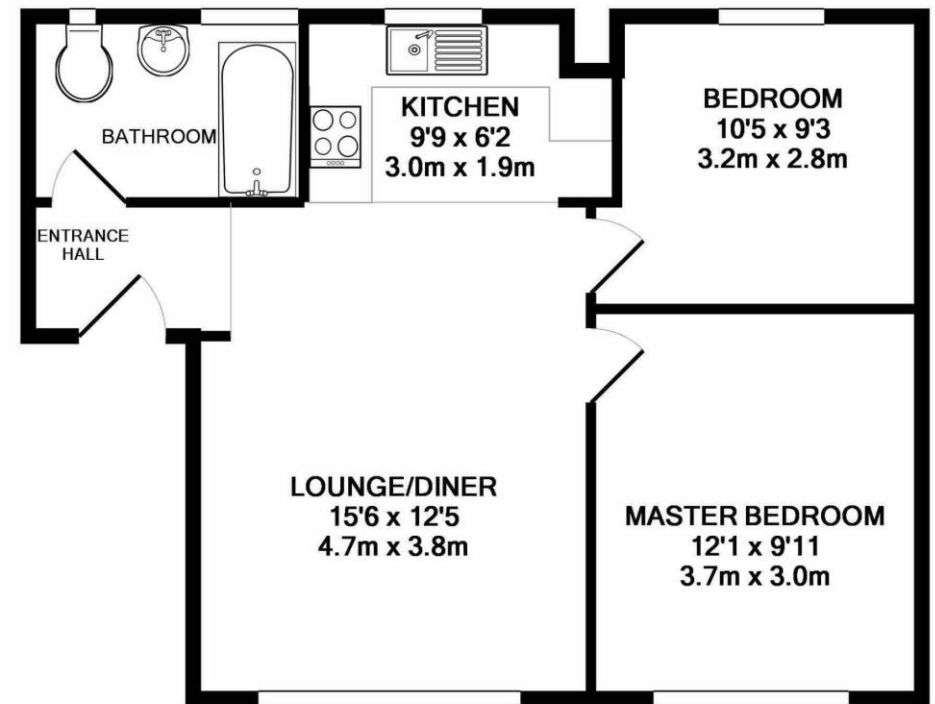

TOTAL APPROX. FLOOR AREA 540 SQ.FT. (50.2 SQ.M.)

Whilst every attempt has been made to ensure the accuracy of the floor plan contained here, measurements of doors, windows, rooms and any other items are approximate and no responsibility is taken for any error, omission, or mis-statement. This plan is for illustrative purposes only and should be used as such by any prospective purchaser. The services, systems and appliances shown have not been tested and no guarantee as to their operability or efficiency can be given

Made with Metropix ©2020

Descriptions of the property are subjective and are used in good faith as an opinion and NOT as a statement of fact. Please make further specific enquires to ensure that our descriptions are likely to match any expectations you may have of the property. We have not tested any services, systems or appliances at this property. We strongly recommend that all the information we provide be verified by you on inspection, and by your Surveyor and Conveyancer.

