

We have prepared these property particulars as a general guide to a broad description of the property. They are not intended to constitute part of an offer or contract. We have not carried out a structural survey and the services, appliances and specific fittings have not been tested. All photographs, measurements, floorplans and distances referred to are given as a guide only and should not be relied upon for purchase of carpets or any other fixtures or fittings. Lease details, service charges and prior to exchange of contracts, the copyright of all details, photographs and floorplans remain exclusive to Ashton Reeves.

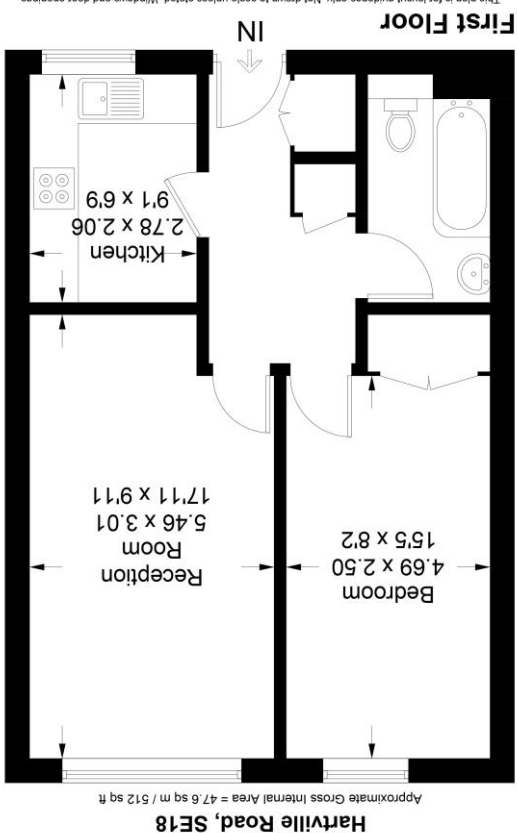

This plan is for layout guidance only. Not drawn to scale unless stated. Windows and door openings are approximate. Whilst every care is taken in the preparation of this plan, please check all dimensions, shapes and compass bearings before making any decisions reliant upon them. Produced by Plankin on behalf of Ashton Reeves (DB20284)

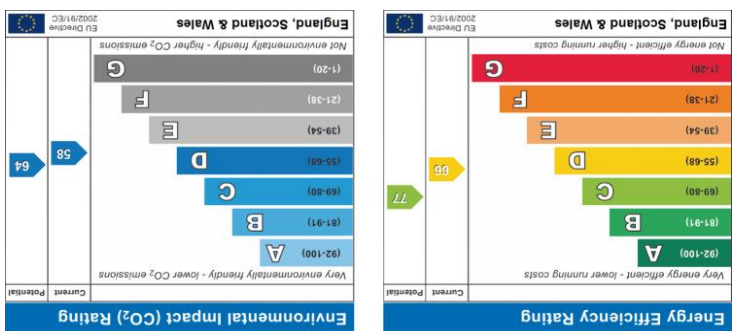

27 Hartville Road Plumstead, London, SE18 1DQ

£1,000 per month

Ashton Reeves would like to offer this large one bedroom first floor flat within a purpose built block. This flat has being fully refurbished to a high modern standard throughout. The property benefits from gas central heating, new carpets, secure Entryphone system, new modern fitted kitchen, large double bedroom with fitted wardrobes, a new 3 piece bathroom suite and a large lounge. This flat is situated just a short walk from Plumstead High Street and the local mainline train station. Also close to local amenities, shops and transport links.

PLEASE NOTE the landlord of this property is also the Director of Bexletts Ltd trading as, Ashton Reeves and the director of the company that owns this property.

KEY FEATURES

- One double Bedroom with fitted wardrobed
- Gas Central Heating
- New Modern Kitchen & Bathroom
- Secure entry phone system
- New Carpets
- Newly Refurbished

VIEWINGS

Strictly by prior appointment through Ashton Reeves office on: 01322 559 955

