

We have prepared these property particulars as a general guide to a broad description of the property. They are not intended to constitute part of an offer or contract. We have not carried out a structural survey and the services, appliances and specific fittings have not been tested. All photographs, measurements, floorplans and distances referred to are given as a guide only and should not be relied upon for purchase of carpets or any other fixtures or fittings. Lease details, service charges and prior to exchange of contracts, the copyright of all details, photographs and floorplans remain exclusive to Ashton Reeves.

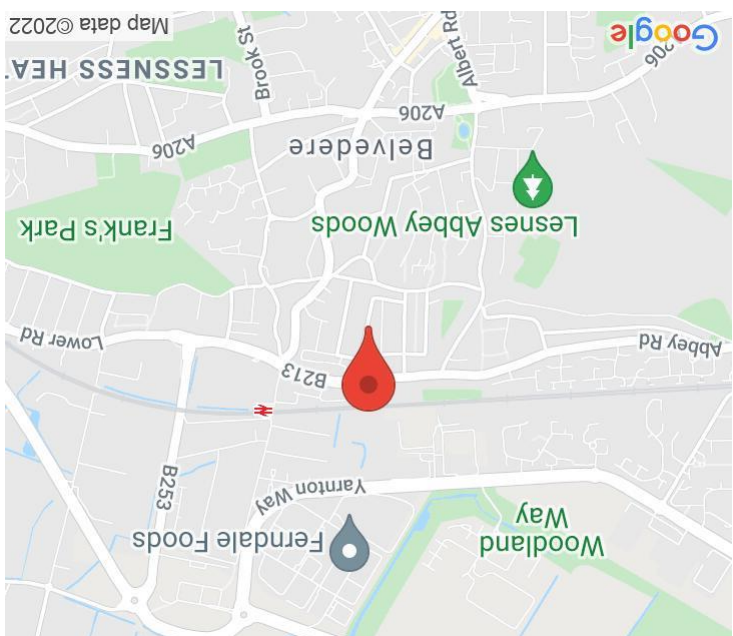

This plan is for layout guidance only. Not drawn to scale unless stated. Windows and door openings are approximate. Whilst every care is taken in the preparation of this plan, please check all dimensions, shapes and compass bearings before making any decisions reliant upon them. Produced by Planitx on behalf of Ashton Reeves (18824554)

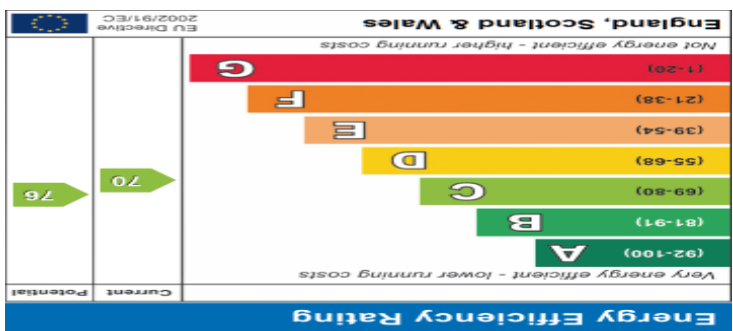
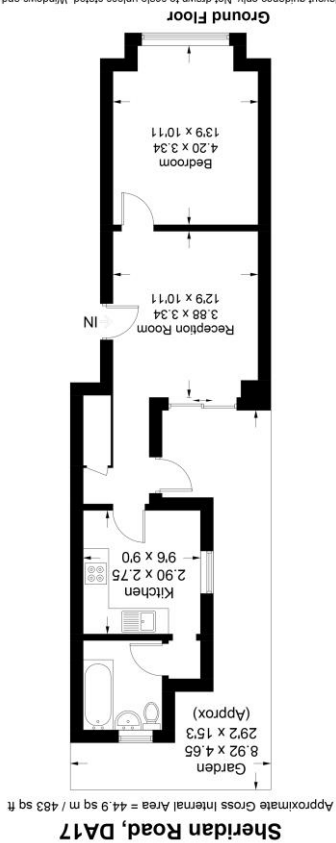

# Ground Floor, 33 Sheridan Road Belvedere, DA17 5AR

## £995 per month

Ashton Reeves are pleased to present this one bedroom ground floor flat situated in Belvedere. The property comprises of a large through lounge, fitted kitchen, double bedroom. Property has gas central heating and double glazing throughout. Short 10 minute walk to Belvedere train station, and close to local schools and amenities.

PLEASE NOTE the landlord of this property is also the Director of Bexletts Ltd trading as, Ashton Reeves and the director of the company that owns this property.

### KEY FEATURES

- One double bedroom
- Through Lounge
- Bathroom
- Modern Decoration
- Fitted kitchen
- Close to local schools

### VIEWINGS

Strictly by prior appointment through Ashton Reeves office on: 01322 559 955

