



@ashtonreevesestateagents

@ashtonreevesestateagents

A: 67 Bexley High St, Bexley, Kent DA5 1AA  
T: 01322 559 955 | F: 01322 525 214  
E: info@ashtonreeves.co.uk | W: ashtonreeves.co.uk

We have prepared these property particulars as a general guide to a broad description of the property. They are not intended to constitute part of an offer or contract. We have not carried out a structural survey and the services, appliances and specific fittings have not been tested. All photographs, measurements, floorplans and distances referred to are given as a guide only and should not be relied upon for purchase of carpets or any other fixtures or fittings. Lease details, service charges and prior to exchange of contracts, the copyright of all details, photographs and floorplans remain exclusive to Ashton Reeves.

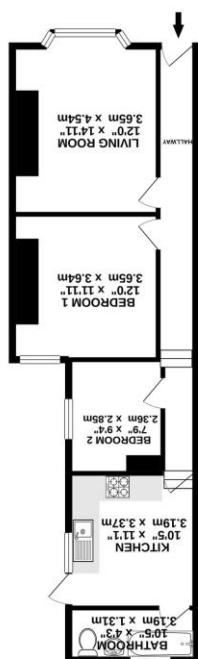
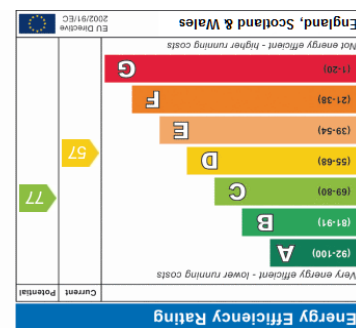
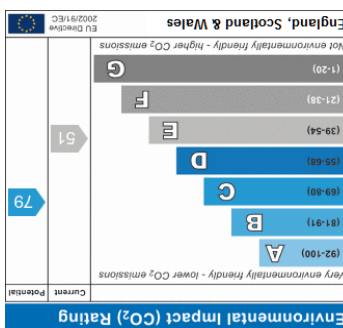

GROUND FLOOR





224b Riverdale Road  
Erith, DA8 1QE

£1,200 per month

Ashton Reeves are pleased to present this spacious two bedroom ground floor flat with private garden. This property has been fully refurbished to a high and modern standard of finish. Property is conveniently situated for local amenities, schools, mainline station and bus routes. The property comprises of lounge, brand new modern kitchen with appliances, two great size bedrooms and a modern white bathroom suite. Gas central heating and new double glazing throughout the property.

PLEASE NOTE the landlord of this property is also the Director of Bexletts Ltd trading as, Ashton Reeves and the director of the company that owns this property.

### KEY FEATURES

Modern And Spacious  
Ground Floor Flat  
Two Double Bedrooms  
Brand New Kitchen  
Fully Furnished  
Double Glazed

### VIEWINGS

Strictly by prior appointment through Ashton Reeves office on: 01322 559 955

