

Thorn Street Mews, Woodville, DE11

£149,950



CADLEY CAULDWELL are pleased to offer to the market this End-terraced property in a POPULAR RESIDENTIAL AREA and within easy access of local amenities and main routes. With NO CHAIN, and offering the POTENTIAL FOR FURTHER IMPROVEMENT, the property comprises Two Bedrooms, Shower Room, Kitchen / Diner, Living Room, Enclosed Rear Garden, Two Allocated Parking Spaces. Being IDEAL FOR FIRST TIME BUYERS and those wishing to DOWNSIZE, viewing is highly recommended.

To arrange your viewing Contact CADLEY CAULDWELL on 01283 217251.

Council tax band: A/EPC: TBC/Freehold

- NO CHAIN
- IDEAL FIRST HOME
- Two Bedrooms
- 2 x Parking Spaces
- Enclosed Rear Garden
- EPC Rating: TBA / Council Tax Band: A/Freehold

Thorn Street Mews, Woodville, DE11

Directions

SAT NAV Users: Postcode DE11 7DS.

IMPORTANT NOTE

Mortgage Advice available.

Living Room

13'2" x 11'7" (4.01m x 3.53m)

Kitchen / Diner

9'1" x 11'7" (2.77m x 3.53m)

Stairs & Landing

5'10" x 5'8" (1.78m x 1.73m)

Measurements shown are a maximum.

Bedroom 1

9'11" x 11'8" (3.02m x 3.56m)

Bedroom 2

9'3" x 5'9" (2.82m x 1.75m)

Shower Room

6'3" x 5'10" (1.91m x 1.78m)

To the Front

Forecourt area laid to lawn, brick-built raised bed with miscellaneous planting, allocated parking spaces x2, entry along side of property leading to rear, gated access to rear garden.

To the Rear

Enclosed rear garden, paved patio / seating area, wooden storage shed, gated access to entry leading to front of property.



Energy Efficiency Rating		Current	Potential
Very energy efficient - lower running costs			
(92-100)	A		
(81-91)	B		
(69-80)	C		
(55-68)	D		
(39-54)	E		
(21-38)	F		
(1-20)	G		
Not energy efficient - higher running costs			
England, Scotland & Wales		EU Directive 2002/91/EC	



Ground Floor

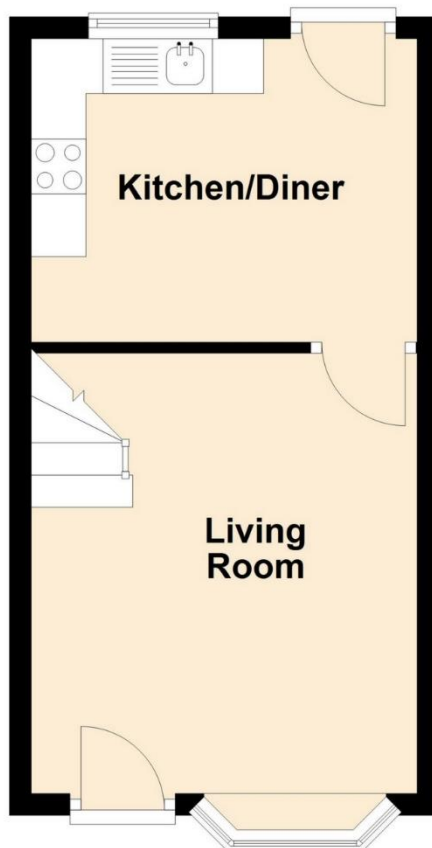

First Floor

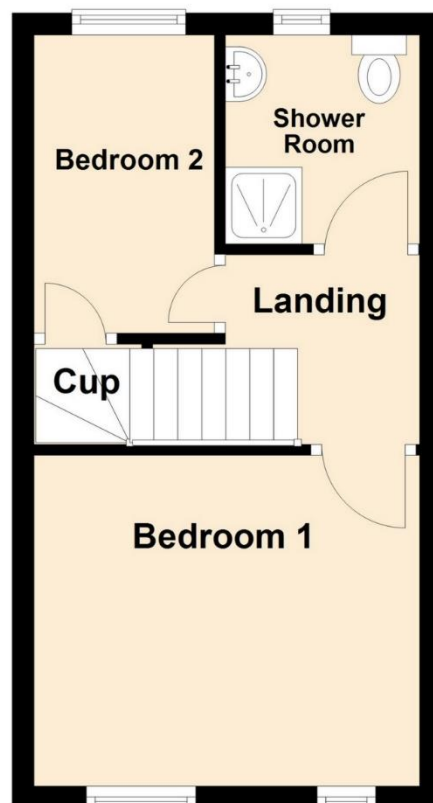

Viewing by appointment only with
Cadley Cauldwell, 19, High Street, Swadlincote, DE11 8JE

General: While we endeavour to make our sales particulars fair, accurate and reliable, they are only a general guide to the property and, accordingly, if there is any point which is of particular importance to you, please contact the office and we will be pleased to check the position for you, especially if you are contemplating travelling some distance to view the property. Measurements: These approximate room sizes are only intended as general guidance. You must verify the dimensions carefully before ordering carpets or any built-in furniture. Services: Please note we have not tested the services or any of the equipment or appliances in this property, accordingly we strongly advise prospective buyers to commission their own survey or service reports before finalizing their offer to purchase. THESE PARTICULARS ARE ISSUED IN GOOD FAITH BUT DO NOT CONSTITUTE REPRESENTATIONS OF FACT OR FORM PART OF ANY OFFER OR CONTRACT. THE MATTERS REFERRED TO IN THESE PARTICULARS SHOULD BE INDEPENDENTLY VERIFIED BY PROSPECTIVE BUYERS OR TENANTS. NEITHER CADLEY CAULDWELL NOR ANY OF ITS EMPLOYEES OR AGENTS HAS ANY AUTHORITY TO MAKE OR GIVE ANY REPRESENTATION OR WARRANTY WHATSOEVER IN RELATION TO THIS PROPERTY.