



## Joan Crescent, Mottingham, SE9

£550,000 **Freehold**

- **DOUBLE FRONTED END OF TERRACE HOUSE**
- **VERY WELL SIZED REAR GARDEN**
- **TWO BATHROOMS AND AN ADDITIONAL W/C**
- **GENEROUSLY SIZED KITCHEN / BREAKFAST ROOM**
- **DRIVEWAY PARKING**
- **WELL PRESENTED THROUGHOUT**
- **NEUTRALLY DECORATED THROUGHOUT**
- **FULLY DOUBLE GLAZED THROUGHOUT**

Offered to the sales market is this **DOUBLE FRONTED**, end of terrace **FAMILY HOME** boasting **FOUR BEDROOMS**, a **BRILLIANTLY SIZED REAR GARDEN**, **DRIVEWAY PARKING** for two - three cars and short commute to **MOTTINGHAM RAIL** station. Enquire today for your earliest viewing.

# Joan Crescent, Mottingham, SE9

---



# Joan Crescent, Mottingham, SE9

---





Joan Crescent SE9  
Total Area: 118.7 m2 ... 1278 ft2

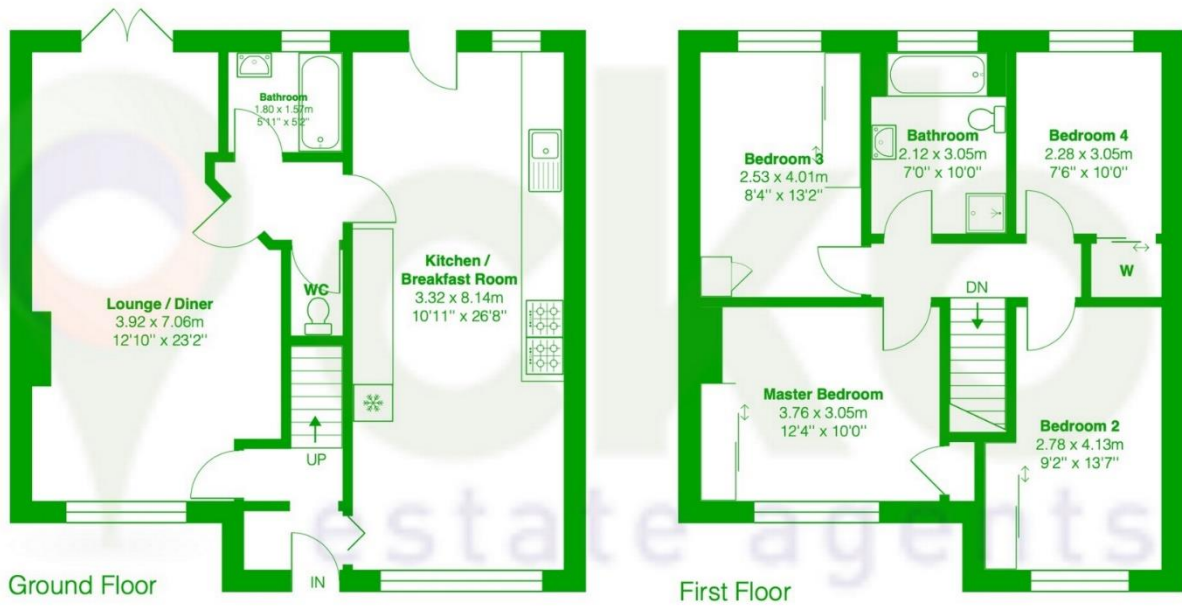

This plan is for layout guidance only. Not drawn to scale unless stated. Windows and door openings are approximate. Whilst every care is taken in the preparation of this plan. Please check all dimensions, shapes and compass bearings before making any decisions reliant upon them.