



£300,000

Levett House, Denman Avenue, Southall, UB2



- 540 Sq Ft
- One Bedroom
- Lift & Entry Phone
- 994 Yr Lease
- High Specification
- Chain Free

A newly built, 994 yr lease, 540 sq ft, one bedroom, luxury apartment in St Bernards Gate. Offering a high specification of fittings and an abundance of natural light throughout, the accommodation comprises wide entrance hallway, spacious open plan kitchen / lounge with Bosh integrated appliances, south facing bedroom with built in wardrobes and luxury bathroom. Added benefits include secure entry phone system, lift, storage, cycle lockers, over 8 years remain on the building warranty, landscaped communal areas with seating and offered with no onward chain. St Bernards Gate is a short stroll to Hanwell station (Crossrail) and convenient for bus routes, road networks and parks.



Levett House, Denman Avenue, Southall, Middlesex UB2 4FU

Approx. Gross Internal Area 576 sq ft - 53.51 sq m

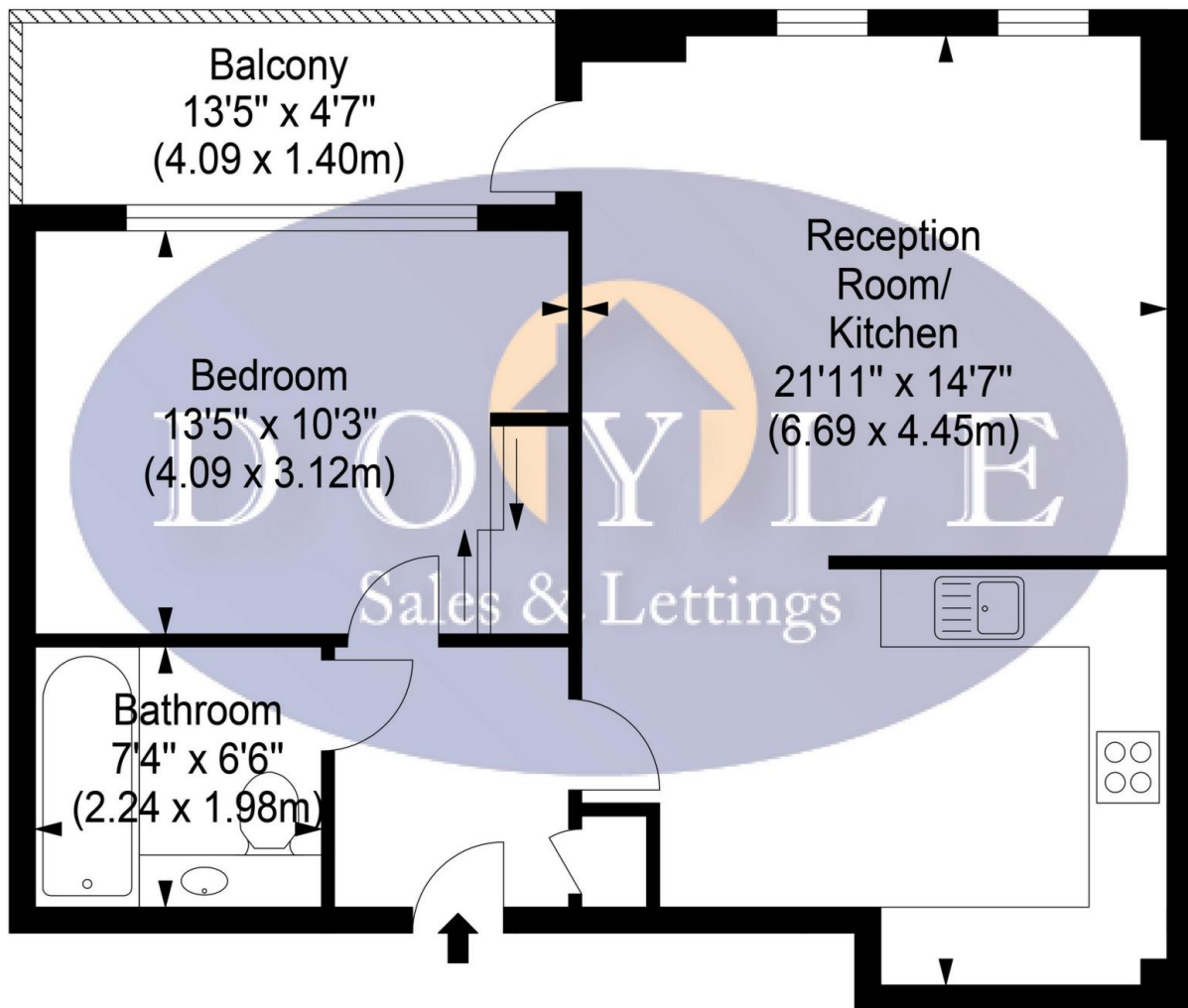
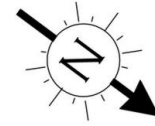

Second Floor

Ref

Copyright THEBLÉUPLAN

Disclaimer : Floor plan measurements are approximate and are for illustrative purposes only
While we do not doubt the floor plan accuracy and completeness, you or your advisors should
conduct a careful, independent investigation of the property in respect of monetary valuation

Map



VIEWING BY APPOINTMENT WITH AGENTS DOYLE SALES & LETTINGS

11 Broadway Buildings, Boston Rd, Hanwell, London, W7 3TT T: 020 8840 0171 E: info@doylesalesandlettings.co.uk W: www.doylesalesandlettings.co.uk

General: While we endeavour to make our sales particulars fair, accurate and reliable, they are only a general guide to the property and, accordingly, if there is any point which is of particular importance to you, please contact the office and we will be pleased to check the position for you, especially if you are contemplating travelling some distance to view the property.

Measurements: These approximate room sizes are only intended as general guidance. You must verify the dimensions carefully before ordering carpets or any built-in furniture.

Services: Please note we have not tested the services or any of the equipment or appliances in this property, accordingly we strongly advise prospective buyers to commission their own survey or service reports before finalizing their offer to purchase.

THESE PARTICULARS ARE ISSUED IN GOOD FAITH BUT DO NOT CONSTITUTE REPRESENTATIONS OF FACT OR FORM PART OF ANY OFFER OR CONTRACT. THE MATTERS REFERRED TO IN THESE PARTICULARS SHOULD BE INDEPENDENTLY VERIFIED BY PROSPECTIVE BUYERS OR TENANTS. NEITHER DOYLE SALES & LETTINGS NOR ANY OF ITS EMPLOYEES OR AGENTS HAS ANY AUTHORITY TO MAKE OR GIVE ANY REPRESENTATION OR WARRANTY WHATEVER IN RELATION TO THIS PROPERTY.

YOUR HOME IS AT RISK IF YOU DO NOT KEEP UP REPAYMENTS ON A MORTGAGE OR OTHER LOAN SECURED ON IT.

Written quotations available on request. All loans secured on property. Life assurance is usually required.

EPC Graph

