



£1,450,000

Manor Court Road, Hanwell, W7



- 5 Double Bedrooms
- Detached
- Off Street Parking
- South Facing Garden
- Over 2,700 Sq Ft
- Chain Free

A substantial 5 double bedroom detached residence on one of Hanwells premier roads, Manor Court Road. Accommodation on the ground floor comprises storm porch, wide entrance hallway, reception room, guest WC, garage converted to playroom, utility room, second reception and large 22' x 26' kitchen / dining room. The first floor offers 4 double bedrooms, with one en suite and spacious family bathroom. The loft conversion hosts the master bedroom with walk in wardrobe and en suite bathroom. Benefits includes high specification finish, generous proportioned rooms, attractive period features including parquet floors and cornicing, underfloor heating in areas, air conditioning and chain free. Manor Court Road is perfect for Hanwell station (Crossrail), various bus routes to Ealing, Northfields and Chiswick, road networks parks and excellent school catchment.





Manor Court Road W7 3EL

Approx. Gross Internal Area = 251.7 sq m / 2709 sq ft

Outbuilding = 13.5 sq m / 145 sq ft

Total = 265.2 sq m / 2854 sq ft

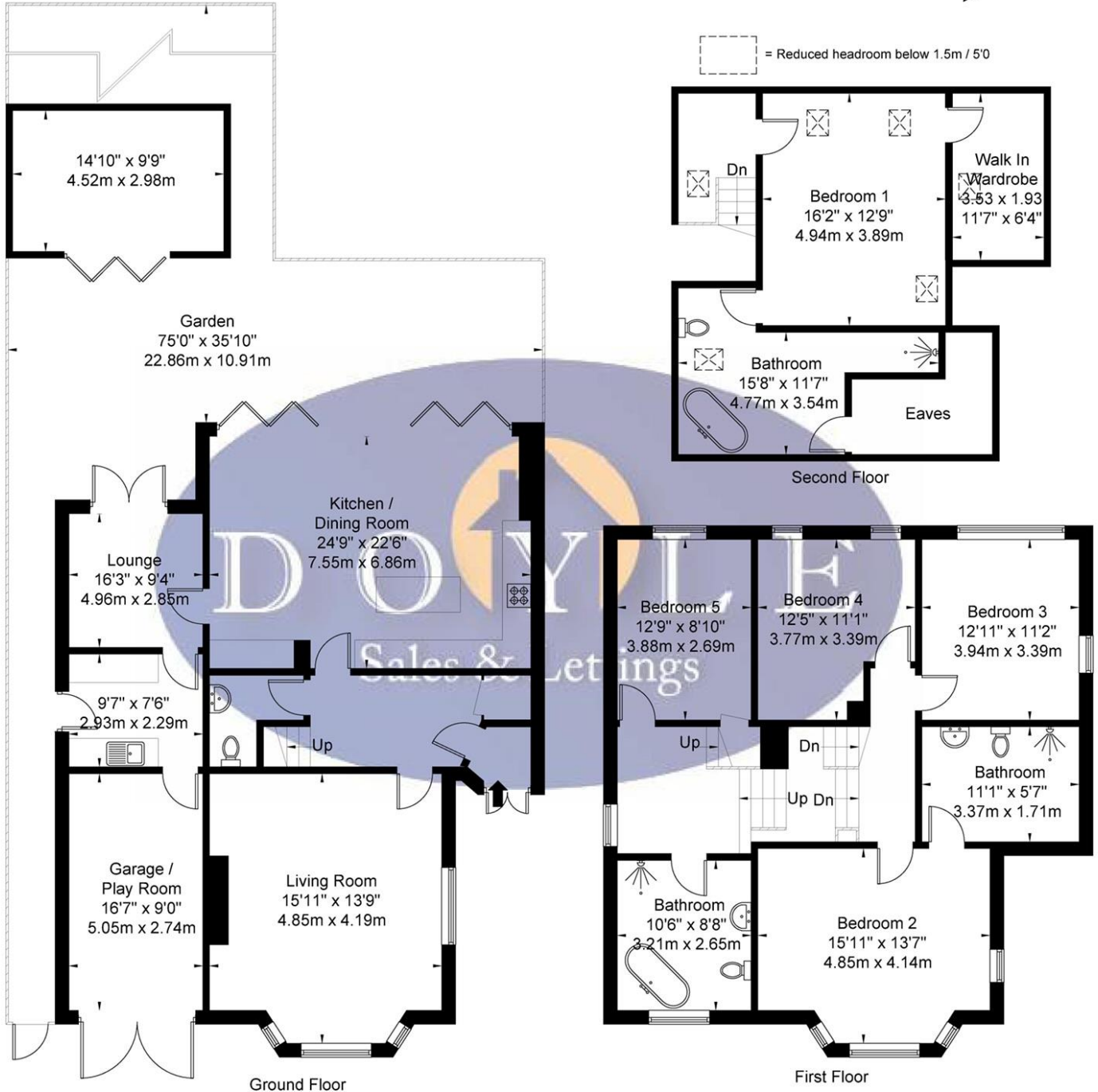
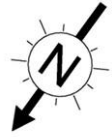

Ref

Copyright THEBLÉUPLAN

Disclaimer : Floor plan measurements are approximate and are for illustrative purposes only. While we do not doubt the floor plan accuracy and completeness, you or your advisors should conduct a careful, independent investigation of the property in respect of monetary valuation.

Map



VIEWING BY APPOINTMENT WITH AGENTS DOYLE SALES & LETTINGS

11 Broadway Buildings, Boston Rd, Hanwell, London, W7 3TT T: 020 8840 0171 E: info@doylesalesandlettings.co.uk W: www.doylesalesandlettings.co.uk

General: While we endeavour to make our sales particulars fair, accurate and reliable, they are only a general guide to the property and, accordingly, if there is any point which is of particular importance to you, please contact the office and we will be pleased to check the position for you, especially if you are contemplating travelling some distance to view the property.

Measurements: These approximate room sizes are only intended as general guidance. You must verify the dimensions carefully before ordering carpets or any built-in furniture.

Services: Please note we have not tested the services or any of the equipment or appliances in this property, accordingly we strongly advise prospective buyers to commission their own survey or service reports before finalizing their offer to purchase.

THESE PARTICULARS ARE ISSUED IN GOOD FAITH BUT DO NOT CONSTITUTE REPRESENTATIONS OF FACT OR FORM PART OF ANY OFFER OR CONTRACT. THE MATTERS REFERRED TO IN THESE PARTICULARS SHOULD BE INDEPENDENTLY VERIFIED BY PROSPECTIVE BUYERS OR TENANTS. NEITHER DOYLE SALES & LETTINGS NOR ANY OF ITS EMPLOYEES OR AGENTS HAS ANY AUTHORITY TO MAKE OR GIVE ANY REPRESENTATION OR WARRANTY WHATEVER IN RELATION TO THIS PROPERTY.

YOUR HOME IS AT RISK IF YOU DO NOT KEEP UP REPAYMENTS ON A MORTGAGE OR OTHER LOAN SECURED ON IT.

Written quotations available on request. All loans secured on property. Life assurance is usually required.

EPC Rating C

