



£599,950

Jeymer Drive, Greenford, UB6



- 3 Double Bedrooms
- Over 1,400 Sq Ft
- Master En Suite
- Garage
- 94 Ft South Facing Garden
- Chain Free

An impressive, extended, 3 double bedroom, 2 bathroom, chain free family home with garage backing onto the playing fields. The accommodation comprises entrance hallway, spacious formal front lounge, second reception, extended kitchen/diner and guest WC. The first floor hosts 2 double bedrooms, spacious landing and family bathroom. The top of the house boasts a fantastic loft conversion with ample storage and en suite bathroom. Added benefits with this property include, garage, chain free, large south facing mature garden with patio area and rear access. Jeymer Drive is located close to Greenford Station (Central line and mainline rail), good bus routes, road networks, selection of schools and the shopping facilities that Greenford Broadway offers.



Jeymer Drive UB6 8NS

Approx. Gross Internal Area = 131.1 sq m / 1411 sq ft

Garage = 18.3 sq m / 196 sq ft

Total = 149.4 sq m / 1607 sq ft

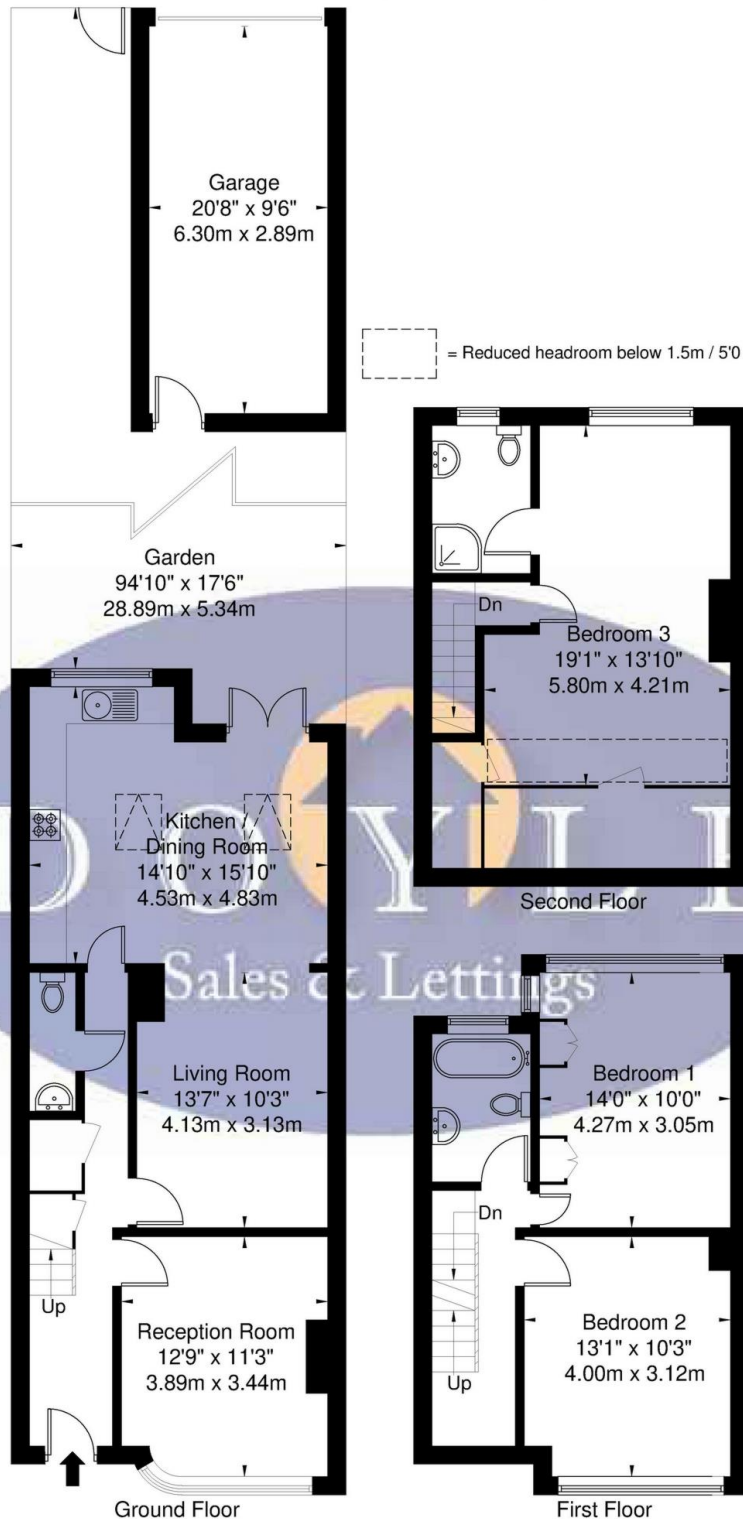

Ref

Copyright THEBLÉUPLAN

Disclaimer : Floor plan measurements are approximate and are for illustrative purposes only. While we do not doubt the floor plan accuracy and completeness, you or your advisors should conduct a careful, independent investigation of the property in respect of monetary valuation.

Map



VIEWING BY APPOINTMENT WITH AGENTS DOYLE SALES & LETTINGS

11 Broadway Buildings, Boston Rd, Hanwell, London, W7 3TT T: 020 8840 0171 E: info@doylesalesandlettings.co.uk W: www.doylesalesandlettings.co.uk

General: While we endeavour to make our sales particulars fair, accurate and reliable, they are only a general guide to the property and, accordingly, if there is any point which is of particular importance to you, please contact the office and we will be pleased to check the position for you, especially if you are contemplating travelling some distance to view the property.

Measurements: These approximate room sizes are only intended as general guidance. You must verify the dimensions carefully before ordering carpets or any built-in furniture.

Services: Please note we have not tested the services or any of the equipment or appliances in this property, accordingly we strongly advise prospective buyers to commission their own survey or service reports before finalizing their offer to purchase.

THESE PARTICULARS ARE ISSUED IN GOOD FAITH BUT DO NOT CONSTITUTE REPRESENTATIONS OF FACT OR FORM PART OF ANY OFFER OR CONTRACT. THE MATTERS REFERRED TO IN THESE PARTICULARS SHOULD BE INDEPENDENTLY VERIFIED BY PROSPECTIVE BUYERS OR TENANTS. NEITHER DOYLE SALES & LETTINGS NOR ANY OF ITS EMPLOYEES OR AGENTS HAS ANY AUTHORITY TO MAKE OR GIVE ANY REPRESENTATION OR WARRANTY WHATEVER IN RELATION TO THIS PROPERTY.

YOUR HOME IS AT RISK IF YOU DO NOT KEEP UP REPAYMENTS ON A MORTGAGE OR OTHER LOAN SECURED ON IT.

Written quotations available on request. All loans secured on property. Life assurance is usually required.

EPC Rating D

