



£599,950

Blackmore Avenue, Southall, UB1



- 3 Bedrooms
- Off Street Parking
- Hanwell Borders
- 8 Minute Walk To Crossrail
- Opportunity To Extend
- Chain Free

A lovely, chain free, 3 bedroom family home, with off street parking situated in a peaceful cul de sac location on Hanwell borders. The well maintained accommodation comprises entrance hallway, bay fronted reception, kitchen / breakfast Room with doors out to the rear garden. The first floor offers 3 bedrooms and family bathroom. The property benefits from valuable off street parking, chain free, delightful easy to maintain rear garden and an opportunity to extend both the loft space and ground floor STPP. Blackmore Avenue is ideally located only an 8 minute walk to Hanwell Station (Elizabeth Line), in an excellent school catchment and close to Ealing Hospital, road networks, bus routes, canal, parks and Hanwell Broadway. Council tax band D.



Blackmore Avenue, UB1 3ES

Approximate Gross Internal Area
79.39 sq m / 855 sq ft

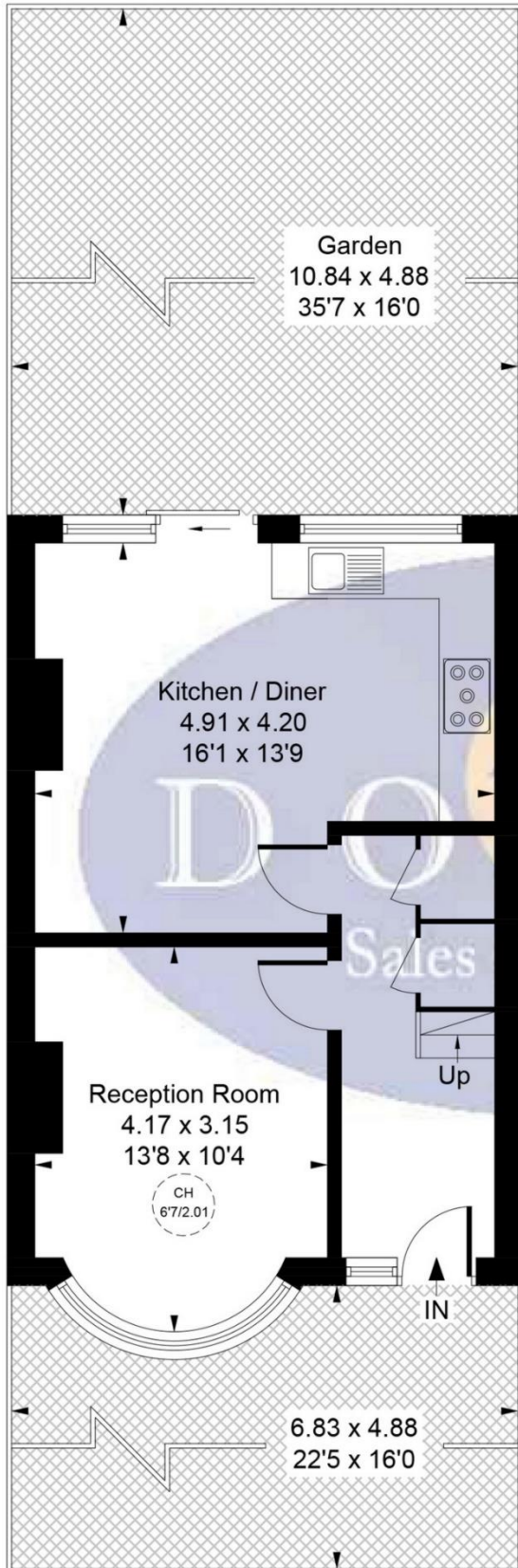

Ground Floor
39.89 sq m / 430 sq ft

CH = Ceiling Height

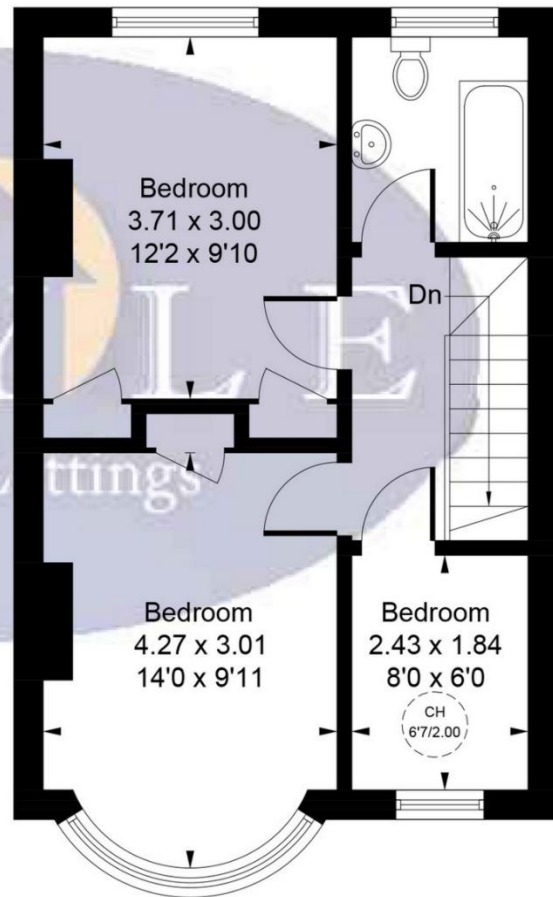

First Floor
39.50 sq m / 425 sq ft

Whilst every attempt has been made to ensure the accuracy of the floor plan contained here, measurements of doors, windows, rooms and any other items are approximate and no responsibility is taken for any error, omission, or mis-statement. This plan is for illustrative purposes only and should be used as such by any prospective purchaser.

Map



VIEWING BY APPOINTMENT WITH AGENTS DOYLE SALES & LETTINGS

11 Broadway Buildings, Boston Rd, Hanwell, London, W7 3TT T: 020 8840 0171 E: info@doylesalesandlettings.co.uk W: www.doylesalesandlettings.co.uk

General: While we endeavour to make our sales particulars fair, accurate and reliable, they are only a general guide to the property and, accordingly, if there is any point which is of particular importance to you, please contact the office and we will be pleased to check the position for you, especially if you are contemplating travelling some distance to view the property.

Measurements: These approximate room sizes are only intended as general guidance. You must verify the dimensions carefully before ordering carpets or any built-in furniture.

Services: Please note we have not tested the services or any of the equipment or appliances in this property, accordingly we strongly advise prospective buyers to commission their own survey or service reports before finalizing their offer to purchase.

THESE PARTICULARS ARE ISSUED IN GOOD FAITH BUT DO NOT CONSTITUTE REPRESENTATIONS OF FACT OR FORM PART OF ANY OFFER OR CONTRACT. THE MATTERS REFERRED TO IN THESE PARTICULARS SHOULD BE INDEPENDENTLY VERIFIED BY PROSPECTIVE BUYERS OR TENANTS. NEITHER DOYLE SALES & LETTINGS NOR ANY OF ITS EMPLOYEES OR AGENTS HAS ANY AUTHORITY TO MAKE OR GIVE ANY REPRESENTATION OR WARRANTY WHATEVER IN RELATION TO THIS PROPERTY.

YOUR HOME IS AT RISK IF YOU DO NOT KEEP UP REPAYMENTS ON A MORTGAGE OR OTHER LOAN SECURED ON IT.

Written quotations available on request. All loans secured on property. Life assurance is usually required.

EPC Rating C

