



£699,950

St Margarets Road, Hanwell, W7



- 2 Double Bedrooms
- End Of Terrace
- Almost 70 Ft Garden
- Popular Olde Hanwell
- Extended Kitchen
- Chain Free

An attractive and well presented, chain free, 2 double bedroom, end of terrace, Victorian family home, with large rear garden located in the very popular area of Olde Hanwell. The accommodation comprises entrance hallway, bay fronted reception room, dining room, guest WC and extended kitchen/breakfast room. The first floor hosts 2 double bedrooms, family bathroom and loft space with scope for converting STPP. There are front and rear gardens, the latter almost 70 ft with shed and 2 patio areas. St Margarets Road is close to the Grand Union Canal and the popular Fox public house, the property falls into great school catchment area and located within easy access to Hanwell (Elizabeth line) and Boston Manor (Piccadilly line) stations, bus routes, road networks, parks and shops.



St. Margarets Road, W7 2PP

Approximate Gross Internal Area
75.30 sq m / 810 sq ft

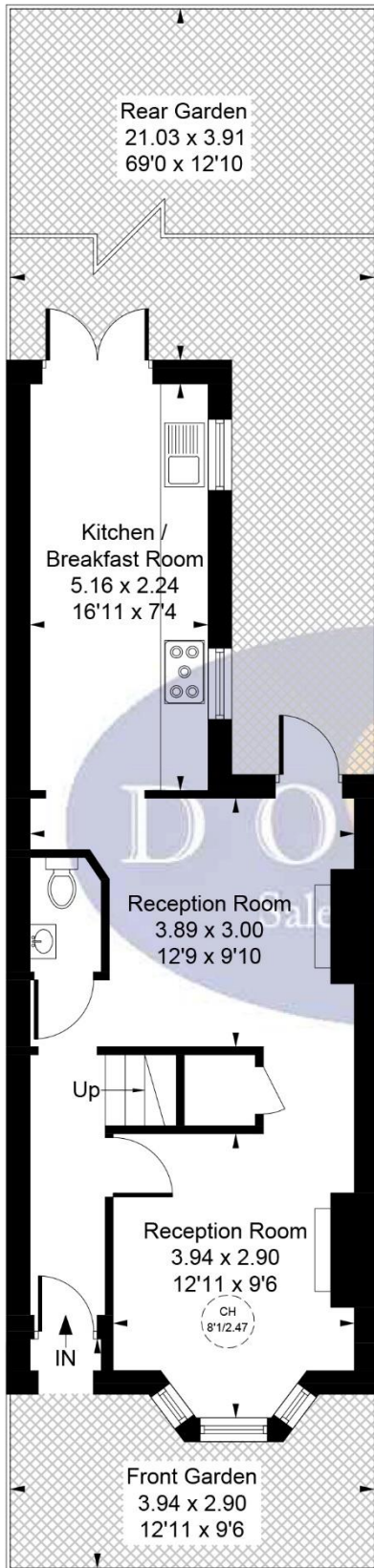

Ground Floor
40.25 sq m / 433 sq ft



CH = Ceiling Height



First Floor
35.05 sq m / 377 sq ft

Whilst every attempt has been made to ensure the accuracy of the floor plan contained here, measurements of doors, windows, rooms and any other items are approximate and no responsibility is taken for any error, omission, or mis-statement. This plan is for illustrative purposes only and should be used as such by any prospective purchaser.

© Vizion Property Marketing Produced for Doyle Sales & Lettings

Map



VIEWING BY APPOINTMENT WITH AGENTS DOYLE SALES & LETTINGS

11 Broadway Buildings, Boston Rd, Hanwell, London, W7 3TT T: 020 8840 0171 E: info@doylesalesandlettings.co.uk W: www.doylesalesandlettings.co.uk

General: While we endeavour to make our sales particulars fair, accurate and reliable, they are only a general guide to the property and, accordingly, if there is any point which is of particular importance to you, please contact the office and we will be pleased to check the position for you, especially if you are contemplating travelling some distance to view the property.

Measurements: These approximate room sizes are only intended as general guidance. You must verify the dimensions carefully before ordering carpets or any built-in furniture.

Services: Please note we have not tested the services or any of the equipment or appliances in this property, accordingly we strongly advise prospective buyers to commission their own survey or service reports before finalizing their offer to purchase.

THESE PARTICULARS ARE ISSUED IN GOOD FAITH BUT DO NOT CONSTITUTE REPRESENTATIONS OF FACT OR FORM PART OF ANY OFFER OR CONTRACT. THE MATTERS REFERRED TO IN THESE PARTICULARS SHOULD BE INDEPENDENTLY VERIFIED BY PROSPECTIVE BUYERS OR TENANTS. NEITHER DOYLE SALES & LETTINGS NOR ANY OF ITS EMPLOYEES OR AGENTS HAS ANY AUTHORITY TO MAKE OR GIVE ANY REPRESENTATION OR WARRANTY WHATEVER IN RELATION TO THIS PROPERTY.

YOUR HOME IS AT RISK IF YOU DO NOT KEEP UP REPAYMENTS ON A MORTGAGE OR OTHER LOAN SECURED ON IT.

Written quotations available on request. All loans secured on property. Life assurance is usually required.

EPC Rating E

