



**£899,950**

**Osterley Park View Road, Hanwell, W7**



- Four Double Bedroom
- Over 1,300 Sq Ft
- 2 Reception Areas
- Semi-Detached / Side Access
- Private South Facing Garden
- Chain Free

A stunning, chain free, four double bedroom, semi detached house, with 2 bathrooms situated on this popular road in Olde Hanwell. The property comprises reception with wood flooring, dining area and separate kitchen with access to the garden. Upstairs boasts four double bedrooms, three with fitted wardrobes, one family bathroom with bath & separate shower cubicle, modern shower room and guest WC. The property further benefits from side access, front garden and private lawned and decked rear garden. Osterley Park View Road is ideally located for excellent schools, within close proximity to local parks, Boston Manor Tube Station, Hanwell Mainline Station, (Elizabeth Line) bus routes, road networks and also benefiting from great local restaurants, cafes and shopping facilities.





# Osterley Park View Road W7 2HG

Approx. Gross Internal Area = 1301 sq ft / 120.9 sq m.  
(Excluding Sheds & Eaves)

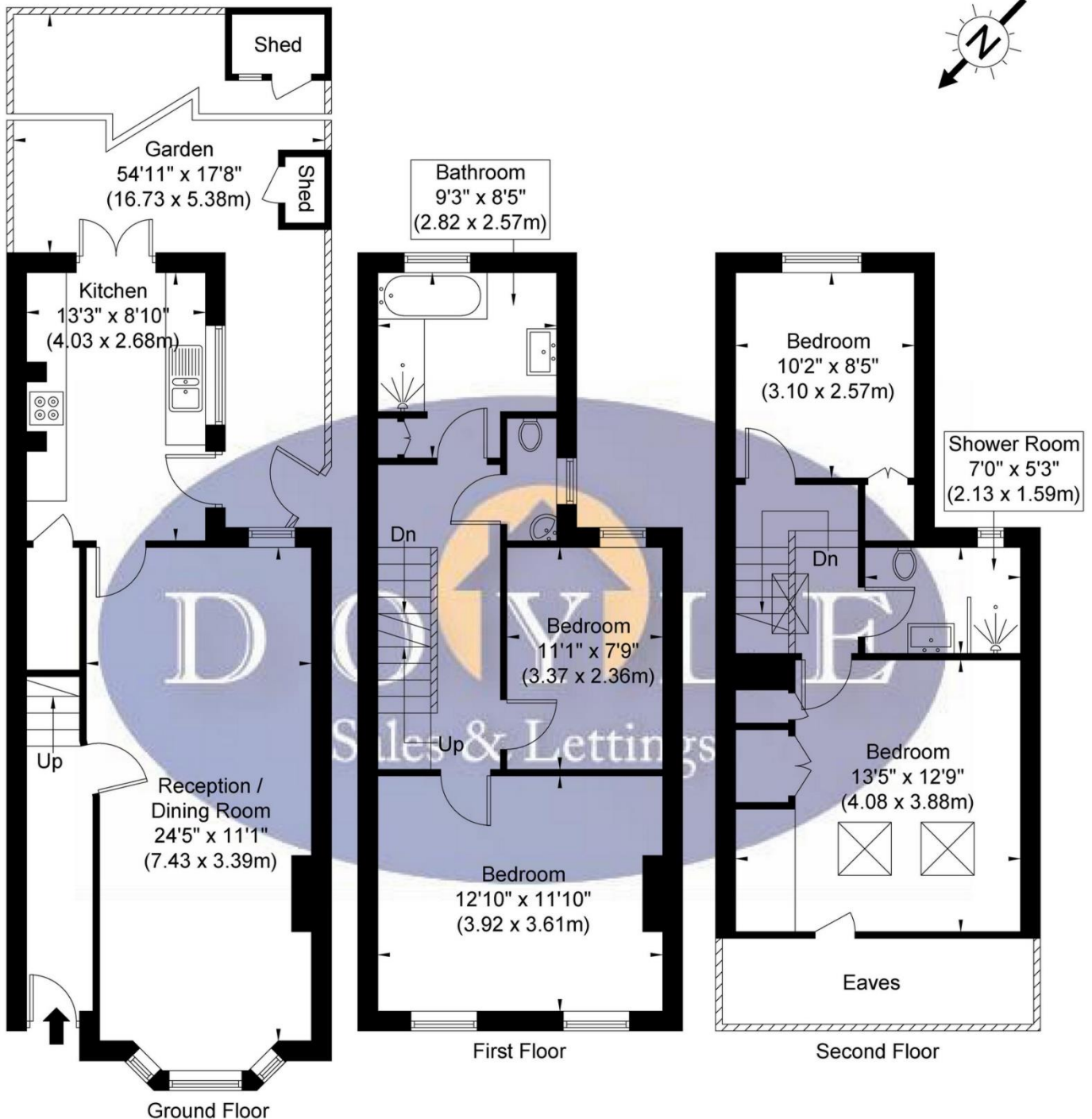

Ref

Copyright THEBLÉUPLAN

Disclaimer : Floor plan measurements are approximate and are for illustrative purposes only  
While we do not doubt the floor plan accuracy and completeness, you or your advisors should  
conduct a careful, independent investigation of the property in respect of monetary valuation



## Map



### VIEWING BY APPOINTMENT WITH AGENTS DOYLE SALES & LETTINGS

11 Broadway Buildings, Boston Rd, Hanwell, London, W7 3TT T: 020 8840 0171 E: [info@doylesalesandlettings.co.uk](mailto:info@doylesalesandlettings.co.uk) W: [www.doylesalesandlettings.co.uk](http://www.doylesalesandlettings.co.uk)

General: While we endeavour to make our sales particulars fair, accurate and reliable, they are only a general guide to the property and, accordingly, if there is any point which is of particular importance to you, please contact the office and we will be pleased to check the position for you, especially if you are contemplating travelling some distance to view the property.

Measurements: These approximate room sizes are only intended as general guidance. You must verify the dimensions carefully before ordering carpets or any built-in furniture.

Services: Please note we have not tested the services or any of the equipment or appliances in this property, accordingly we strongly advise prospective buyers to commission their own survey or service reports before finalizing their offer to purchase.

THESE PARTICULARS ARE ISSUED IN GOOD FAITH BUT DO NOT CONSTITUTE REPRESENTATIONS OF FACT OR FORM PART OF ANY OFFER OR CONTRACT. THE MATTERS REFERRED TO IN THESE PARTICULARS SHOULD BE INDEPENDENTLY VERIFIED BY PROSPECTIVE BUYERS OR TENANTS. NEITHER DOYLE SALES & LETTINGS NOR ANY OF ITS EMPLOYEES OR AGENTS HAS ANY AUTHORITY TO MAKE OR GIVE ANY REPRESENTATION OR WARRANTY WHATEVER IN RELATION TO THIS PROPERTY.

YOUR HOME IS AT RISK IF YOU DO NOT KEEP UP REPAYMENTS ON A MORTGAGE OR OTHER LOAN SECURED ON IT.

Written quotations available on request. All loans secured on property. Life assurance is usually required.

## EPC Rating D

