



£375,000

Havelock Road, Southall, UB2



- 2 Double Bedroom
- School Catchments
- Excellent Transport Links
- Wrap-Around Patio
- Purpose Built
- Chain Free

A stunning two-bedroom ground floor apartment, offering close to 800 sq ft of internal space and the added benefit of private and independent access. At the heart of the home is a bright open-plan living space combining lounge, dining and kitchen area with direct access to a private patio/terrace, creating a seamless indoor-outdoor feel. The property features two well-proportioned double bedrooms, with the principal bedroom benefiting from built-in storage and a modern en-suite shower room, and a separate family bathroom. A central hallway with additional storage enhances the overall sense of space and functionality. The location is particularly appealing, with everyday convenience and green space close by, Three Bridges Primary School is within easy reach and a neighbourhood playgrounds makes it a strong choice for families. The nearby Grand Union Canal offers scenic walks and cycling routes, while local shops and amenities are just moments away. A bus stop is conveniently located right outside the building. Well-positioned on Havelock Road, the property also benefits from easy access to Southall Station and the Elizabeth Line, providing fast connections into Central London.

Lease 243 years

Service Charge approx. £ 135 p/m

Ground Rent £25 p/m



Rudderstock House, UB2 4GG

Approximate Gross Internal Area
73.54 sq m / 792 sq ft

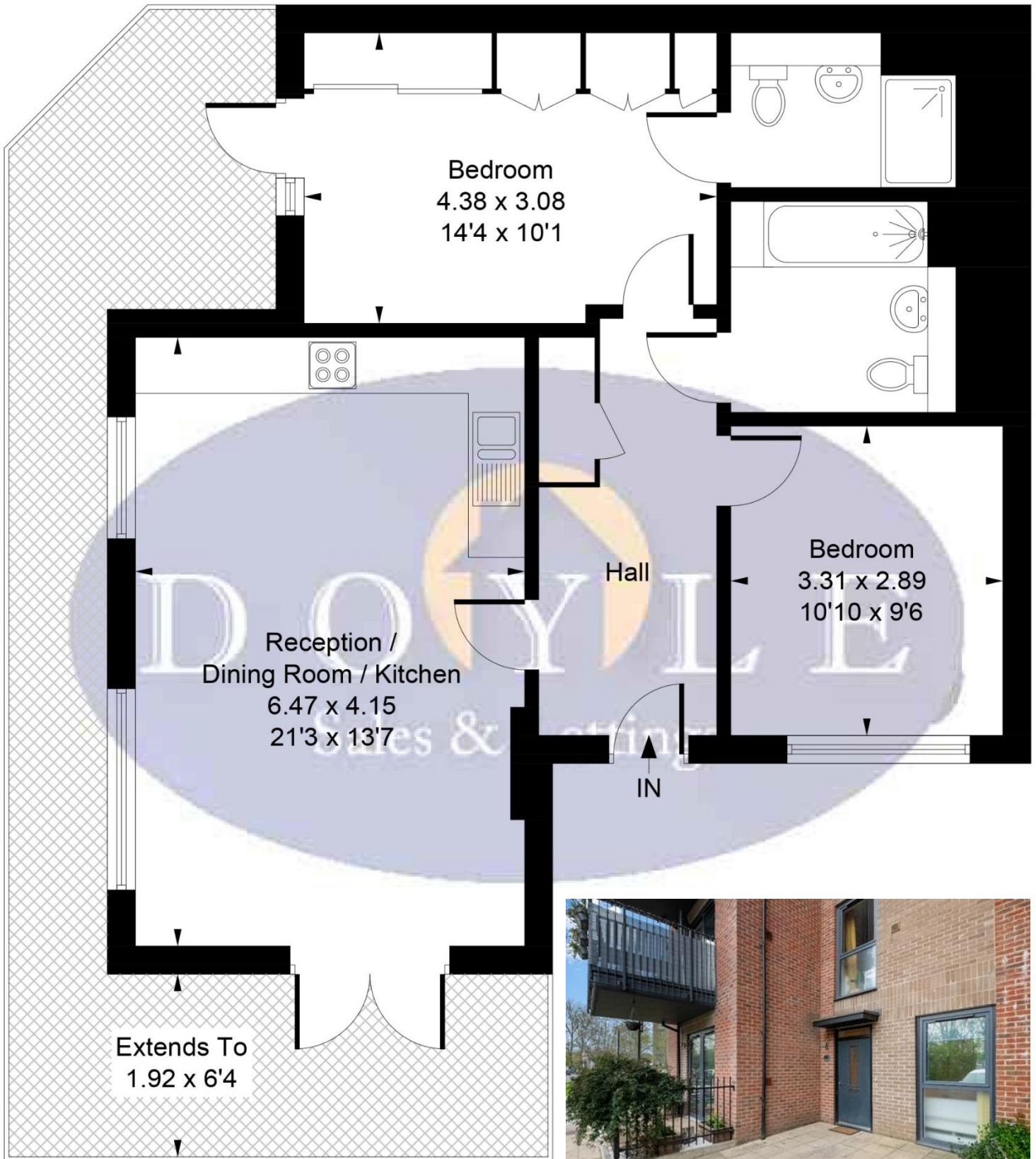

Ground Floor
73.54 sq m / 792 sq ft



Whilst every attempt has been made to ensure the accuracy of the floor plan contained here, measurements of doors, windows, rooms and any other items are approximate and no responsibility is taken for any error, omission, or mis-statement. This plan is for illustrative purposes only and should be used as such by any prospective purchaser.

© Vizion Property Marketing Produced for Doyle Sales & Lettings

MAP



VIEWING BY APPOINTMENT WITH AGENTS DOYLE SALES & LETTINGS

11 Broadway Buildings, Boston Rd, Hanwell, London, W7 3TT T: 020 8840 0171 E: info@doylesalesandlettings.co.uk W: www.doylesalesandlettings.co.uk

General: While we endeavour to make our sales particulars fair, accurate and reliable, they are only a general guide to the property and, accordingly, if there is any point which is of particular importance to you, please contact the office and we will be pleased to check the position for you, especially if you are contemplating travelling some distance to view the property.

Measurements: These approximate room sizes are only intended as general guidance. You must verify the dimensions carefully before ordering carpets or any built-in furniture.

Services: Please note we have not tested the services or any of the equipment or appliances in this property, accordingly we strongly advise prospective buyers to commission their own survey or service reports before finalizing their offer to purchase.

THESE PARTICULARS ARE ISSUED IN GOOD FAITH BUT DO NOT CONSTITUTE REPRESENTATIONS OF FACT OR FORM PART OF ANY OFFER OR CONTRACT. THE MATTERS REFERRED TO IN THESE PARTICULARS SHOULD BE INDEPENDENTLY VERIFIED BY PROSPECTIVE BUYERS OR TENANTS. NEITHER DOYLE SALES & LETTINGS NOR ANY OF ITS EMPLOYEES OR AGENTS HAS ANY AUTHORITY TO MAKE OR GIVE ANY REPRESENTATION OR WARRANTY WHATEVER IN RELATION TO THIS PROPERTY.

YOUR HOME IS AT RISK IF YOU DO NOT KEEP UP REPAYMENTS ON A MORTGAGE OR OTHER LOAN SECURED ON IT.

Written quotations available on request. All loans secured on property. Life assurance is usually required.

EPC Rating B

