



£375,000

Osterley Views, West Park Road, Southall, UB2



- 3 Double Bedrooms
- Off Street Parking
- 859 Sq Ft
- Stunning Period Property
- Close To Elizabeth Line
- Chain Free

A spacious, chain-free, 3 double bedroom first floor apartment offering approximately 859 sq ft of well-proportioned accommodation within a prestigious Grade II listed private gated development. This exceptionally bright property comprises a welcoming entrance hall, generous living and dining room, separate fitted kitchen, principal bedroom with en-suite bathroom and built-in wardrobes, two further double bedrooms, and a family bathroom. Further benefits include off-street parking, long lease, video entry system, ample storage, communal gardens, and a peaceful secure gated setting. Ideally located close to Hanwell Station (Elizabeth Line), excellent schools, local shops, parks, canal walks, and convenient road and bus links.



Osterley Views, West Park Road, Southall, UB2 4AF

Approximate Gross Internal Area
79.83 sq m / 859 sq ft

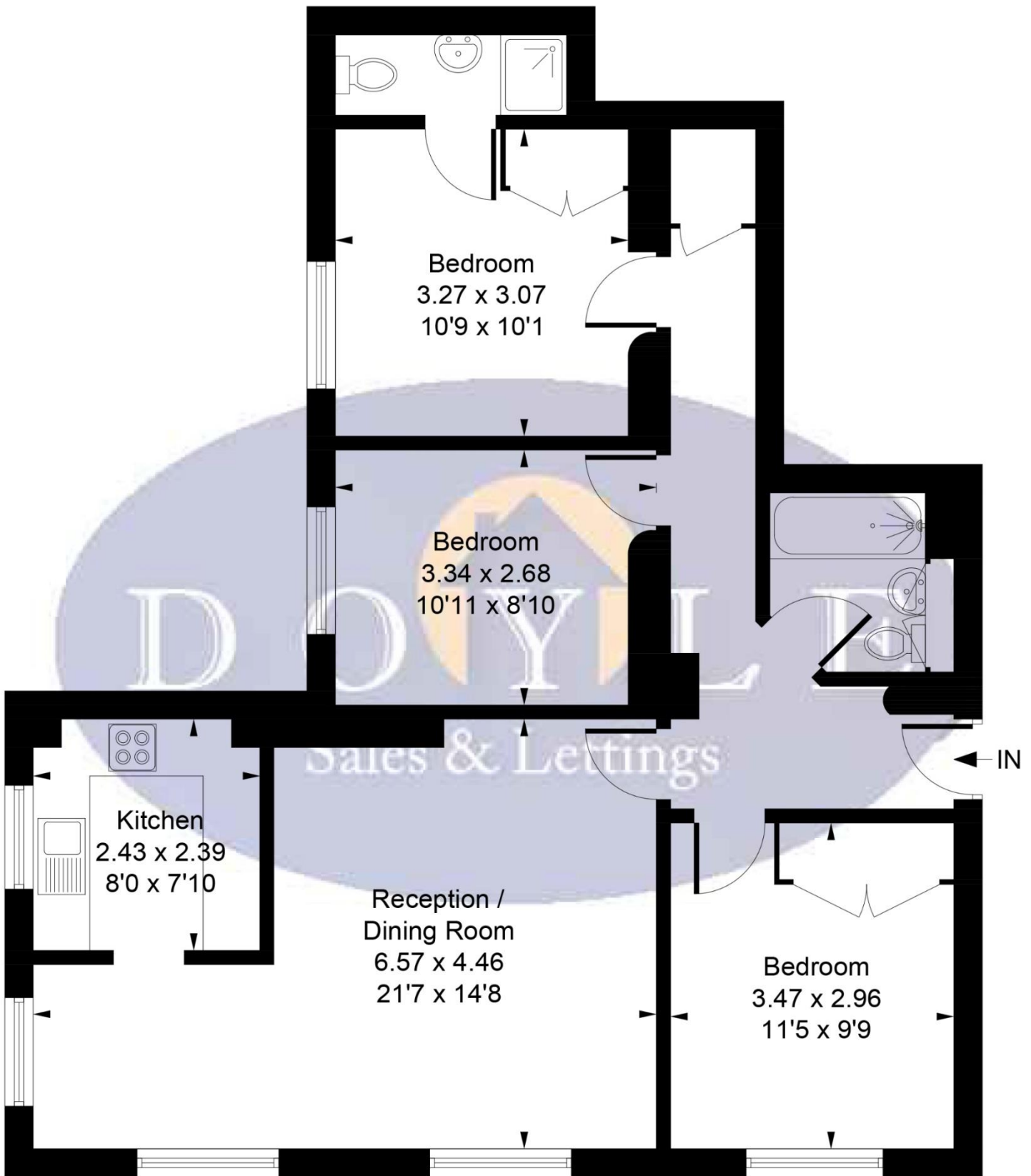

First Floor

79.83 sq m / 859 sq ft

Whilst every attempt has been made to ensure the accuracy of the floor plan contained here, measurements of doors, windows, rooms and any other items are approximate and no responsibility is taken for any error, omission, or mis-statement.

This plan is for illustrative purposes only and should be used as such by any prospective purchaser.

© Vizion Property Marketing Produced for Doyle Sales & Lettings

Map



VIEWING BY APPOINTMENT WITH AGENTS DOYLE SALES & LETTINGS

11 Broadway Buildings, Boston Rd, Hanwell, London, W7 3TT T: 020 8840 0171 E: info@doylesalesandlettings.co.uk W: www.doylesalesandlettings.co.uk

General: While we endeavour to make our sales particulars fair, accurate and reliable, they are only a general guide to the property and, accordingly, if there is any point which is of particular importance to you, please contact the office and we will be pleased to check the position for you, especially if you are contemplating travelling some distance to view the property.

Measurements: These approximate room sizes are only intended as general guidance. You must verify the dimensions carefully before ordering carpets or any built-in furniture.

Services: Please note we have not tested the services or any of the equipment or appliances in this property, accordingly we strongly advise prospective buyers to commission their own survey or service reports before finalizing their offer to purchase.

THESE PARTICULARS ARE ISSUED IN GOOD FAITH BUT DO NOT CONSTITUTE REPRESENTATIONS OF FACT OR FORM PART OF ANY OFFER OR CONTRACT. THE MATTERS REFERRED TO IN THESE PARTICULARS SHOULD BE INDEPENDENTLY VERIFIED BY PROSPECTIVE BUYERS OR TENANTS. NEITHER DOYLE SALES & LETTINGS NOR ANY OF ITS EMPLOYEES OR AGENTS HAS ANY AUTHORITY TO MAKE OR GIVE ANY REPRESENTATION OR WARRANTY WHATEVER IN RELATION TO THIS PROPERTY.

YOUR HOME IS AT RISK IF YOU DO NOT KEEP UP REPAYMENTS ON A MORTGAGE OR OTHER LOAN SECURED ON IT.

Written quotations available on request. All loans secured on property. Life assurance is usually required.

EPC Rating C

