



£925,000

Grove Avenue, Hanwell, W7



- 4/5 Bedrooms
- End Of Terrace
- Off Street Parking (2 Cars)
- Side Access & Large Garden
- 1,428 Sq Ft
- Chain Free

Located on one of Hanwell's most desirable roads, this well presented, end-of-terrace townhouse is offered chain-free and features flexible 4/5 bedroom accommodation. Arranged over three floors, the ground floor comprises an entrance hall, a large kitchen/dining room with double doors leading to a landscaped rear garden and a useful office/study or 5th bedroom with a guest WC. The first floor boasts a bright lounge with lovely views and a master bedroom with an en-suite. The top floor offers a further double bedroom, 2 single bedrooms and a contemporary family bathroom. A standout feature is the off-street parking for two cars, spacious side access and ample storage throughout. Grove Avenue is a sought-after location for families, falling within the catchment of fantastic schools and near green spaces like Brent Valley Golf Course and the Bunny Park. Hanwell station (Elizabeth Line), local shops, and bus links to Ealing Broadway are all within easy walking distance. *Photos of furniture are CGI



Grove Avenue, Hanwell

Approximate Gross Internal Area

132.64 sq m / 1428 sq ft

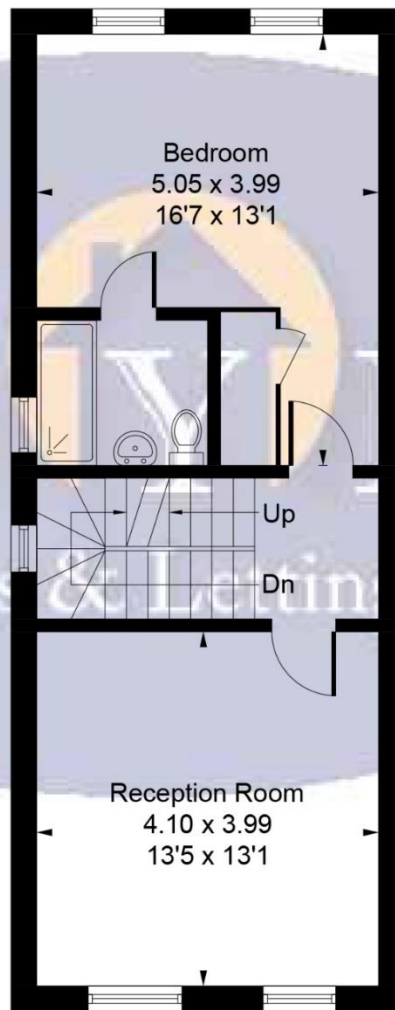
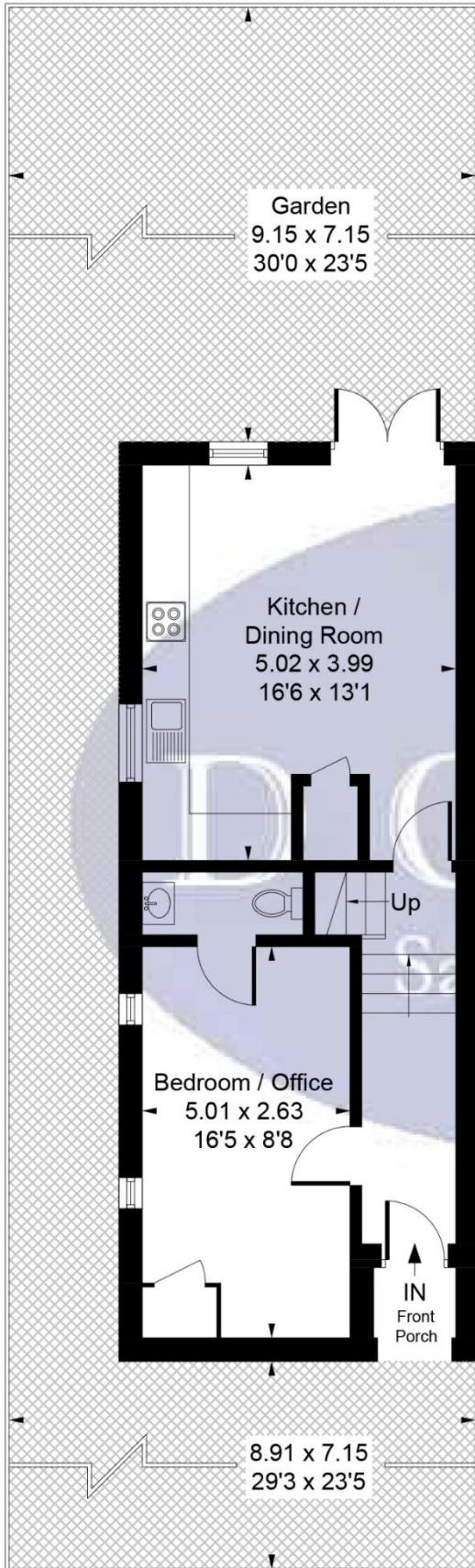

First Floor
44.60 sq m / 480 sq ft

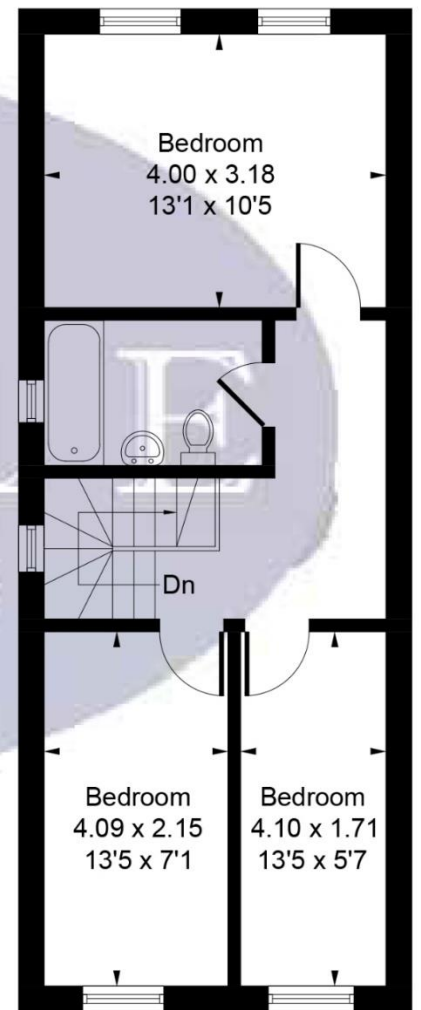

Second Floor
44.60 sq m / 480 sq ft

Ground Floor
43.44 sq m / 468 sq ft

Whilst every attempt has been made to ensure the accuracy of the floor plan contained here, measurements of doors, windows, rooms and any other items are approximate and no responsibility is taken for any error, omission, or mis-statement.

This plan is for illustrative purposes only and should be used as such by any prospective purchaser.

© Vizion Property Marketing Produced for Doyle Sales & Lettings

Map



VIEWING BY APPOINTMENT WITH AGENTS DOYLE SALES & LETTINGS

11 Broadway Buildings, Boston Rd, Hanwell, London, W7 3TT T: 020 8840 0171 E: info@doylesalesandlettings.co.uk W: www.doylesalesandlettings.co.uk

General: While we endeavour to make our sales particulars fair, accurate and reliable, they are only a general guide to the property and, accordingly, if there is any point which is of particular importance to you, please contact the office and we will be pleased to check the position for you, especially if you are contemplating travelling some distance to view the property.

Measurements: These approximate room sizes are only intended as general guidance. You must verify the dimensions carefully before ordering carpets or any built-in furniture.

Services: Please note we have not tested the services or any of the equipment or appliances in this property, accordingly we strongly advise prospective buyers to commission their own survey or service reports before finalizing their offer to purchase.

THESE PARTICULARS ARE ISSUED IN GOOD FAITH BUT DO NOT CONSTITUTE REPRESENTATIONS OF FACT OR FORM PART OF ANY OFFER OR CONTRACT. THE MATTERS REFERRED TO IN THESE PARTICULARS SHOULD BE INDEPENDENTLY VERIFIED BY PROSPECTIVE BUYERS OR TENANTS. NEITHER DOYLE SALES & LETTINGS NOR ANY OF ITS EMPLOYEES OR AGENTS HAS ANY AUTHORITY TO MAKE OR GIVE ANY REPRESENTATION OR WARRANTY WHATEVER IN RELATION TO THIS PROPERTY.

YOUR HOME IS AT RISK IF YOU DO NOT KEEP UP REPAYMENTS ON A MORTGAGE OR OTHER LOAN SECURED ON IT.

Written quotations available on request. All loans secured on property. Life assurance is usually required.

EPC Rating C

