

ferguson young

YOUR LOCAL INDEPENDENT ESTATE AGENTS

£65,000

Plot Adjacent To 1 Castle View Close, Redruth, Cornwall, TR15 1HF



- BUILDING PLOT
- DETACHED DWELLING
- TWO STOREY
- LEVEL PLOT
- SERVICES CLOSE BY
- PA23/02427
- INCREASINGLY RARE OPPORTUNITY
- SELF BUILD OR DEVELOPER

Increasingly rare opportunity to purchase a building plot on an established residential road with outline consent to build a detached two storey dwelling with off road parking. The plot is level, majority cleared and with all services close by.

Would suit Self-Build or Developer.

Planning documents can be viewed on the Cornwall Council website under planning reference PA23/02427.

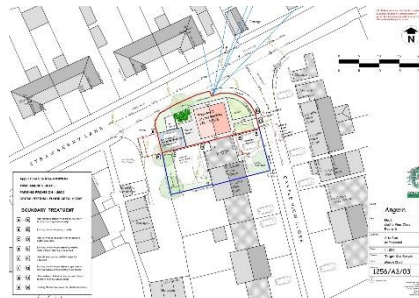

01209 219911

www.fergusonyoung.co.uk

sales@fergusonyoung.co.uk

Plot Adjacent To, 1 Castle View Close, Redruth, Cornwall, TR15 1HF

Adjacent to 1 Castle View Close Redruth TR15 1HF with outline consent for a two storey detached dwelling with off road parking.

All Services and close by and the ploy is level and has been majority cleared.

Full details and documents can be viewed on the Cornwall Council Planning Portal under planning reference PA23/02427.

Cornwall Council

Correspondence Address: Cornwall Council Planning, PO Box 676, Three Mile Cross, Truro, TR1 3EQ
Email: planning@cornwall.gov.uk
Tel: 0300 1234567
Web: www.cornwall.gov.uk



Application number: PA23/02427

Agent: Mr Charles Green
Silver Fields
Chapel Street
Redruth
Cornwall
TR15 2DT

Applicant: Mr And Mrs R Angwin
1 Castle View Close
Redruth
Cornwall
TR15 1HF

Town And Country Planning Act 1990 (As Amended) Town And Country Planning (Development Management Procedure) (England) Order 2015

Grant of Outline Planning Permission

CORNWALL COUNCIL, being the Local Planning Authority, **HEREBY GRANTS CONDITIONAL PERMISSION**, subject to the conditions set out on the attached schedule, for the development proposed in the following application received on 22 March 2023 and accompanying plan(s):

Description of Development: Outline Planning Permission with some reserved matters to include access and layout for proposed construction of a detached dwelling as well as existing settlement and formation of new vehicle and pedestrian access onto adjacent highway.

Location of Development: Land Adj To 1
Castle View Close
Redruth
Cornwall
TR15 1HF

Parish: Redruth

YOUR ATTENTION IS DRAWN TO THE ATTACHED NOTES.

DATED: 24 May 2023

Louise Wood - Service Director Planning and Housing (Chief Planner Officer)

General: While we endeavour to make our sales particulars fair, accurate and reliable, they are only a general guide to the property and, accordingly, if there is any point which is of particular importance to you, please contact the office and we will be pleased to check the position for you, especially if you are contemplating travelling some distance to view the property. Measurements: These approximate room sizes are only intended as general guidance. You must verify the dimensions carefully before ordering carpets or any built-in furniture. Services: Please note we have not tested the services or any of the equipment or appliances in this property, accordingly we strongly advise prospective buyers to commission their own survey or service reports before finalizing their offer to purchase. THESE PARTICULARS ARE ISSUED IN GOOD FAITH BUT DO NOT CONSTITUTE REPRESENTATIONS OF FACT OR FORM PART OF ANY OFFER OR CONTRACT. THE MATTERS REFERRED TO IN THESE PARTICULARS

SHOULD BE INDEPENDENTLY VERIFIED BY PROSPECTIVE BUYERS OR TENANTS. NEITHER FERGUSON YOUNG NOR ANY OF ITS EMPLOYEES OR AGENTS HAS ANY AUTHORITY TO MAKE OR GIVE ANY REPRESENTATION OR WARRANTY WHATEVER IN RELATION TO THIS PROPERTY.