

NORTH END,
BUCKHURST HILL

Farr O'Neil
RESIDENTIAL ESTATE AGENTS



Purpose built studio apartment | Refurbished throughout | Modern fitted kitchen | Contemporary bathroom with white suite | Open plan living/sleeping space | No onward chain | Only £40 per month service charge | Epping Forest close by | Queens Road & Central Line a walk away | EPC rating E47 / Council Tax band A

Guide Price
£191,500



Ideally situated on the edge of Epping Forest, but with easy access to the Central Line and Queens Road's boutiques shops, cafes and restaurants, is this totally refurbished studio apartment. The property offers a modern kitchen and bathroom, so ready to move straight into or rent out.

Location

North End is a delightful location, facing Roebuck Green, which is part of the wider Epping Forest, but well placed for access to the trendy shops, cafes and restaurants in Queens Road in Buckhurst Hill, and also the more traditional Loughton High Road. The Central Line gives easy access to the City, Canary Wharf and West End, and for road users, the M25, M11 and routes into London are conveniently close by. With Buckhurst Hill being surrounded by Epping Forest, there are plenty of leisure pursuits on hand.

Interior

Guys Retreat has a secure entry system with stairs to the first floor entrance. The accommodation consists of a spacious lounge/sleeping area with wood effect flooring, double glazed window and electric heater and there is a doorway to the kitchen. This has been fitted with a range of modern base and wall mounted units with contrasting worktops, and space for appliances and storage. The bathroom is similarly modern with a white suite and contrasting tiling.

Exterior

The block is surrounded by Epping Forest, so plenty of green space to enjoy, and there is unrestricted street parking in the area.

Agents note

The information we have been given is that the lease presently has 89 years remaining, and the service charge and ground rent payable amount to £40.20 per month.

First Floor

Approx. 23.5 sq. metres (253.3 sq. feet)

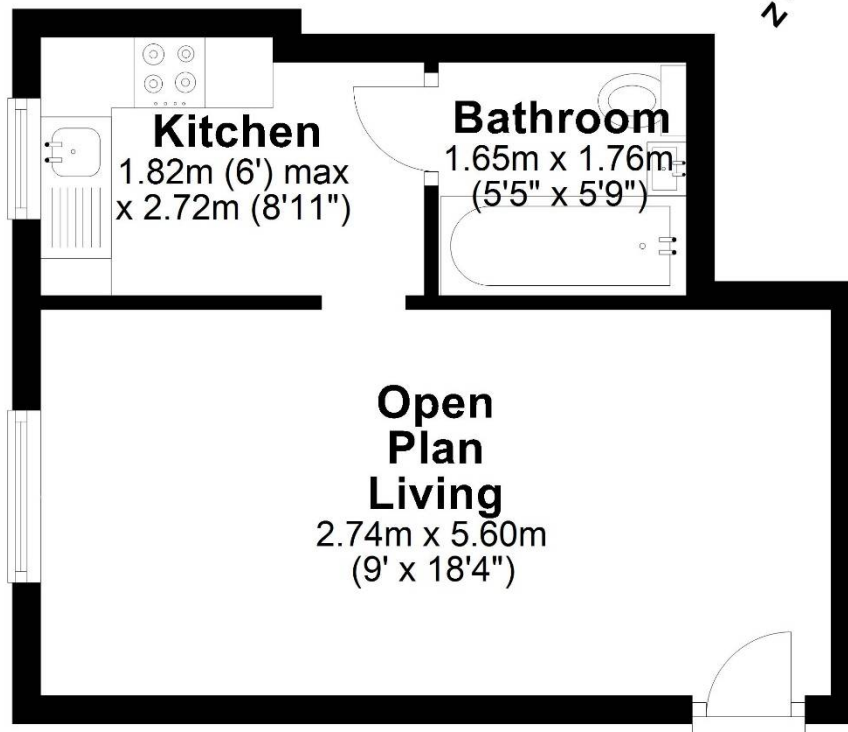
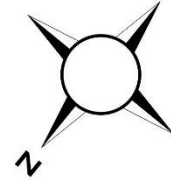

Total area: approx. 23.5 sq. metres (253.3 sq. feet)

First Floor

Approx. 23.5 sq. metres (253.3 sq. feet)

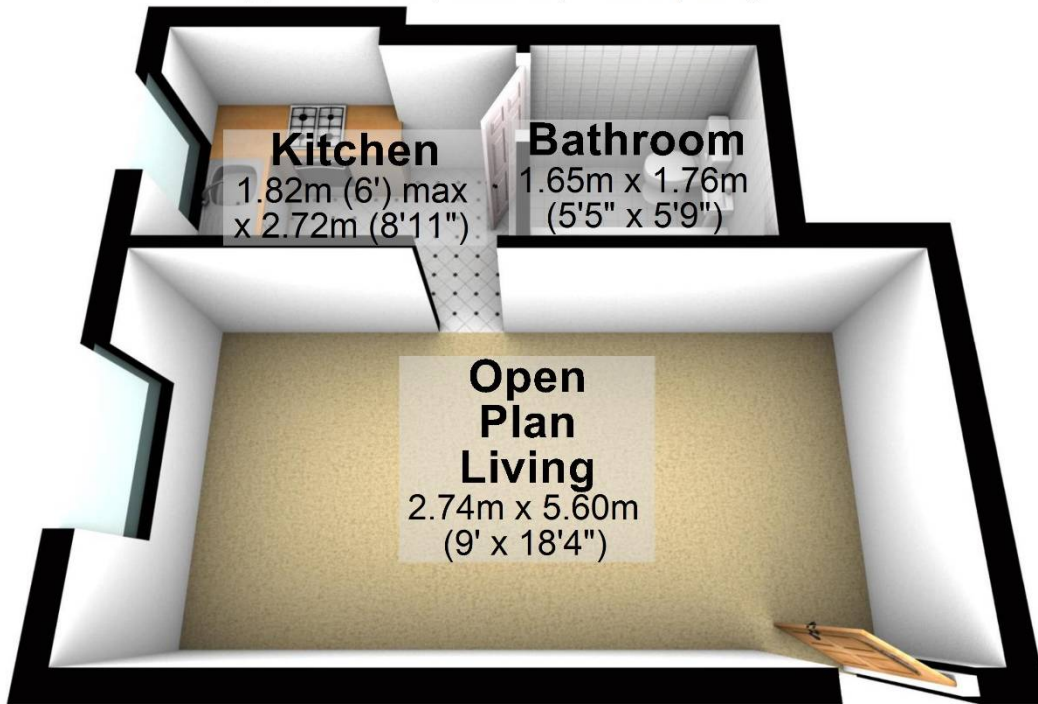

Total area: approx. 23.5 sq. metres (253.3 sq. feet)

Whilst every care is taken to ensure the accuracy of these details no responsibility for errors or misdescription can be accepted nor is any guarantee offered in respect of the property. These particulars do not constitute any part of an offer or contract.
Details Prepared on 7th November, 2022