

Barley Court EN7

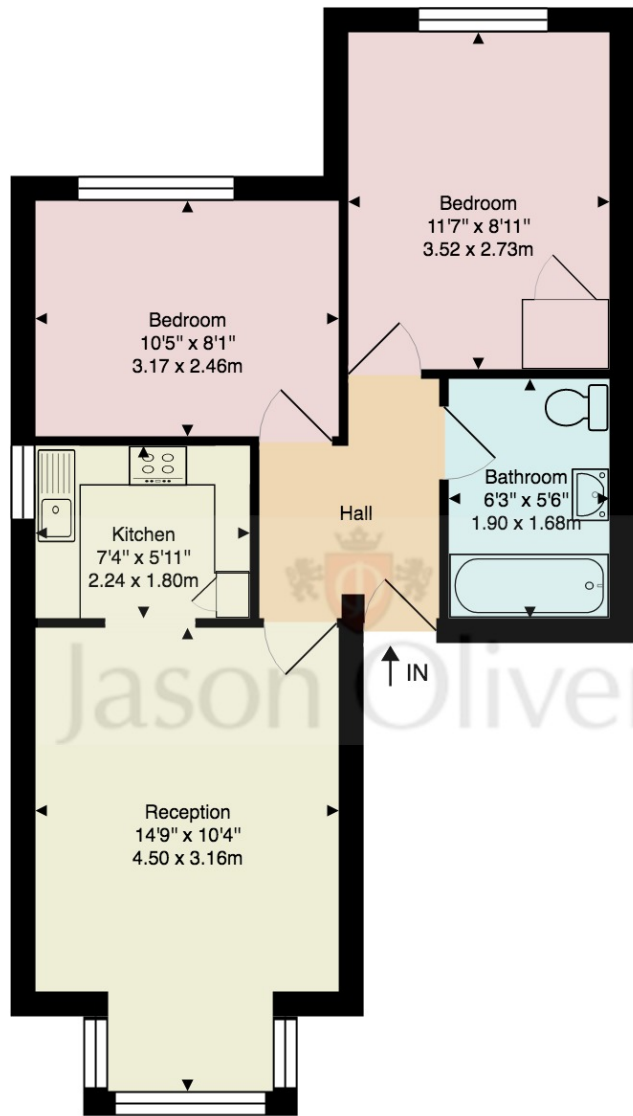

Approx. Gross Internal Area: 486 ft² ... 45.1 m²

All measurements and areas are approximate only.  
Dimensions are not to scale. This plan is for guidance  
only and must not be relied upon as a statement of fact.  
(c) Peninsula Surveys Ltd

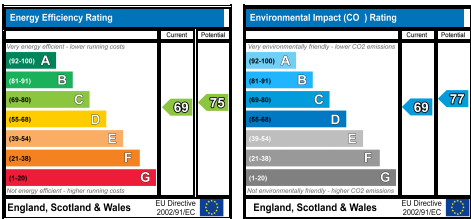

General: While we endeavour to make our sales particulars fair, accurate and reliable, they are only a general guide to the property and, accordingly, if there is any point which is of particular importance to you, please contact the office and we will be pleased to check the position for you, especially if you are contemplating travelling some distance to view the property. Measurements: These approximate room sizes are only intended as general guidance. You must verify the dimensions carefully before ordering carpets or any built-in furniture. Services: Please note we have not tested the services or any of the equipment or appliances in this property, accordingly we strongly advise prospective buyers to commission their own survey or service reports before finalizing their offer to purchase.THESE PARTICULARS ARE ISSUED IN GOOD FAITH BUT DO NOT CONSTITUTE REPRESENTATIONS OF FACT OR FORM PART OF ANY OFFER OR CONTRACT. THE MATTERS REFERRED TO IN THESE PARTICULARS SHOULD BE INDEPENDENTLY VERIFIED BY PROSPECTIVE BUYERS OR TENANTS. NEITHER JASON OLIVER PROPERTIES LTD NOR ANY OF ITS EMPLOYEES OR AGENTS HAS ANY AUTHORITY TO MAKE OR GIVE ANY REPRESENTATION OR WARRANTY WHATEVER IN RELATION TO THIS PROPERTY.



*Bury Green Road, Cheshunt, EN7*



A newly refurbished two double bedroom ground floor flat situated in West Cheshunt within close proximity to Cheshunt local amenities, Brookfield Shopping Centre and Cheshunt railway station. This property benefits from hallway, reception room, two double bedrooms, contemporary fitted kitchen, bathroom, wooden flooring throughout, residential off street parking, communal garden. This property is also walking distance and within catchment of desirable schools: Bonny Grove primary, Goffs Academy & Goffs Churchgate secondary schools. Available now. Viewing highly recommended.

**£1,050 pcm**

25 Heddon Court Parade, Cockfosters Road, Cockfosters, Herts EN4 0DB  
T 020 8449 2122 F 020 8449 2129 M 07811 668580 E [info@jasonoliverproperties.co.uk](mailto:info@jasonoliverproperties.co.uk)  
[www.jasonoliverproperties.co.uk](http://www.jasonoliverproperties.co.uk)



*Bury Green Road, Cheshunt, EN7*

**KITCHEN**  
7'4" x 5'11" (2.24m x 1.80m)

**RECEPTION**  
14'9" x 10'4" (4.50m x 3.15m)

**BEDROOM ONE**  
11'7" x 8'11" (3.53m x 2.72m)



*Bury Green Road, Cheshunt, EN7*

**BEDROOM TWO**  
10'5" x 8'1" (3.18m x 2.46m)

**BATHROOM**  
6'3" x 5'6" (1.91m x 1.68m)

