



Jenkinson realestates

North Barrack Road Deal

Asking Price £179,995

Freehold

Energy Performance Rating = E

- End of Terrace Cottage
- In Need of Modernisation
- Cash Purchasers Only
- No Onward Chain
- Offering Two Bedrooms
- Walking Distance to Seafront

*** CASH PURCHASERS ONLY
*** Exclusively via Jenkinson Estates is this end of terraced cottage situated within a short stroll to Walmer green and seafront. This particular property is located in the pedestrian part of North Barrack Road with other similar houses. This property comes with No Onward Chain Complications but does require some updating. Comprising two double bedrooms to the first floor, to the ground floor there is a Living room, Kitchen / Breakfast Room that then leads to a Bathroom and Rear Courtyard. This is a home in a great setting and has the potential to be a really charming cottage, available for immediate viewing. All viewings are through the appointed Sole Agents Jenkinson Estates.





GROUND FLOOR

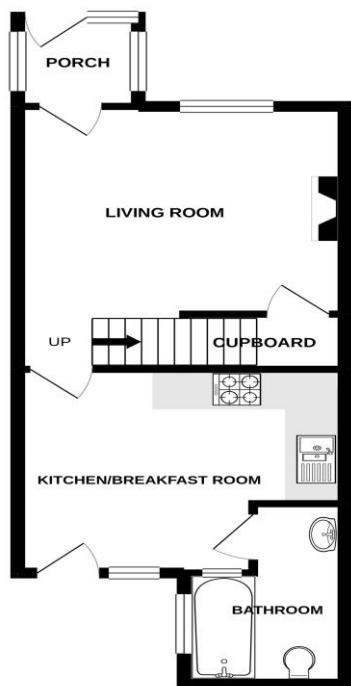

1ST FLOOR

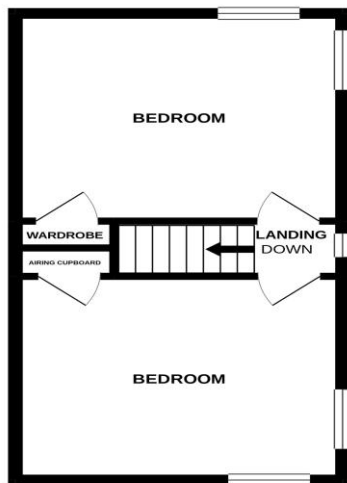

Whilst every attempt has been made to ensure the accuracy of the floorplan contained here, measurements of doors, windows, rooms and any other items are approximate and no responsibility is taken for any error, omission or mis-statement. This plan is for illustrative purposes only and should be used as such by any prospective purchaser. The services, systems and appliances shown have not been tested and no guarantee as to their operability or efficiency can be given.
Made with Metropix ©2020

01304 373 984
info@jenkinsonstates.co.uk
www.jenkinsonstates.co.uk

Important Notice - These particulars have been prepared in good faith and they are not intended to constitute part of an offer or contract. We have not performed a structural survey on this property and the services, appliances and specific fittings have not been tested. All photographs, measurements, floor plans and distances referred to are given as a guide and should not be relied upon.



Accommodation

Entrance Porch

Living Room

11'6" x 10'10" (3.51m x 3.30m)

Kitchen / Breakfast Room

11'8" x 10'4" (3.56m x 3.15m)

Bathroom

8'9" x 5'3" (2.67m x 1.60m)

First Floor

Bedroom One

11'7" x 10'10" (3.53m x 3.30m)

Bedroom Two

10'9" x 10'4" (3.28m x 3.15m)

Rear Courtyard

5'0" x 5'0" (1.52m x 1.52m)

