



Jenkinson realestates

Wellington Court  
Beechwood Avenue | Deal  
Asking Price £159,995

# Leasehold

Energy Performance Rating = B

First Floor Flat

Offering One Bedroom

Popular Retirement Development

Recently Updated

Residents Parking

No Onward Chain Complications

Jenkinson Estates are pleased to be able to offer new to the market this first floor flat, situated in the popular development of Wellington Court. This complex is located on the edge Deal's Town Centre and the residents all enjoy the benefits of a Residential House Manager, communal lounge, communal gardens and round the clock access to Emergency Care line via pull cords throughout. The complex offers a good social atmosphere plus guest suite to the ground floor. The property offers good size accommodation throughout including a living / dining room which overlooks London Road and opens into the kitchen. The property continues to impress with the double bedroom, complete with a fitted wardrobe and bathroom. This apartment is on the first floor and is in the perfect position making easily accessible to the lift. The property come to the market with no onward chain complications. All viewings are strictly by appointment via the Sole Agent Jenkinson Estates.



Council Tax Band B

Lease length 108 Years

Maintenance - £2,641.88p/a

Ground Rent - £395.00p/a



FIRST FLOOR

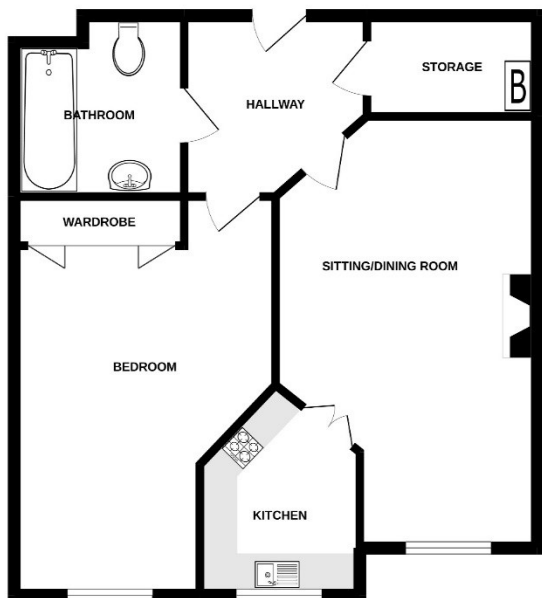

While every attempt has been made to ensure the accuracy of the floorplan contained here, measurements of doors, windows, rooms and any other items are approximate and no responsibility is taken for any error, omission or misstatement. This plan is for illustrative purposes only and should not be used as such by any prospective purchaser. The services, systems and appliances shown have not been tested and no guarantee as to their operability or efficiency can be given.  
Made with Lettings 12/22



Accommodation

Bathroom

Entrance Hallway

6'8" x 5'6" (2.03m x 1.68m)

Living / Dining Room

Communal Gardens

19'8" x 10'6" (5.99m x 3.20m)

Residents Parking

Kitchen

7'6" x 7'6" (2.29m x 2.29m)

Bedroom

17'9" x 9'3" (5.41m x 2.82m)

Jenkinson Estates

4 West Street, Deal, Kent, CT14 6AE

01304 373 984

info@jenkinsonestates.co.uk

www.jenkinsonestates.co.uk

Important Notice - These particulars have been prepared in good faith and they are not intended to constitute part of an offer or contract. We have not performed a structural survey on this property and the services, appliances and specific fittings have not been tested. All photographs, measurements, floor plans and distances referred to are given as a guide and should not be relied upon.

