



Jenkinson realestates

Hancocks Field

Deal

Asking Price £225,000

Freehold

Energy Performance Rating = C

End of Terrace Home
Allocated Parking Space

Offering Two Bedrooms
Ideal Investment

Front and Rear Gardens
No Onward Chain

Jenkinson Estates are pleased to bring new to the market this end of terrace home in the popular location of Hancocks Field, Deal. The property comes to the market with no onward chain complications and would make an ideal first time purchase of investment. The property offers a spacious living / dining room, which is over 15ft in length. The kitchen completes the ground floor accommodation. The first floor offers two bedrooms and a family bathroom. The garden is low maintenance and has gated access to the parking, which is to the rear of the property for one car. All viewings are strictly through the appointed Sole Agents Jenkinson Estates.



Council Tax Band B



GROUND FLOOR

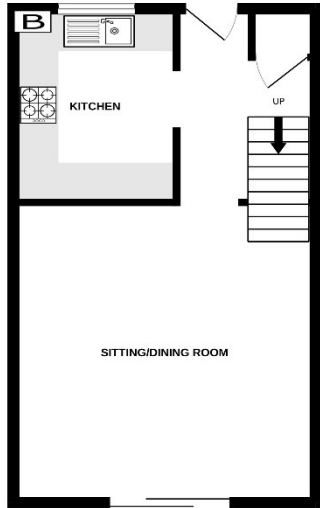

1ST FLOOR

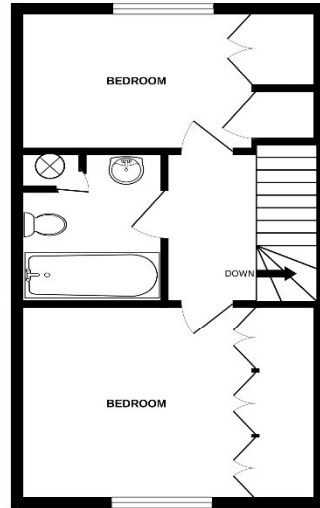

Whilst every attempt has been made to ensure the accuracy of the description contained herein, measurements of doors, windows, rooms and any other items are approximate and no responsibility is taken for any error, omission or mis-statement. This plan is for illustrative purposes only and should be used as such by any prospective purchaser. The services, fixtures and appliances shown have not been tested and no guarantee as to their operability or efficiency can be given.
Made with Meeqpa G2023



Accommodation

Entrance via

Entrance Hallway

Kitchen

7'8" x 5'6" (2.34m x 1.68m)

Living Room

15'6" x 11'6" (4.72m x 3.51m)

First Floor Landing

Bedroom One

9'2" x 9'7" plus wardrobe (2.79m x 2.92m)

Bedroom Two

9'7" plus wardrobe x 7'0" (2.92m x 2.13m)

Bathroom

Front and Rear Gardens

Jenkinson Estates

4 West Street, Deal, Kent, CT14 6AE

01304 373 984

info@jenkinsonestates.co.uk

www.jenkinsonestates.co.uk

Important Notice - These particulars have been prepared in good faith and they are not intended to constitute part of an offer or contract. We have not performed a structural survey on this property and the services, appliances and specific fittings have not been tested. All photographs, measurements, floor plans and distances referred to are given as a guide and should not be relied upon.

