



Jenkinson realestates

Mongeham View
St Richards Road | Deal

Leasehold

Energy Performance Rating = D

Ground Floor Apartment
Shared Patio to Rear

Offering One Double Bedroom
Family Bathroom

Allocated Parking
No Onward Chain

Jenkinson Estates are pleased to bring to the market and with No Onward chain complications this ground floor retirement apartment located in Mongeham View, St Richards Road. Deal. This is a small complex of retirement flats comprising of seven apartments. The property is presented well throughout and offers living room, bathroom, kitchen and a bedroom. The property is double glazed and there are electric storage heaters. There is a allocated parking space to the rear of the apartments along with a guest suite for residents family if required which is on a booking system. The added bonus with this apartment there is a bus stop outside the building. All viewings are strictly by appointment with the sole agents Jenkinson Estates.



Council Tax Band A

Vendor advises as of 11/23:

Lease Length - 999 Years from 1990

Maintenance - £533.60p/a

2% Selling Clawback



GROUND FLOOR

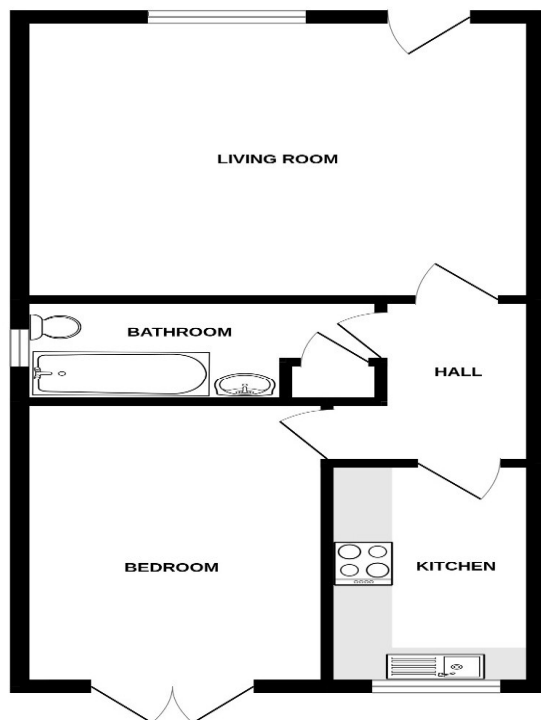

Whilst every attempt has been made to ensure the accuracy of the floorplan contained here, measurements of doors, windows, rooms and any other items are approximate and no responsibility is taken for any error, omission or mis-statement. This plan is for illustrative purposes only and should be used as such by any prospective purchaser. The services, systems and appliances shown have not been tested and no guarantee as to their operability or efficiency can be given.
Made with Metropix 6/2023

Jenkinson Estates
4 West Street, Deal, Kent, CT14 6AE

01304 373 984
info@jenkinsonestates.co.uk
www.jenkinsonestates.co.uk

Important Notice - These particulars have been prepared in good faith and they are not intended to constitute part of an offer or contract. We have not performed a structural survey on this property and the services, appliances and specific fittings have not been tested. All photographs, measurements, floor plans and distances referred to are given as a guide and should not be relied upon.



Accommodation

Living Room

14'4" x 11'8" (4.37m x 3.56m)

Bathroom

10'8" x 4'7" (3.25m x 1.40m)

Kitchen

8'7" x 4'7" (2.62m x 1.40m)

Bedroom

11'8" x 8'9" (3.56m x 2.67m)

Allocated Parking

