



Jenkinson realestates

Victoria Mews  
Bridgeside | Deal  
Asking Price £145,000

# Leasehold

Energy Performance Rating = TBC

Ground Floor Apartment  
Spacious Shower Room

Offering One Bedroom  
Communal Gardens

Living / Dining Room  
Residents Parking

Jenkinson Estates are pleased to be able to bring to the marketplace this ground floor apartment which is located in the popular retirement complex of Victoria Mews, Bridgeside. The property offers spacious accommodation throughout including a living / dining room, a well appointed kitchen, one double bedroom which is completed with built in wardrobes. The shower room completes the accommodation. The property has double glazing throughout and a gas fired central heating system. There is the added bonus of residents parking and communal gardens. All viewings are strictly by appointment via the Sole Agent Jenkinson Estates.



Council Tax Band A

Lease length TBC

Maintenance TBC

Ground Rent TBC

Clawback TBC



GROUND FLOOR

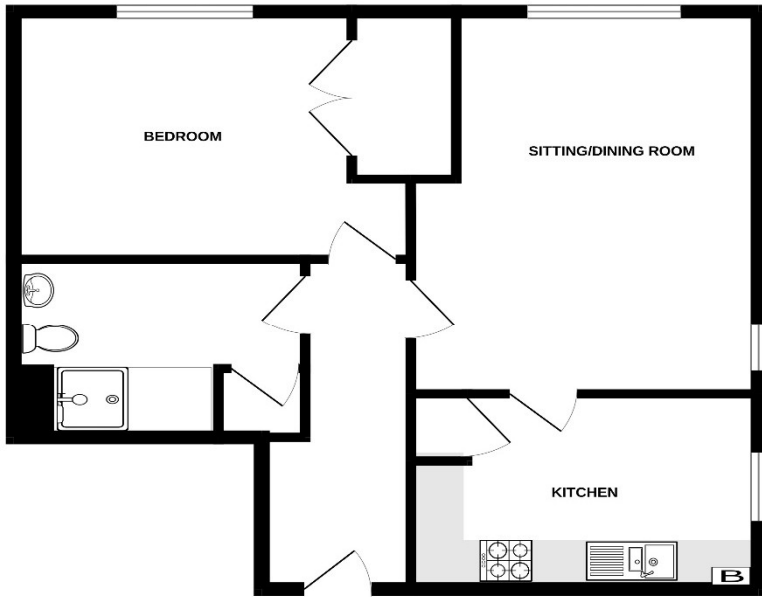

Whilst every attempt has been made to ensure the accuracy of the floorplan contained here, measurements of doors, windows, rooms and any other items are approximate and no responsibility is taken for any omission or mis-statement. This plan is for illustrative purposes only and should be used as such by any prospective purchaser. The services, systems and appliances shown have not been tested and no guarantee as to their operability or efficiency can be given.  
Made with Homestyler ©2024



Accommodation

Entrance Via;

Hallway

Living / Dining Room

15'7" x 11'2" (4.75m x 3.40m)

Kitchen

10'5" x 8'6" (3.18m x 2.59m)

Bedroom One

13'2" x 9'7" (4.01m x 2.92m)

Shower Room

Residents Parking

Communal Gardens

Jenkinson Estates

4 West Street, Deal, Kent, CT14 6AE

01304 373 984

info@jenkinsonestates.co.uk

www.jenkinsonestates.co.uk

Important Notice - These particulars have been prepared in good faith and they are not intended to constitute part of an offer or contract. We have not performed a structural survey on this property and the services, appliances and specific fittings have not been tested. All photographs, measurements, floor plans and distances referred to are given as a guide and should not be relied upon.

