



Jenkinson realestates

Beechwood Avenue

Deal

Asking Price £159,950

Leasehold

Energy Performance Rating = TBC

Second Floor Retirement Flat
No Onward Chain

Offering One Double Bedroom
Shower Room

Overlooking Communal Gardens
Residents Parking

Jenkinson Estates are pleased to be able to offer to the market this second floor retirement apartment which is accessible via lift or stairs and is situated in a popular retirement development. This apartment comprises of a large double bedroom with fitted wardrobe, living room/dining room with views across the communal gardens, a kitchen and shower room. This retirement complex is located on the edge Deal's Town Centre and the residents all enjoy the benefits of a Residential House Manager, communal lounge, communal gardens and round the clock access to Emergency Care line via pull cords throughout. All viewings are strictly by appointment via the Sole Agent Jenkinson Estates.



Council Tax Band B

Vendor advises (06/24);

Lease - 125 years from 1st March 2005

Maintenance / Service Charge - £3,256.22p/a

Ground Rent - £395.00p/a

Claw Back - TBC



SECOND FLOOR

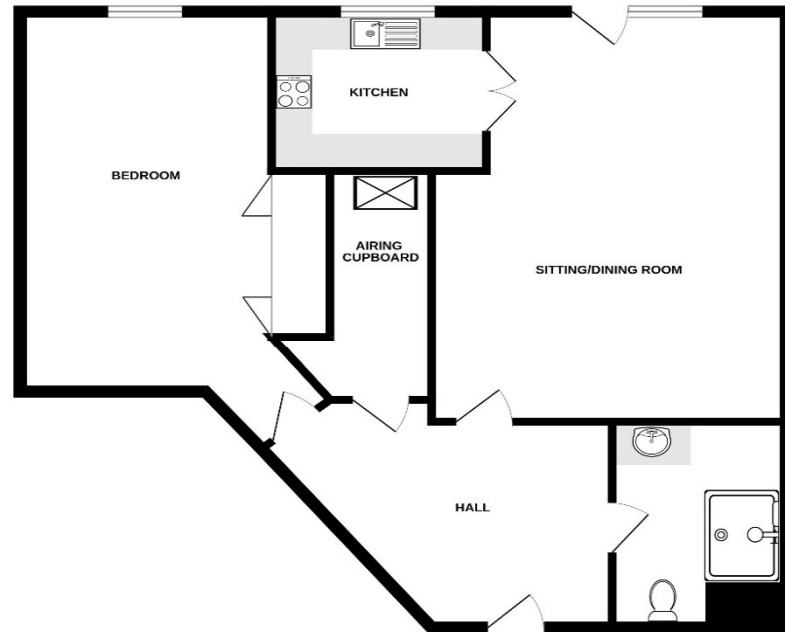

Whilst every attempt has been made to ensure the accuracy of the floorplan contained here, measurements of doors, windows, rooms and any other items are approximate and no responsibility is taken for any error, omission or misstatement. This plan is for illustrative purposes only and should be used as such by any prospective purchaser. The services, systems and appliances shown have not been tested and no guarantee as to their operability or efficiency can be given.
Made with Floorplan 02/24

Jenkinson Estates
4 West Street, Deal, Kent, CT14 6AE

01304 373 984

info@jenkinsonestates.co.uk

www.jenkinsonestates.co.uk

Important Notice - These particulars have been prepared in good faith and they are not intended to constitute part of an offer or contract. We have not performed a structural survey on this property and the services, appliances and specific fittings have not been tested. All photographs, measurements, floor plans and distances referred to are given as a guide and should not be relied upon.



Accommodation

Entrance Hall

10'9" x 7'5" (3.28m x 2.26m)

Living Room

14'1" x 9'5" (4.29m x 2.87m)

Kitchen

9'1" x 5'7" (2.77m x 1.70m)

Bedroom

14'1" x 9'5" (4.29m x 2.87m)

Shower Room

6'8" x 6'7" (2.03m x 2.01m)

Communal Gardens

Communal Parking

