



Jenkinson realestates

Wellington Court  
Beechwood Avenue | Deal  
Asking Price £210,000



# Leasehold

Energy Performance Rating = C

Top Floor Apartment

Residents Parking

Offering Two Bedrooms

Communal Gardens

Spacious Sitting / Dining Room

No Onward Chain

Jenkinson Estates are pleased to be able to offer to the market place this second floor retirement flat. The flat is accessible via lift or stairs, overlooks London Road and is situated in this popular retirement complex of Wellington Court. This desirable flat has spacious accommodation and comprises of two generous double bedrooms with a fitted wardrobe, sitting / dining room and a well appointed kitchen. The flat is completed with a recently modernised shower room. This complex is located on the edge Deal's Town Centre and the residents all enjoy the benefits of a Residential House Manager, communal lounge, communal gardens and round the clock access to Emergency Care line via pull cords throughout. The complex offers a good social atmosphere plus guest suite, communal lounge area and laundry facilities to the ground floor. Offering great peace of mind in a lovely, well maintained and managed environment all within a short walk of the town. Viewings are highly recommended to appreciate what this charming flat has to offer and are strictly by appointment, exclusively Via Jenkinson Estates.

Council Tax Band C

As of 04/2025:

105 Years Remaining on the Lease

Maintenance / Service Charge - £5,096.85

Ground Rent - £460p/a

Claw Back - TBC









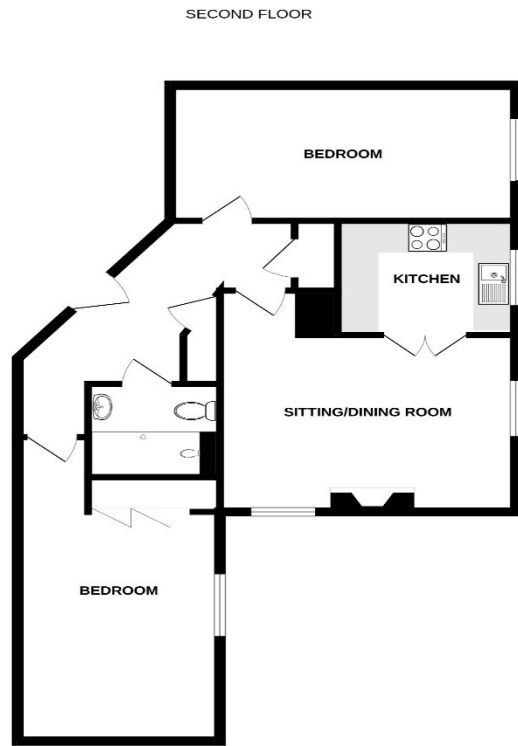

Whilst every attempt has been made to ensure the accuracy of the floorplan contained here, measurements of doors, windows, rooms and any other details are approximate and no responsibility is taken for any error, omission or mis-statement. This plan is for illustrative purposes only and should be used as such by any prospective purchaser. The services, systems and appliances shown have not been tested and no guarantee as to their operability or efficiency can be given. Made with Metagame i3D2x

Jenkinson Estates  
4 West Street, Deal, Kent, CT14 6AE

01304 373 984  
info@jenkinsonestates.co.uk  
www.jenkinsonestates.co.uk

Important Notice - These particulars have been prepared in good faith and they are not intended to constitute part of an offer or contract. We have not performed a structural survey on this property and the services, appliances and specific fittings have not been tested. All photographs, measurements, floor plans and distances referred to are given as a guide and should not be relied upon.

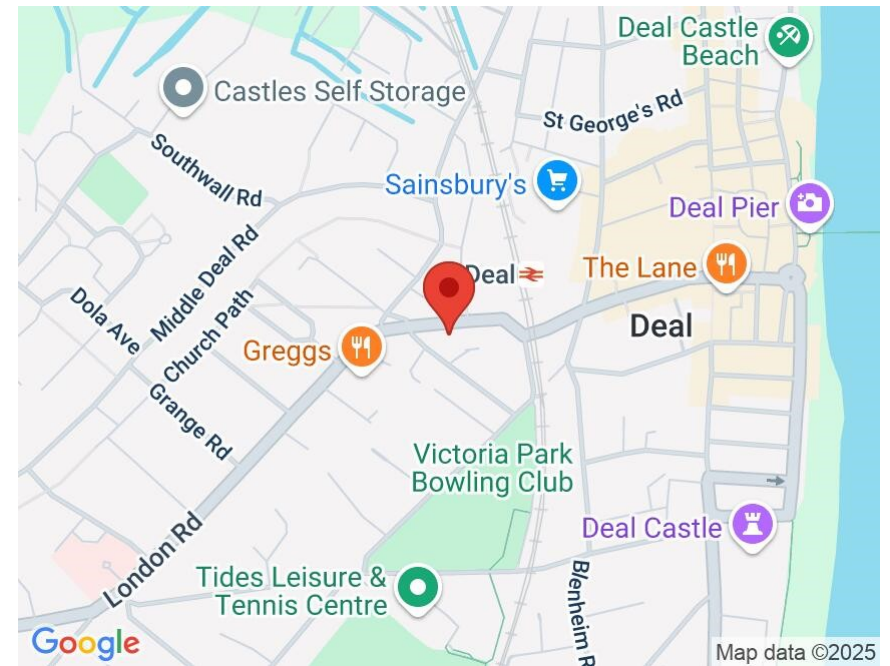

#### Accommodation

Entrance Via;

Hallway

Living / Dining Room

15'7" x 13'9" (4.75m x 4.19m)

Kitchen

8'7" x 6'8" (2.62m x 2.03m)

Bedroom One

14'7" x 9'3" (4.45m x 2.82m)

Bedroom Two

15'6" x 9'3" (4.72m x 2.82m)

Shower Room

6'5" x 6'2" (1.96m x 1.88m)

Storage Cupboards

Residents Parking

Communal Parking

