



Jenkinson realestates

Archery Square | Walmer

Deal

Asking Price £249,995

LH+ShareFH

70 SQ. Metres (753.47 SQ. Feet)

Council Tax: B

EPC Rating = D

First Floor Apartment

Offering Two Bedrooms

Spacious Bay-Fronted Sitting Room

Views Across Walmer Tennis Club

Close To Seafront

Ideal for First Time Buyers

Jenkinson Estates are pleased to bring to the market this first floor apartment situated in the popular location of Archery Square, Walmer. This apartment is accessed via an inner hallway that leads to the front door, which is located on the first floor. From here there is access to a study / bedroom and an impressive sitting room, which features exposed brickwork each side of the bay window. Both of these rooms offer stunning views across Walmer Lawn Tennis & Croquet Club. The property continues with the main bedroom, complete with fitted wardrobes, an I-shaped kitchen / breakfast room and the family bathroom. The property has a gas fired central heating system. All viewings are strictly by appointment via the Sole Agent Jenkinson Estates.



Vendor advises, as of 03/2026;

Share of Freehold

99 Year Lease from Dec '04

Outgoings - £600.00p/a



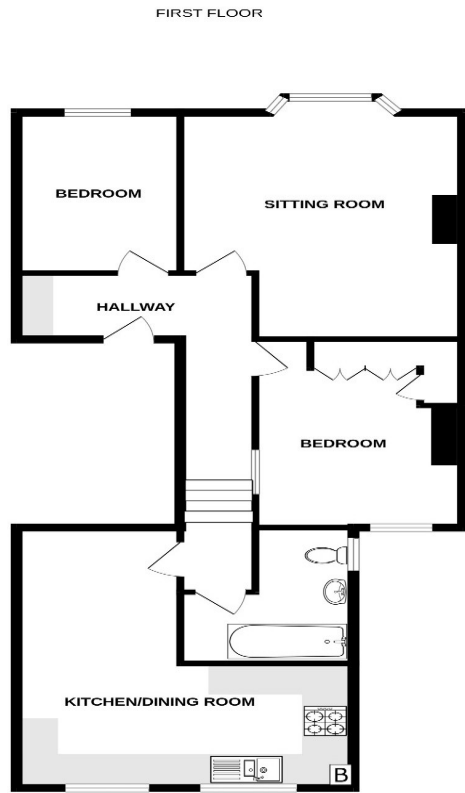

Whilst every attempt has been made to ensure the accuracy of the floorplan contained here, measurements of doors, windows, rooms and any other items are approximate and no responsibility is taken for any error, omission or mis-statement. This plan is for illustrative purposes only and should be used as such by any prospective purchaser. The services, systems and appliances shown have not been tested and no guarantee as to their operability or efficiency can be given.
Made with Metrage 5/2026

Jenkinson Estates
4 West Street, Deal, Kent, CT14 6AE

01304 373 984
info@jenkinsonestates.co.uk
www.jenkinsonestates.co.uk

Important Notice - These particulars have been prepared in good faith and they are not intended to constitute part of an offer or contract. We have not performed a structural survey on this property and the services, appliances and specific fittings have not been tested. All photographs, measurements, floor plans and distances referred to are given as a guide and should not be relied upon.

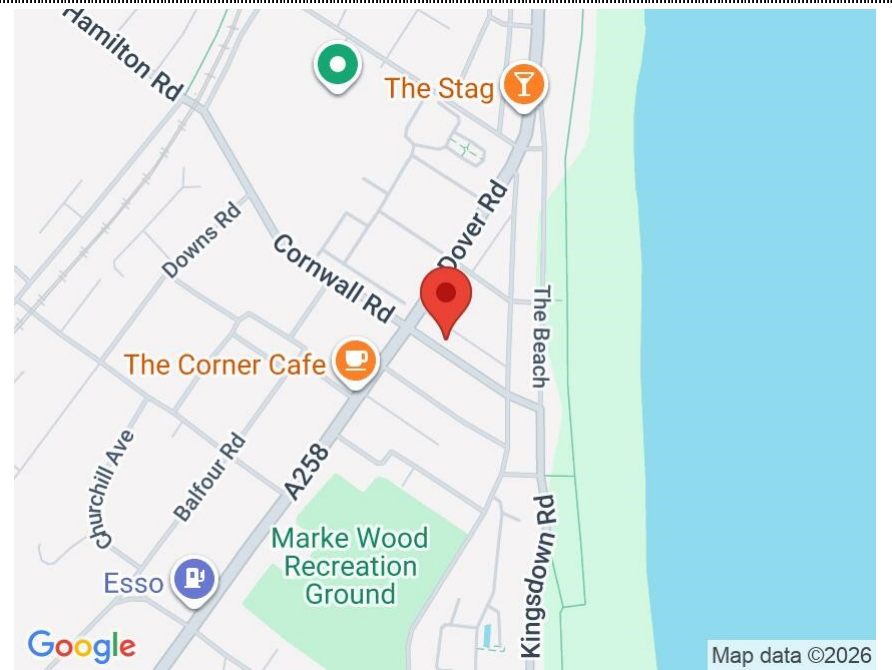

Accommodation

Entrance Via;
Staircase to First Floor
Hallway

Sitting Room
18'0" x 15'8" (5.49m x 4.78m)

Kitchen / Dining Room
16'2" x 13'7" (4.93m x 4.14m)

Bedroom One
14'5" x 12'5" (4.39m x 3.78m)

Bedroom Two / Study
11'7" x 6'11" (3.53m x 2.11m)

Family Bathroom
7'6" x 7'2" (2.29m x 2.18m)

