



Jenkinson estates

Church Meadows

Deal

Rental of £1,300.00pcm

## AST Managed

Energy Performance Rating = C

- Holding Deposit £300.00
- Security Deposit £1500.00
- Council Tax Band B
- Three Bedrooms
- Sitting Room
- Conservatory

Jenkinson Estates Lettings are delighted to be able to offer this well-appointed terraced house that has been re-configured to create a much-improved layout and now provides three bedrooms. Situated in the popular location of Church Meadows, the accommodation comprises: sitting room that is over 15ft with doors leading out to a fully fitted kitchen which offers a range of built in appliances. There is also access to a downstairs bathroom with three piece suite and utility cupboard. Finally, a conservatory which leads to the enclosed rear garden. To the first floor there is a master bedroom with en-suite shower facility, a separate W.C. with basin and two further bedrooms. There are gardens to both front and rear along with a single garage.





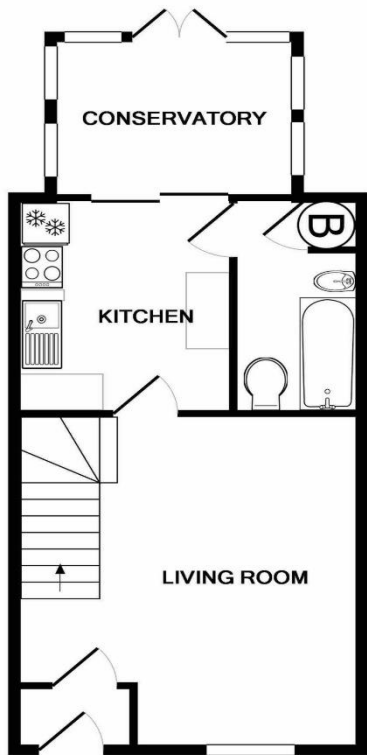

GROUND FLOOR

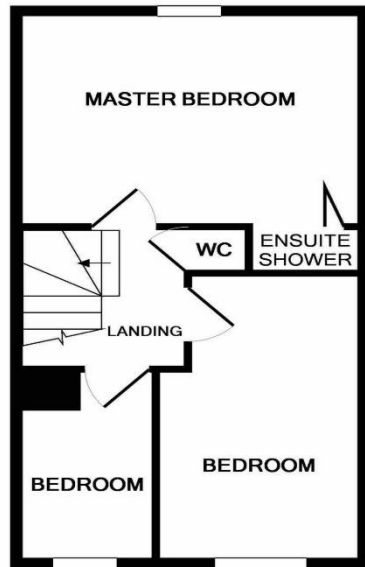

1ST FLOOR



Accommodation

Whilst every attempt has been made to ensure the accuracy of the floor plan contained here, measurements of doors, windows, rooms and any other items are approximate and no responsibility is taken for any error, omission, or mis-statement. This plan is for illustrative purposes only and should be used as such by any prospective purchaser. The services, systems and appliances shown have not been tested and no guarantee as to their operability or efficiency can be given  
 Made with Metropix ©2017

**Jenkinson Estates Lettings**  
 6 West Street, Deal, Kent, CT14 6AE

01304 373984

lettings@jenkinsonstates.co.uk

www.jenkinsonstates.co.uk

Important Notice - These particulars have been prepared in good faith and they are not intended to constitute part of an offer or contract. We have not performed a structural survey on this property and the services, appliances and specific fittings have not been tested. All photographs, measurements, floor plans and distances referred to are given as a guide and should not be relied upon.

