



49 High Street, Hythe, Kent CT21 5AD

NO ONWARD CHAIN



**1 GRAND COURT,
EARLS AVENUE, FOLKESTONE**

£335,000 Leasehold

To Include A Share In The Freehold

Enviably situated in an exclusive West End location, a beautifully appointed upper ground floor apartment enjoying spacious accommodation including a generous living space with south/west facing balcony enjoying views to The Leas and the sea, well fitted kitchen and 3 bedrooms. Secure underground garage/parking. EPC D



1 Grand Court, Earls Avenue, Folkestone, Kent CT20 2EU

Communal Entrance Hall, Entrance Hall, Sitting/Dining Room, Balcony, Kitchen, Three Bedrooms, Bathroom, Separate W.C., Secure Underground Garage with Allocated Parking Bay/Storage

DESCRIPTION

Grand Court is a highly regarded block of just nine apartments in a prestigious West End location, seconds from The Leas, a pleasant walk from the beach and a level walk to Folkestone Central.

This upper ground floor apartment, which is offered for sale with the benefit of no onward chain, offers attractively refurbished, light and airy accommodation which is of particularly comfortable proportions. This includes an entrance hall with ample storage, a generous living space flooded with light from the large west facing picture window and south facing door which opens to a pleasant balcony from where you can enjoy a beautiful vista over The Leas and of the sea. There is a smartly fitted kitchen, three very comfortable bedrooms, a bathroom and a separate W.C.

Whilst on street parking is readily available with a residents permit, the property also enjoys the unusual advantage of a wide garage within the secure underground parking facility.

SITUATION

Earls Avenue is a particularly sought after location leading to The Leas Promenade and Shorncliffe Road which provides direct access to Folkestone West Mainline Station. The property is situated within Folkestone's sought after West End approximately 1 mile from Folkestone town centre and a short, level walk from Folkestone Central Station where the High Speed Link to London, St Pancras is available (journey times of under an hour). The picturesque Leas Promenade is moments away from where access can be gained to the coastal path at the foot of The Leas which can be followed all the way to Folkestone Harbour with the recently revitalised Harbour Arm with champagne bar, restaurants, cafes and live music. The vibrant village of Sandgate with its eclectic mix of village store, antiques shops, boutiques, public houses, cafes and restaurants is a little further where the long stretches of shingle beach and sailing club can be found by meandering down one of the pretty lanes or alleyways from the high street. The Cinque Ports Town of Hythe with its bustling High street and Waitrose, is approximately 5 miles away to the west.

There is a variety of sporting facilities available along the coast, including rowing and sailing clubs, cricket, squash and bowls clubs. There are also a choice of golf courses in the immediate vicinity together with the Hotel Imperial Leisure Centre. The High Speed Rail Link service to London, with a journey time to St Pancras of less than an hour, is available at Folkestone West Station and Ashford International (16 miles). The M20 motorway network and the Channel Tunnel Terminal at Cheriton (Calais 35 minutes) are about 1 and 3 miles distant respectively.

The accommodation comprises:

COMMUNAL ENTRANCE HALL

Door to:-

ENTRANCE HALL

Access to shelved storage cupboard and to built-in fridge freezer, polished woodblock parquet flooring, entry phone, doors to:-



BEDROOM 2

Double glazed window to front, coved ceiling, polished woodblock parquet flooring, radiator.

BEDROOM 3

Double glazed window to rear, coved ceiling, polished woodblock parquet flooring, radiator.

BEDROOM 1

Double glazed window to front, access to built-in cupboard, coved ceiling, polished woodblock parquet flooring, radiator.

CLOAKROOM

Low level WC, wall hung wash basin, part tiled walls, obscured double glazed window to rear.

BATHROOM

P ended shower bath, wall hung wash basin with mixer tap and vanity drawer below, obscured double glazed window, heated towel rail.

KITCHEN

Fitted with a range of base cupboard and drawer units incorporating recess and plumbing for washing machine and slimline dishwasher, recess housing Logik dual fuel range cooker with extractor hood above, square edged woodblock worksurfaces inset with stainless steel sink and drainer unit with mixer tap, coordinating upstands, cupboard housing gas boiler, double glazed window to side, serving hatch to sitting/dining room, coved, ceiling, radiator.

SITTING/DINING ROOM

Double glazed windows to front and side with views towards the sea, serving hatch to kitchen, two radiators, coved ceiling, polished woodblock parquet flooring, double glazed door to:-

BALCONY

Well enclosed, stone paved and enjoying views of the sea.

GARAGE/PARKING

The apartment benefits from an allocated parking space in the secure undercroft garage and is accessed via an electronically operated door from Earls Avenue.

LEASE DETAILS

We understand that the apartment has the remainder of a 999 year lease which commenced circa 1968. Although a share of the freehold is included in the sale.

The garage is held on a separate title and lease with the remainder of a 999 year lease which commenced in 1968.

SERVICE CHARGE

We are advised that the annual service charge is circa £1792.88 PA (payable in 2 instalments).

EPC Rating Band D

COUNCIL TAX

Band C approx. £2081.45 (2024/25)
Folkestone & Hythe District Council.

VIEWING

Strictly by appointment with **LAWRENCE & CO, 01303 266022.**

Lawrence & Co for itself and as agent for the vendor or lessor (as appropriate) gives notice that: 1 These particulars are only a general outline for the guidance of intending purchasers or lessees and do not constitute in whole or in part an offer or a Contract. 2 Reasonable endeavours have been made to ensure that the information given in these particulars is materially correct but any intending purchaser or lessee should satisfy themselves by inspection, searches, enquiries and survey as to the correctness of each statement. 3 All statements in these particulars are made without responsibility on the part of Lawrence & Co or the vendor or lessor. 4 No statement in these particulars is to be relied upon as a statement or representation of fact. 5 Neither Lawrence & Co nor anyone in its employment or acting on its behalf has authority to make any representation or warranty in relation to this property. 6 Nothing in these particulars shall be deemed to be a statement that the property is in good repair or condition or otherwise nor that any services or facilities are in good working order. 7 Photographs may show only certain parts and aspects of the property at the time when the photographs were taken and you should rely upon actual inspection. 8 No assumption should be made in respect of parts of the property not shown in photographs. 9 Any areas, measurements or distances are only approximate. 10 Any reference to alterations or use is not intended to be a statement that any necessary planning, building regulation, listed building or any other consent has been obtained. 11 Amounts quoted are exclusive of VAT if applicable. 12 Whilst reasonable endeavours have been made to ensure the accuracy of any floor plan contained in these particulars, all measurements and areas are approximate and no responsibility is taken for any error, omission or mis-statement. This plan is for illustrative purposes only and should be used as such by any prospective purchaser. 12a Any mapping contained within these particulars is for illustrative purposes only and should be used as such by any prospective purchaser. No responsibility is taken for any error, omission or mis-statement.





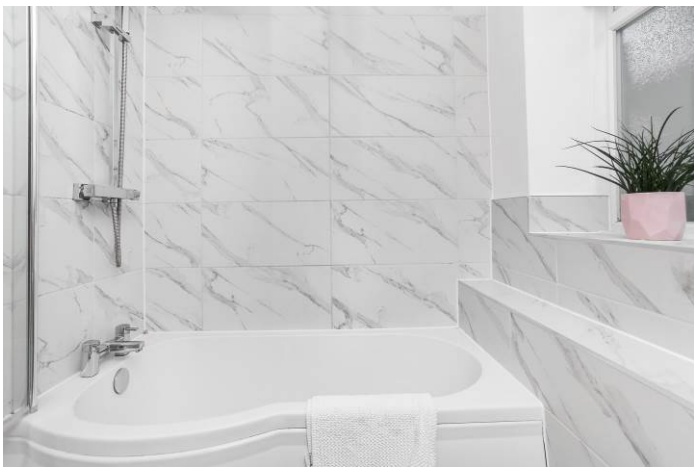

Grand Court, Folkestone, CT20

Approximate Gross Internal Area = 72.8 sq m / 784 sq ft

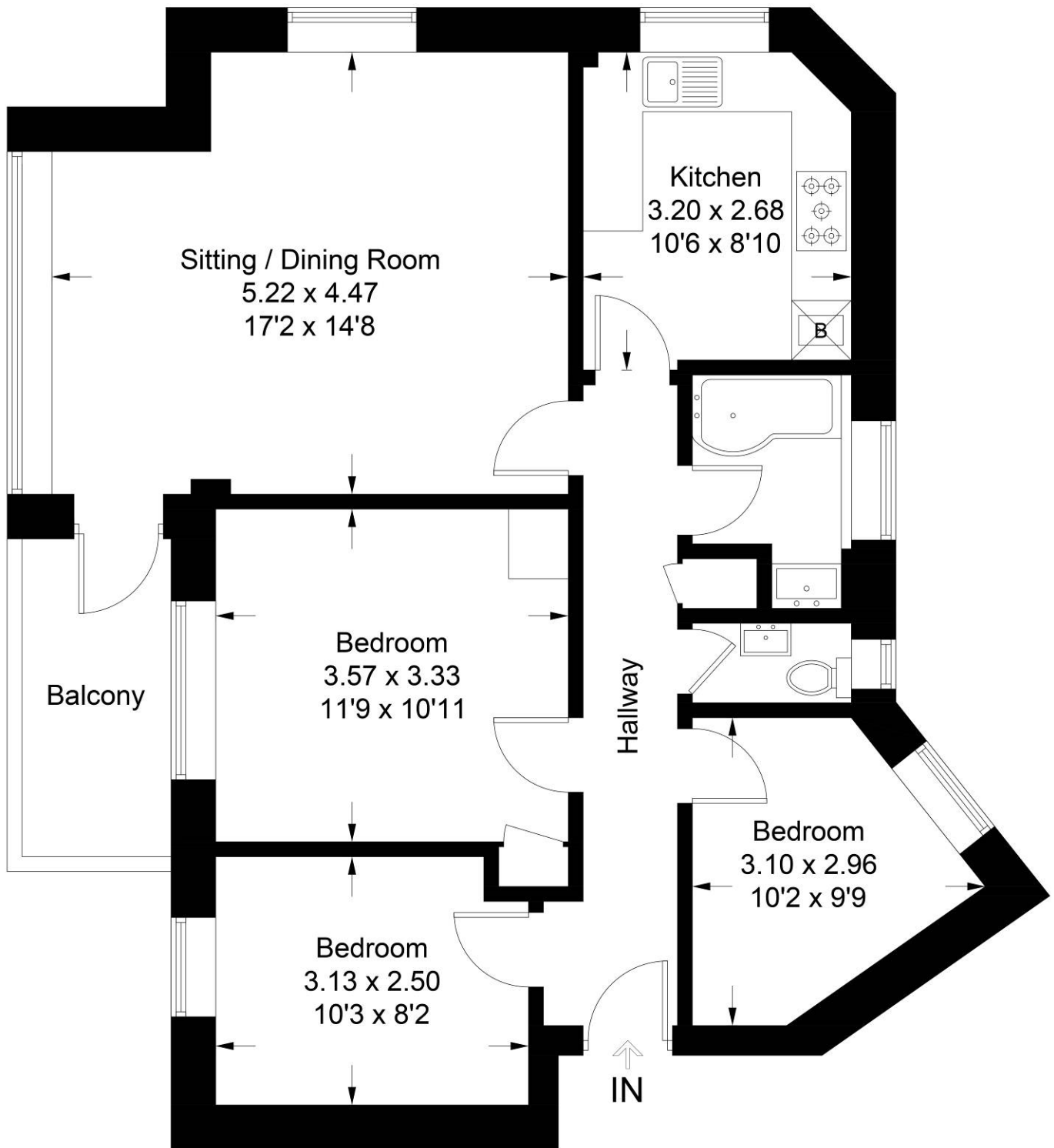

Illustration for identification purposes only, measurements are approximate, not to scale. floorplansUsketch.com © (ID1097071)