



Flora Gardens, Hammersmith, W6

4 Bedrooms

£3,000 per month



LONDON ESTATES



LOTS OF STORAGE | SEPARATE KITCHEN | NEW FLOORING | NEWLY DECORATED | BALCONY | EXCELLENT LOCATION

Available Date: 20th January 2023

EPC Rating: C | Council Tax: C - £3,000 per month



LONDON ESTATES

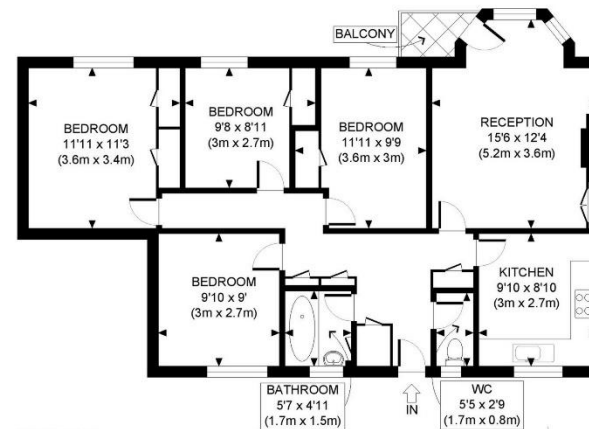

FIRST FLOOR
GROSS INTERNAL
FLOOR AREA 862 SQ FT

APPROX. GROSS INTERNAL FLOOR AREA: 862 SQ FT/ 80 SQM

PROPERTY PHOTO PLANS.CO.UK
ONE STOP SHOP FOR PROPERTY MARKETING

This plan is for illustrative purposes only and should be used as such by any prospective client. Whilst every attempt has been made to ensure the accuracy of the Floor Plan contained here, measurements of the doors, windows, rooms and any other items are approximate and no responsibility is taken for any errors, omissions, or misstatement. The services, systems and appliances shown have not been tested and no guarantee as to the operability or efficiency can be given.