



Dalling Road, Hammersmith, W6

2 Bedrooms

£1,600 per month



LONDON ESTATES



Two bedrooms | Open plan living/kitchen | Close to local amenities | Excellent transport links

Available Date: 18th April 2021

EPC Rating: D | Council Tax: D - £1,600 per month



LONDON ESTATES

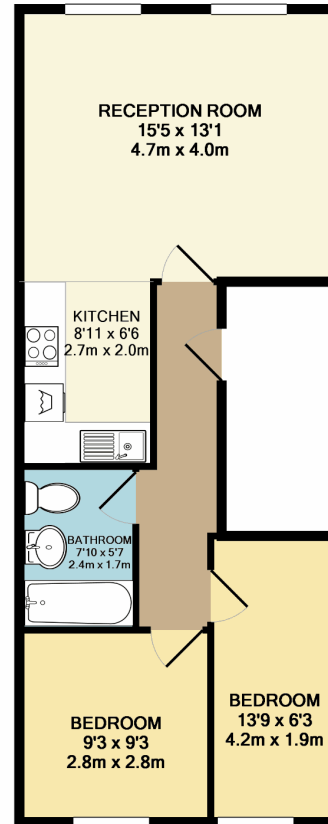

FIRST FLOOR FLAT DALLING ROAD LONDON W6 0JA
TOTAL APPROX. FLOOR AREA 535 SQ.FT. (49.7 SQ.M.)

Whilst every attempt has been made to ensure the accuracy of the floor plan contained here, measurements of doors, windows, rooms and any other items are approximate and no responsibility is taken for any error, omission, or mis-statement. This plan is for illustrative purposes only and should be used as such by any prospective purchaser. The services, systems and appliances shown have not been tested and no guarantee as to their operability or efficiency can be given

Made with Metropix ©2014