



**Disbrowe Road, Hammersmith, W6**

1 Bedrooms

**£1,300 per month**



LONDON ESTATES



**\*Professionally Managed\*** | Ground floor | Separate kitchen | Lots of natural light | Close to Munster Village

**Available Date: 27<sup>th</sup> August 2021**

**EPC Rating: C | Council Tax: D - £1,300 per month**



LONDON ESTATES

## Disbrowe Road

Approx. Gross Internal Area  
34.32 Sq M - 369 Sq Ft

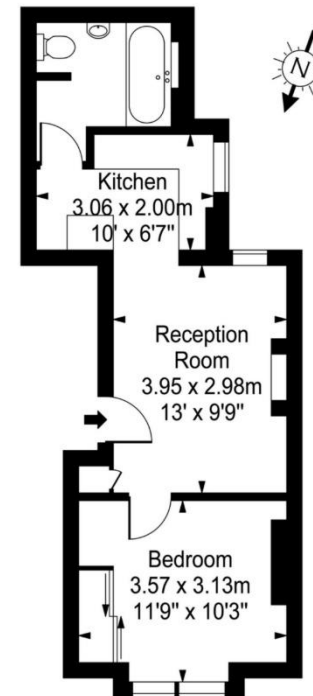

Every attempt is made to assure accuracy, however measurements are approximate and for illustrative purposes only. Not to scale.  
Floor plan by [www.frameworkphotos.co.uk](http://www.frameworkphotos.co.uk)