



Disbrowe Road, Hammersmith, W6

1 Bedrooms

£1,600 per month



LONDON ESTATES



COUNCIL TAX - £1,228 | PROFESSIONALLY MANAGED | GROUND FLOOR | SEPARATE KITCHEN | LOTS OF NATURAL LIGHT | CLOSE TO

Available Date: 2nd September 2023

EPC Rating: C | Council Tax: D - £1,600 per month



LONDON ESTATES

Disbrowe Road

Approx. Gross Internal Area
34.32 Sq M - 369 Sq Ft

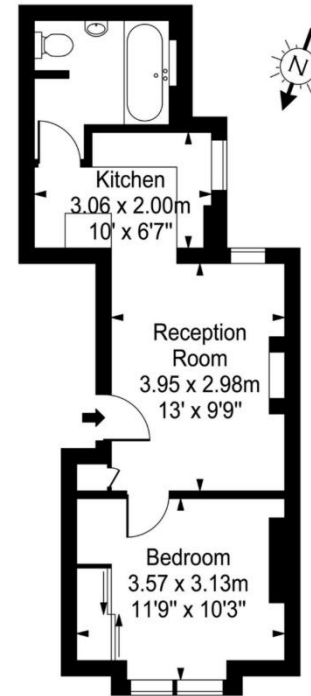

Every attempt is made to assure accuracy, however measurements are approximate and for illustrative purposes only. Not to scale.
Floor plan by www.frameworkphotos.co.uk