



**Tasso Road, Hammersmith, W6**

3 Bedrooms

**£2,000 per month**



LONDON ESTATES



Period Building | Amazing location | Quiet side street | Fully fitted Kitchen

Available Date: 1<sup>st</sup> August 2021

EPC Rating: E | Council Tax: D - £2,000 per month



LONDON ESTATES

## Tasso Road

Approx. Gross Internal Area  
72 Sq M - 775 Sq Ft  
(Excluding Eaves Storage)

Key:  
----- Reduced headroom below 1.5m / 5ft

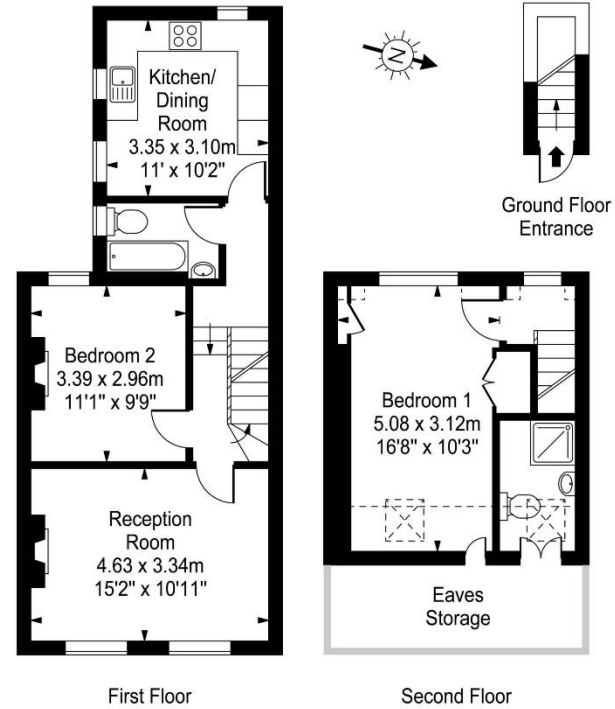

Every attempt is made to assure accuracy, however measurements are approximate and for illustrative purposes only. Not to scale.  
Floor plan by [www.frameworkphotos.co.uk](http://www.frameworkphotos.co.uk)