



**Broadfield Lane, Kings Cross, NW1**

1 Bedrooms

**£2,100 per month**



LONDON ESTATES



New build | Utility Bills Included (except Council Tax) | Private balcony | High End Finish | Fully Fitted Kitchen | Built In Storage

Available Date: 17<sup>th</sup> March 2022

EPC Rating: B | Council Tax: E - £2,100 per month



LONDON ESTATES

## York Way

Approx. Gross Internal Area  
51 Sq M - 550 Sq Ft

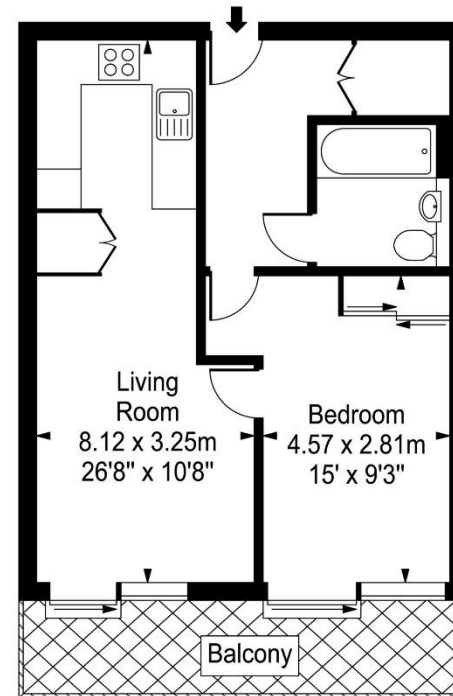

Third Floor

Every attempt is made to assure accuracy, however measurements are approximate and for illustrative purposes only. Not to scale.  
Floor plan by [www.frameworkphotos.co.uk](http://www.frameworkphotos.co.uk)