



## Broadfield Lane, Kings Cross, NW1

1 Bedroom Apartment

**£2,500 per month**



LONDON ESTATES



NEW BUILD | HIGH END FINISH | FULLY FITTED KITCHEN | BUILT-IN STORAGE | UNDERFLOOR HEATING | PRIVATE BALCONY

Available Date: 26<sup>th</sup> March 2024

EPC Rating: B | Council Tax Band: E



LONDON ESTATES

## York Way

Approx. Gross Internal Area  
51 Sq M - 550 Sq Ft

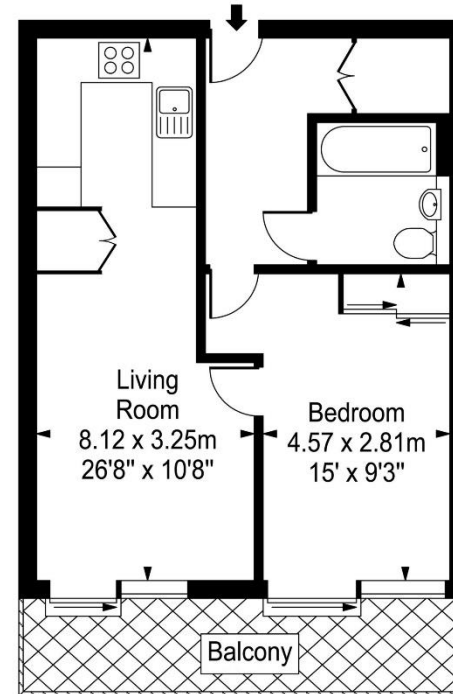

Third Floor

Every attempt is made to assure accuracy, however measurements are approximate and for illustrative purposes only. Not to scale.  
Floor plan by [www.frameworkphotos.co.uk](http://www.frameworkphotos.co.uk)