



Margravine Gardens, Hammersmith, W6

1 Bedrooms

£2,175 per month



LONDON ESTATES



| ALL BILLS INCLUDED | ONE BEDROOM APARTMENT | PRIVATE PATIO GARDEN | FULLY FURNISHED | GOOD TRANSPORT LINKS

Available Date: 1st May 2021

EPC Rating: C | Council Tax: C - £2,175 per month



LONDON ESTATES

Margravine Gardens

Approx. Gross Internal Area
42 Sq M - 449 Sq Ft

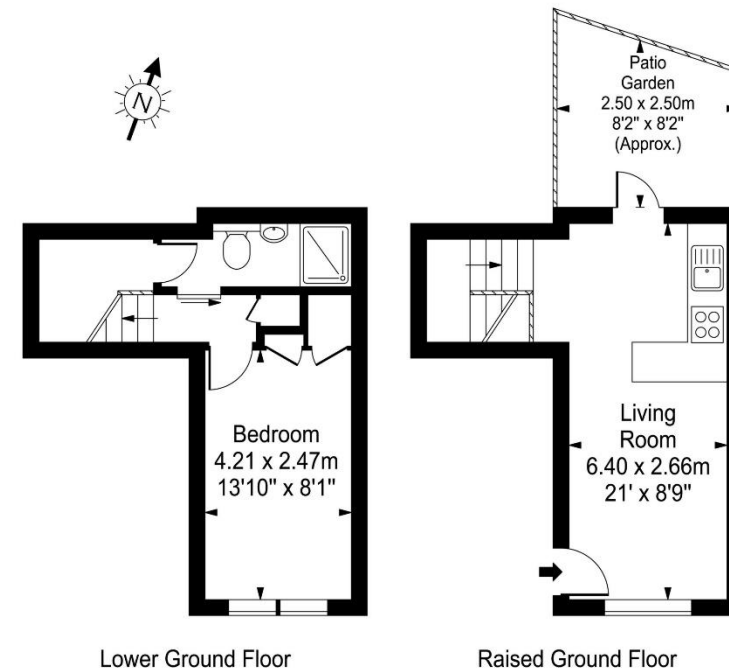

Every attempt is made to assure accuracy, however measurements are approximate and for illustrative purposes only. Not to scale.
Floor plan by www.frameworkphotos.co.uk