



Melina Road, Shepherds Bush, W12

2 Bedrooms

£1,425 per month



LONDON ESTATES



CT £1,063 | TWO BEDROOMS | NEW KITCHEN | GOOD LOCATION | CLOSE TO SHOPPING FACILITIES | TRANSPORT AT GOLDHAWK



LONDON ESTATES

Available Date: 24th June 2022

EPC Rating: D | Council Tax: C - £1,425 per month



APPROX GROSS INTERNAL FLOOR AREA: 43 sq. m / 467 sq. ft

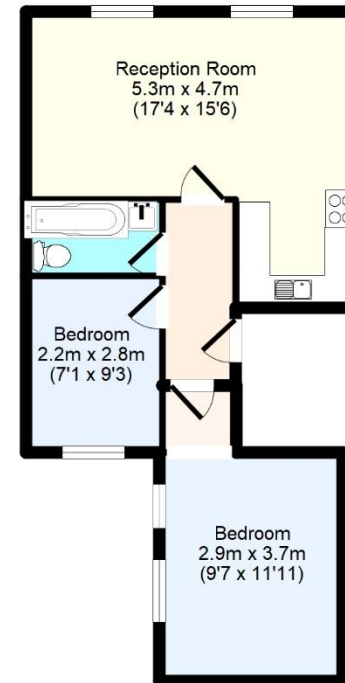

MELINA ROAD LONDON W12

