



Fulham High Street, Fulham, SW6

Parkview Court | 2 Bedrooms

£2,375.00 per month



LONDON ESTATES



NEWLY REFURBISHED | NEW CARPET | SEPARATE
KITCHEN | UNFURNISHED | PORTER | LIFT

Available Date: 4th June 2024

EPC Rating: D | Council Tax: D - £1,387 per year



LONDON ESTATES

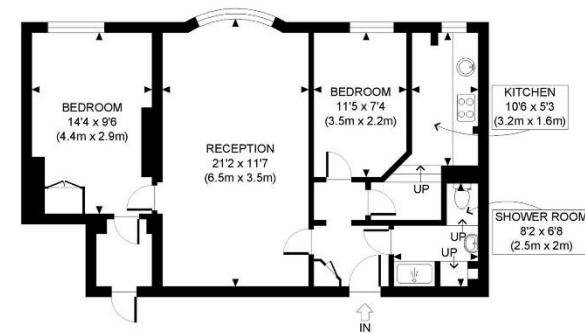

FOURTH FLOOR
GROSS INTERNAL
FLOOR AREA 686 SQ FT

APPROX. GROSS INTERNAL FLOOR AREA: 686 SQ FT/ 64 SQM

PROPERTY PHOT PLANS.CO.UK
ONE STOP SHOP FOR PROPERTY MARKETING

This plan is for illustrative purposes only and should be used as such by any prospective client. Whilst every attempt has been made to ensure the accuracy of the Floor Plan contained here, measurements of the doors, windows, rooms and any other items are approximate and no responsibility is taken for any errors, omissions, or misstatement. The services, systems and appliances shown have not been tested and no guarantee as to the operability or efficiency can be given.