



Porchester Road, Bayswater, W2

Peters Court | 0 Bedrooms

£1,750 per month



LONDON ESTATES



AMAZING LOCATION | BRIGHT APARTMENT | CLOSE TO HYDE PARK | EXCELLENT TRANSPORT LINKS | HEATING & HOTWATER INCLUDED

Available Date: 4th May 2024

EPC Rating: C | Council Tax: B - £1,750 per month



LONDON ESTATES

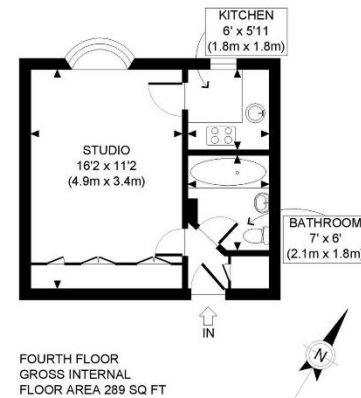

FOURTH FLOOR
GROSS INTERNAL
FLOOR AREA 289 SQ FT

APPROX. GROSS INTERNAL FLOOR AREA: 289 SQ FT/ 27 SQM

PROPERTY PHOTO PLANS.co.uk
ONE STOP SHOP FOR PROPERTY MARKETING

This plan is for illustrative purposes only and should be used as such by any prospective client. Whilst every attempt has been made to ensure the accuracy of the Floor Plan contained here, measurements of the doors, windows, rooms and any other items are approximate and no responsibility is taken for any errors, omissions, or misstatement. The services, systems and appliances shown have not been tested and no guarantee as to the operability or efficiency can be given.