



**Gunterstone Road, West Kensington, W14**

1 Bedrooms

**£1,995 per month**



LONDON ESTATES



EXCELLENT LOCATION | OPEN PLAN LIVING ROOM | PRIVATE  
BALCONY | HIGH CEILINGS | GOOD TRANSPORT LINKS

Available Date: 5<sup>th</sup> September 2025

EPC Rating: D | Council Tax: D - £1,995 per month



LONDON ESTATES

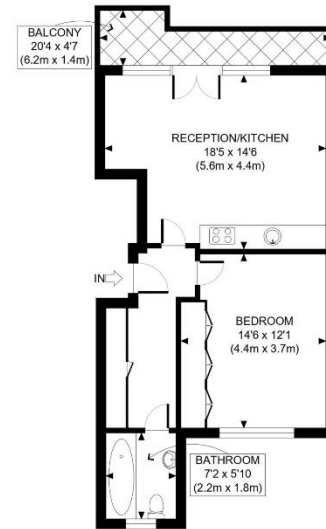

FIRST FLOOR  
GROSS INTERNAL  
FLOOR AREA 548 SQ FT

APPROX. GROSS INTERNAL FLOOR AREA: 548 SQ FT/ 51 SQM

**PROPERTY PHOTO PLANS**.CO.UK  
ONE STOP SHOP FOR PROPERTY MARKETING

This plan is for illustrative purposes only and should be used as such by any prospective client. Whilst every attempt has been made to ensure the accuracy of the Floor Plan contained here, measurements of the doors, windows, rooms and any other items are approximate and no responsibility is taken for any errors, omissions, or misstatement. The services, systems and appliances shown have not been tested and no guarantee as to the operability or efficiency can be given.