

MAPESBURY



Park Avenue, Willesden Green, NW2

SOLD £529,950

- One Bedroom (First Floor)
- Stylish Period Interiors
- Entryphone | Ample Storage
- Calling First Time Buyers
- Chain-Free & Ready to Move in
- Private Terrace with views
- High Ceilings | Bay Window
- LH + Share of Freehold

Park avenue, NW2 5AN

Approx Gross Internal Area = 63.1 sq m / 679 sq ft

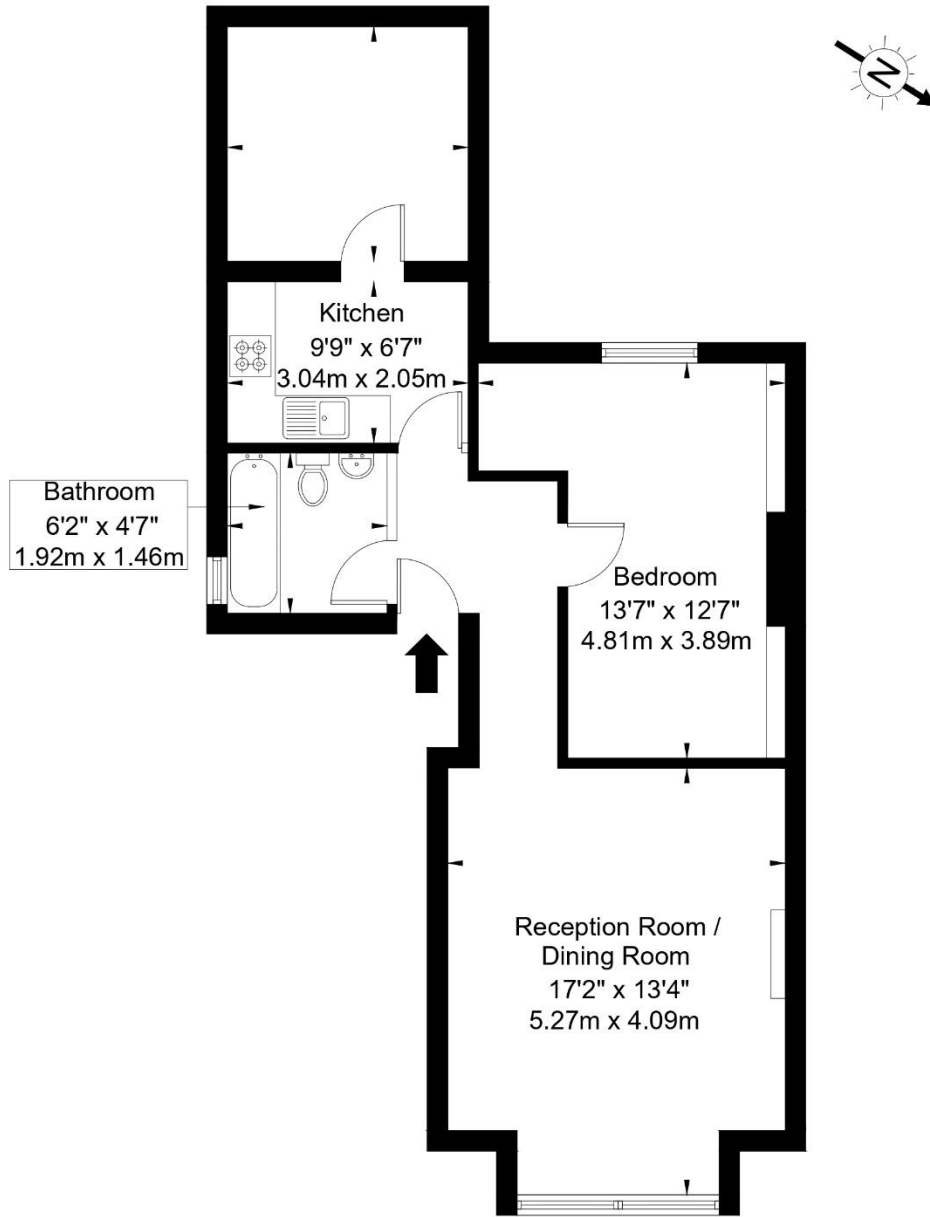

First Floor

Ref:

Copyright **BLEU
PLAN**

The Floor plan is not to scale and measurements and areas shown are approximate and therefore should be used for illustrative purposes only. The plan has been prepared in accordance with the RICS code of Measuring Practice and whilst we have confidence in the information produced it must not be relied on. If there is any aspect of particular importance, you should carry out or commission your own inspection of the property.

Copyright @ BLEUPLAN