



**MAPESBURY**  
ESTATE AGENTS



**Manor House Drive, Brondesbury, NW6 £3,950,000 Freehold**

- Ambassadorial Home
- Private Driveway
- Detached and Gated
- 3 Floors with Loft
- 5 Bedroom 4 Bathroom
- Close to Amenities
- Private Balcony/Terrace
- Close to Schools

**Manor House Drive, Brondesbury Park, London NW6**



Denotes restricted head height

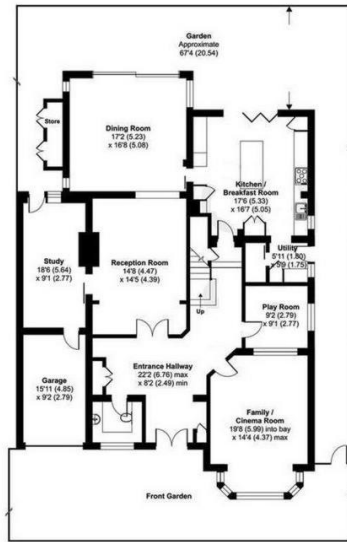

GROUND FLOOR

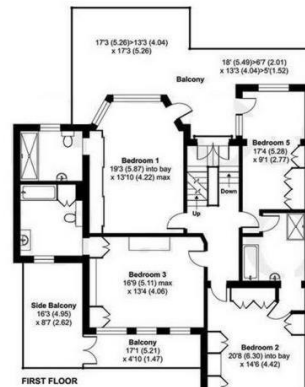

FIRST FLOOR

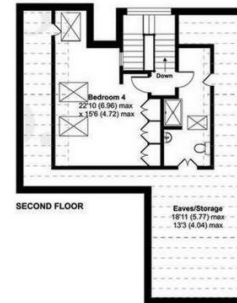

SECOND FLOOR

**Approximate Area = 3684 Sq Ft (342 Sq M) excl. store**  
**Limited Use Area(s) = 609 Sq Ft (56.5 Sq M)**  
**Garage = 145 Sq Ft (13.4 Sq M)**  
**Total = 4438 Sq Ft (412.3 Sq M)**  
**Balconies = 603 Sq Ft (56 Sq M)**