



**Hassop Road, Cricklewood, NW2**

**£25,000 per annum**

- Ground Floor Unit
- Kitchen/Bathroom
- 5 Individual Rooms
- Air Conditioning
- Parking Space
- EPC Rating: A
- New Lease 15 Years
- Size: 761 Sq Ft

# Hassop Road Cricklwood NW2 6RX

Approx. Gross Internal Area = 70.7 sq m / 761 sq ft

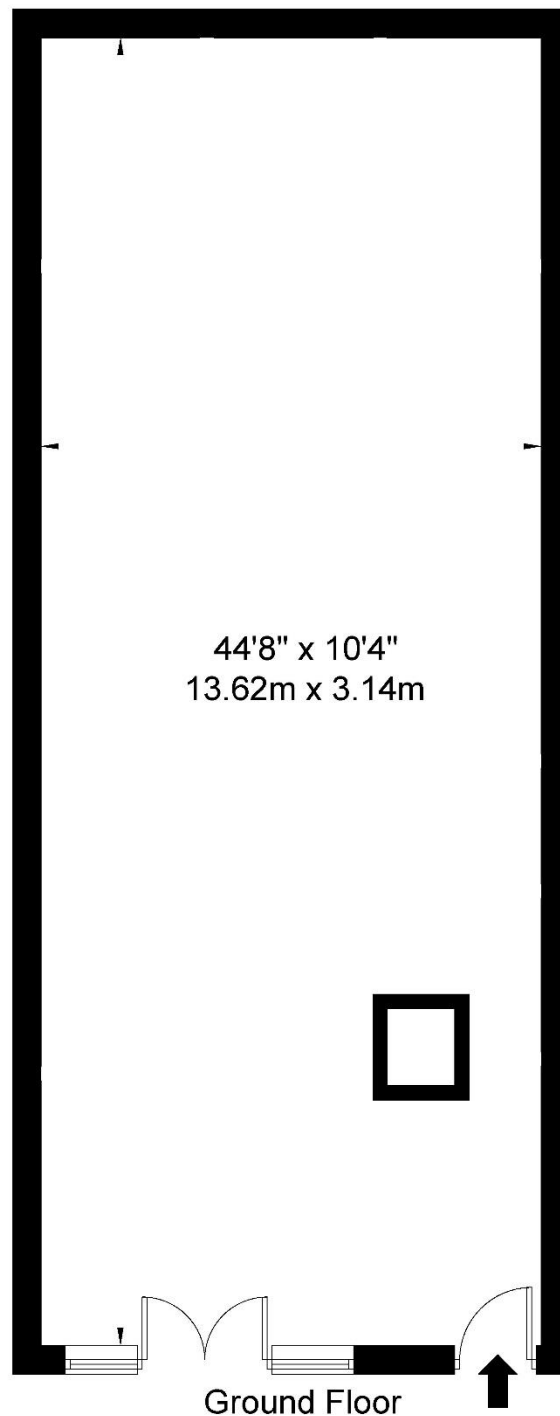

Ref

Copyright **BLEU  
PLAN**

The Floor plan is not to scale and measurements and areas shown are approximate and therefore should be used for illustrative purposes only. The plan has been prepared in accordance with the RICS code of Measuring Practice and whilst we have confidence in the information produced it must not be relied on. If there is any aspect of particular importance, you should carry out or commission your own inspection of the property.

Copyright @ BLEUPLAN