

Wingston Close, Edmonton, N18

£190,000 Leasehold

Marble Sales and Lettings are pleased to offer this one bedroom purpose built flat. The flat is situated within 1/4 of a mile from the North Middlesex hospital and the A10 and A406 road links. This one bedroom is in a good decorative order. Allocated parking and communal gardens.

Wingston Close, Edmonton, N18



Wingston Close, Edmonton, N18

Wingston Close, Edmonton, N18

Wigston Close N18

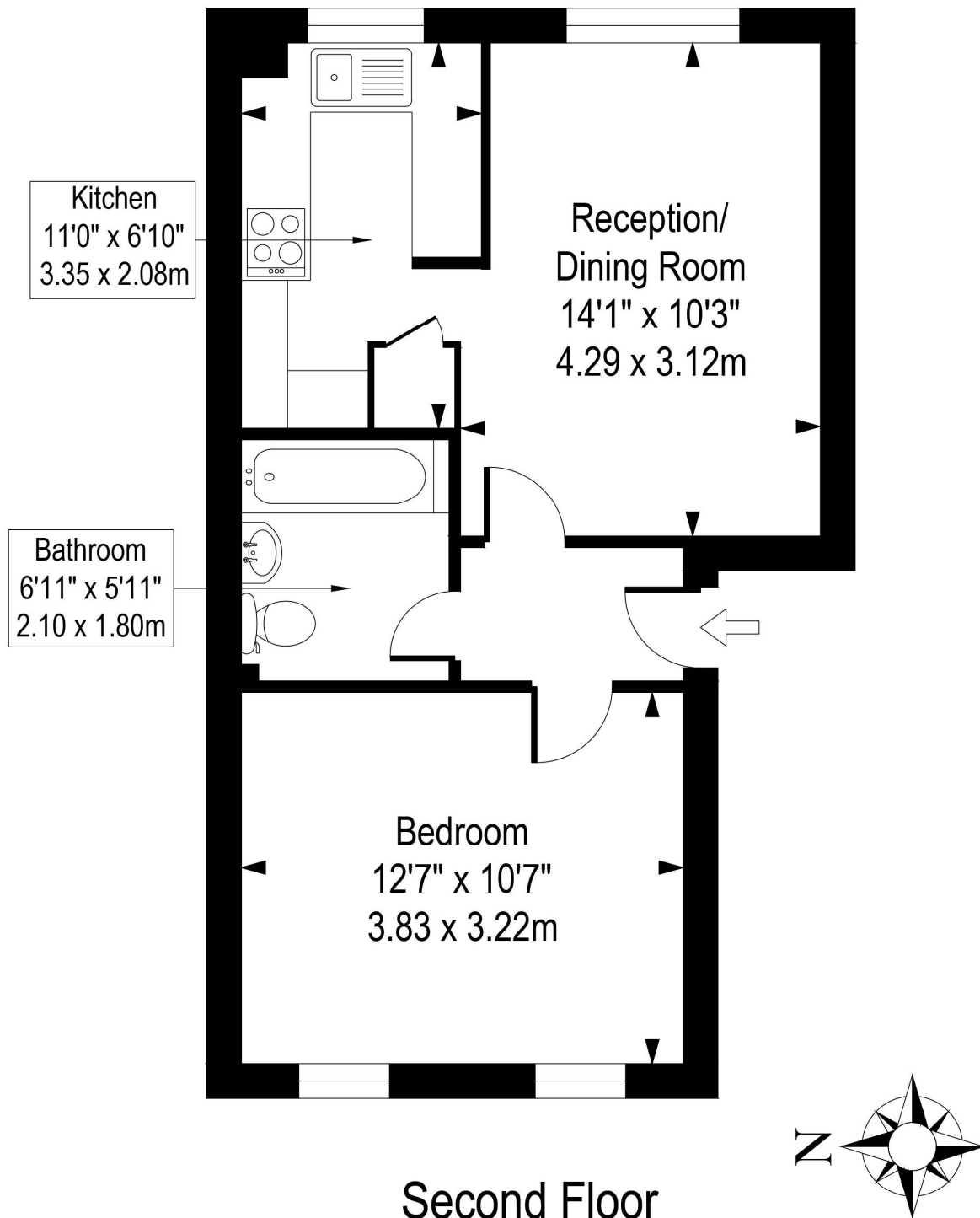

Approx Gross Internal Area: 421 Sq Ft - 39 Sq M

Illustration for identification purposes only, measurements are approximate, not to scale.

Whilst every care is taken to ensure the accuracy of these details no responsibility for errors or misdescription can be accepted nor is any guarantee offered in respect of the property. These particulars do not constitute any part of an offer or contract.