



2 Bedroom Apartment
Hilltop Road
London NW6

- Huge Mansion Flat
- Top Floor
- Two Beds
- Beautiful Bathroom

Price: £715.38 pw / £3,100 pcm

St James Mansions, Hilltop Road NW6 2AA
Approximate gross Internal Area
70.69 sq m / 761 sq ft

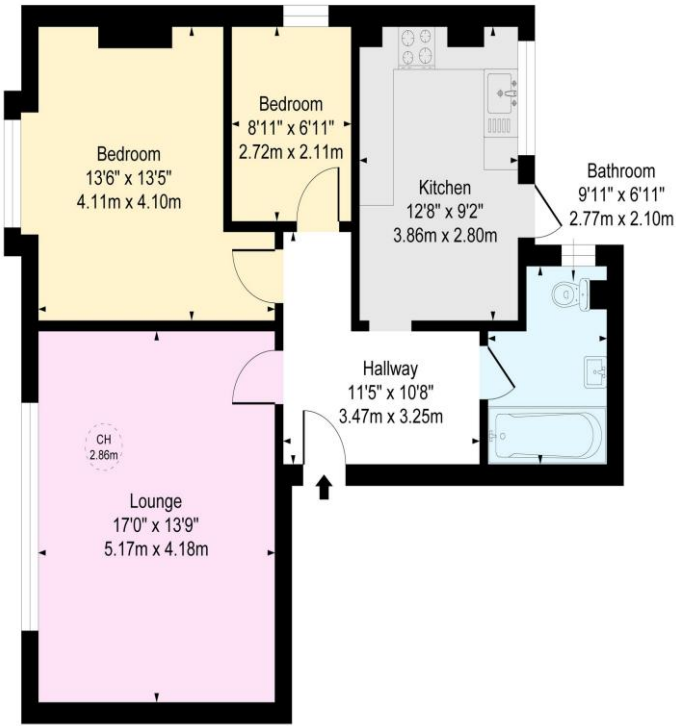

Third Floor

This floor plan is for illustrative purposes only and must not be relied upon as a statement of fact.



Energy Efficiency Rating		
	Current	Potential
<i>Very energy efficient - lower running costs</i>		
(92-100) A		
(81-91) B		
(69-80) C		
(55-68) D		
(39-54) E	48	57
(21-38) F		
(1-20) G		
<i>Not energy efficient - higher running costs</i>		
England, Scotland & Wales	EU Directive 2002/91/EC	

An absolute gem of a property, set on this quiet turning just off West End Lane is St. James Mansions. This COMPLETELY REFURBISHED TWO-BEDROOM third floor (top) apartment set within this immaculate mansion block. With access to communal rear gardens, this bright and spacious flat features a large KITCHEN DINING ROOM complete with fully integrated appliances. Hilltop Road is located in the heart of West Hampstead moments from West Hampstead Overground Thameslink and Jubilee Line station along with a variety of bars cafes and restaurants. Available from Aug 1st, Call now to book a viewing.

ML Estates wish to advise prospective purchasers that we have not checked the services or appliances. These particulars have been prepared as a guide only, any floor-plan or map is for illustrative purposes only. ML Estates, for themselves and for the vendors or lessors of this property whose agents they are given notice that: the particulars have been produced in good faith; do not constitute any part of a contract; no person in the employment of ML Estates has any authority to make or give any representation of warranty in relation to this property.