



8 CHARLOTTE STREET, FOLKESTONE

£210,000 Freehold

A charming Two Bedroom Terraced Home, situated close to Folkestone's vibrant harbour and Creative Quarter... Welcome to Charlotte Street!



8 Charlotte Street Folkestone CT20 1LF

- Two Bedroom Terraced Home
 - Popular Seaside Location
- Close To Folkestone's Harbour & Creative Quarter
 - Great Transport Links

Description

This charming two-bedroom terraced house on Charlotte Street in Folkestone offers a perfect blend of modern convenience and coastal charm. Nestled just a stone's throw away from the picturesque harbour and the vibrant Creative Quarter, the property enjoys an enviable location that captures the essence of seaside living.

Upon entering, you are welcomed by a warm and inviting living space that exudes character, enhanced by natural light streaming through generous windows. The adjoining kitchen is well-equipped and thoughtfully designed, providing an ideal space for culinary pursuits and casual dining.

Upstairs, you'll find two comfortable bedrooms, offering a peaceful retreat after a long day, along with a tastefully appointed bathroom that combines style and functionality.

The rear garden is a delightful space, perfect for enjoying the fresh sea air or entertaining guests in the warmer months.

With its proximity to local amenities, restaurants, and the stunning shoreline, this home is an excellent opportunity for those seeking a coastal lifestyle. Whether you're a first-time buyer, a small family, or an investor, this terraced house on Charlotte Street stands as a truly inviting option in one of Folkestone's most desirable locales.

Tenure Freehold

Postcode CT20 1LF

Viewings Strictly by appointment only - Property
Reference MOTIS_005747

Opening Hours:

Monday - Friday 9.00 - 5.30

Saturday 9.00 - 3.00





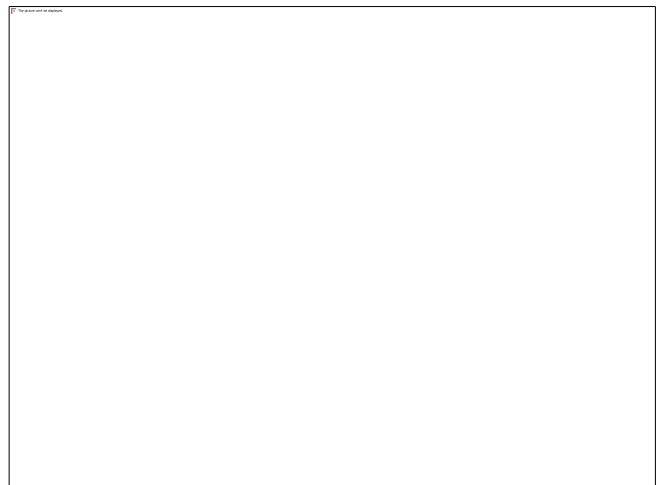

GROUND FLOOR
446 sq.ft. (41.4 sq.m.) approx.

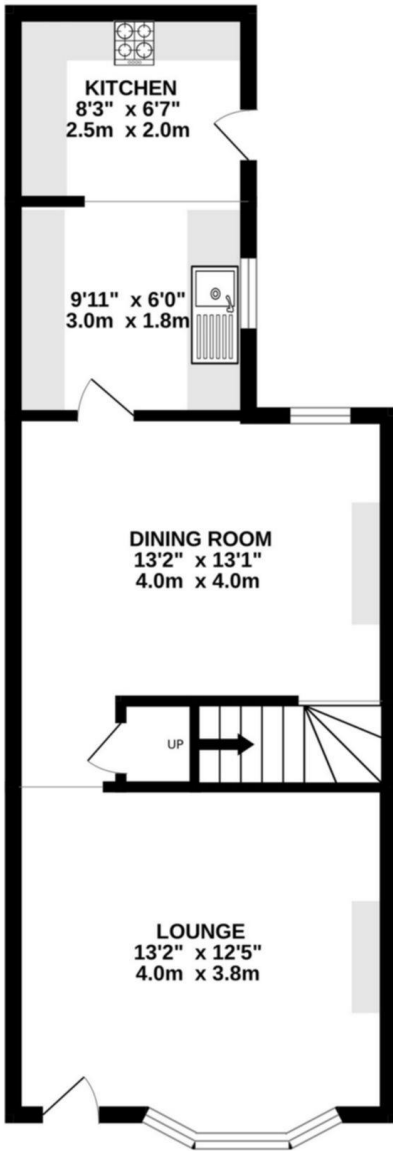

1ST FLOOR
387 sq.ft. (36.0 sq.m.) approx.



TOTAL FLOOR AREA : 833 sq.ft. (77.4 sq.m.) approx.

Whilst every attempt has been made to ensure the accuracy of the floorplan contained here, measurements of doors, windows, rooms and any other items are approximate and no responsibility is taken for any error, omission or mis-statement. This plan is for illustrative purposes only and should be used as such by any prospective purchaser. The services, systems and appliances shown have not been tested and no guarantee as to their operability or efficiency can be given.
Made with Metropix ©2024

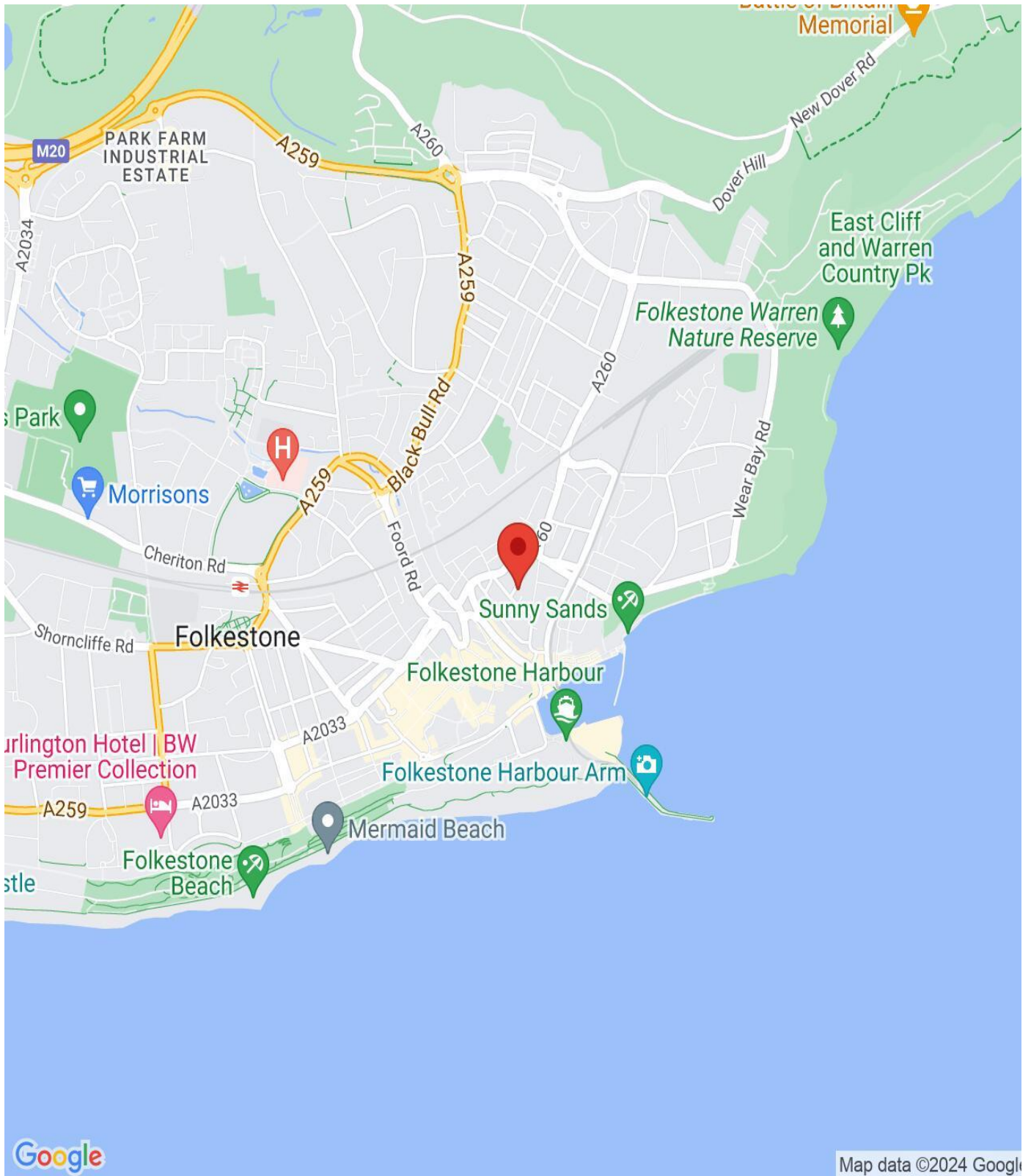

IMPORTANT NOTICE

Descriptions of the property are subjective and are used in good faith as an opinion and NOT as a statement of fact. Please make further specific enquires to ensure that our descriptions are likely to match any expectations you may have of the property. We have not tested any services, systems or appliances at this property. We strongly recommend that all the information we provide be verified by you on inspection, and by your Surveyor and Conveyancer.