



Osbornes
Independent estate agents

Albert Road | Farnborough

CHARACTER HOME.

Four Double Bedrooms | Studio Flat/Annexe | Three Reception Rooms | Three Bathrooms | Double Garage | No Onward Chain

£905,000 | Freehold

CHARACTER HOME. This stunning imposing character attached house built in 1896 offers 3755 sq ft in space and benefits from reception hall, three reception rooms, kitchen/breakfast room, downstairs cloakroom, four double bedrooms, family bathroom, en-suite bathroom, studio flat/Annexe to top floor. The property offers a huge amount of character with its inglenook fireplace, original herringbone wooden floors, 10ft high ceilings, original leaded windows and stone windows. Located on the fringes of Farnborough Park set in an ideal location for the commuter with excellent bus routes, rail, road and general transport networks; Farnborough mainline station will take you into London Waterloo in under 40 minutes and there is access to the M3 bringing Farnham, Fleet, Basingstoke and Camberley within easy reach. NO ONWARD CHAIN. EPC D - Council Tax Band E



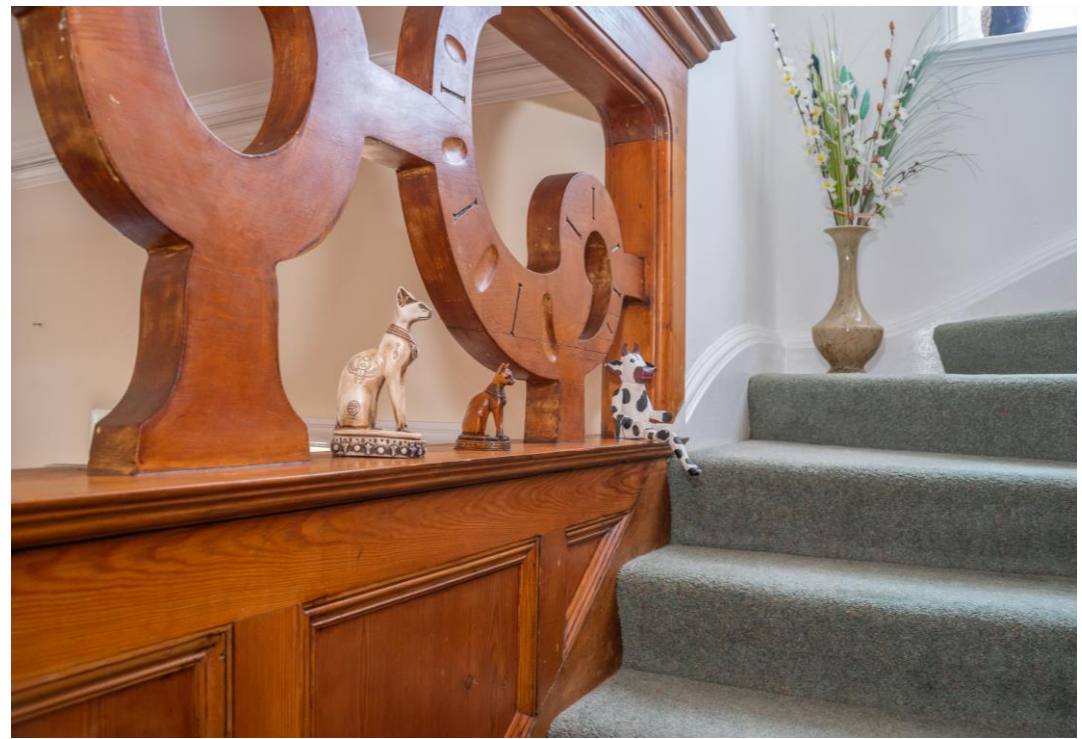

Approximate Gross Internal Area
 Ground Floor = 122.5 sq m / 1318 sq ft
 First Floor = 115.6 sq m / 1244 sq ft
 Second Floor = 66.6 sq m / 717 sq ft
 Garage / Utility = 44.2 sq m / 476 sq ft
 Total = 348.9 sq m / 3755 sq ft (Excluding Eaves)

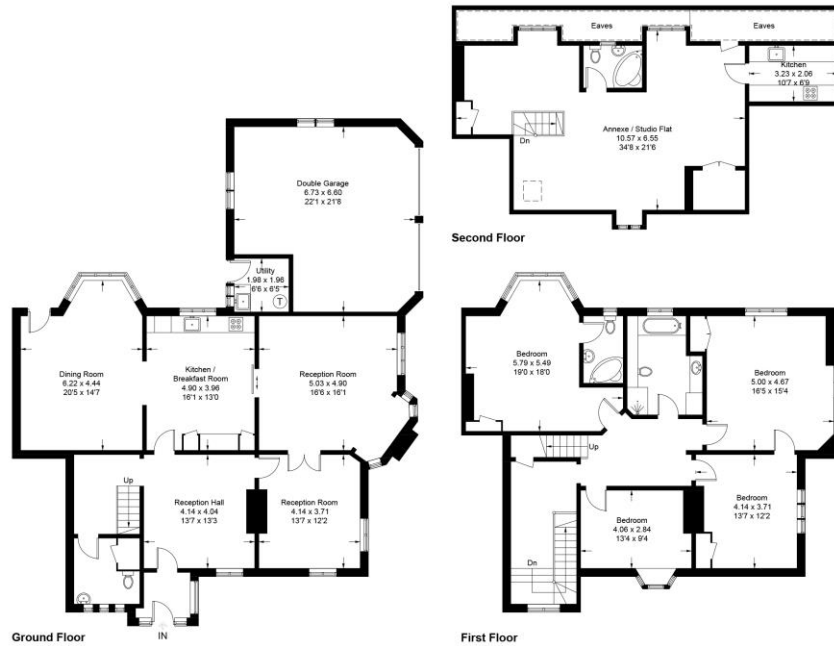

Albert Road

Illustration for identification purposes only, measurements are approximate, not to scale. FloorplansUsketch.com © 2022 (ID865432)

Osbornes Estate Agents

38a Camp Road, Farnborough, Hampshire, GU14

01252 370707 | info@osbornesestateagents.co.uk | www.osbornesestateagents.co.uk

Important Notice - These particulars have been prepared in good faith and they are not intended to constitute part of an offer or contract. We have not performed a structural survey on this property and the services, appliances and specific fittings have not been tested. All photographs, measurements, floor plans and distances referred to are given as a guide and should not be relied upon.

