



**FOR
SALE**



Wilton Bank, Saltburn, TS12

£169,995 Freehold

- Living Room
- Bathroom
- Garage
- Double Glazing
- Generous Garden Space

- Kitchen
- Two Bedrooms
- Gas Central Heating
- Feature Fireplace
- Great Condition Throughout

Wilton Bank, Saltburn, TS12

We are pleased to offer for sale this delightful two-bedroom bungalow situated on Wilton Bank Saltburn.

The property benefits from feature FIREPLACE and WALLS in the Living Room and a GENEROUS GARDEN and throughout the property has been maintained to a good standard and ready to move straight into.

Briefly the accommodation comprises; Entrance Hall, Living Room, Kitchen, Two Bedrooms, Bathroom, Garden Room, Rear Enclosed Garden, Garage, Driveway.

Hallway

Carpeted. Single radiator. Electric distribution board. Intruder alarm. Loft access.

Living Room 16'3" x 11'2"

Carpeted. Double radiator. Virgin Media point. TV Point. Reclaimed wood feature wall. Feature fireplace with electric fire.

Kitchen 10'4" x 8'9"

Tiled flooring. Single radiator. Partially tiled around kitchen area. Fully fitted kitchen with base and wall mounted units. Stainless steel sink, one and a half bowls with drainer and mixer tap. Neff induction hob. Neff electric oven. Extractor fan. Recessed spotlights to ceiling. Roller blinds. Glow Worm boiler. UPVC door leading to garden room.

Garden Room 7'7" x 5'9"

Carpeted. Door leading to garden.

Bedroom 1 13'7" x 11'2"

Carpeted. Single radiator. Roller blind. Pelmet.

Bedroom 2 9'6" x 8'9"

Carpeted. Single radiator.

Bathroom 6'4" x 5'4"

Fully Tiled Including Flooring, Bath With Chrome Mixer Tap, Mains Fed Shower And Bath, Shower Screen, Pedestal Basin With Chrome Mixer, Toilet, Heated Towel Rail.

Garage

Roller door and separate side door for access.

Externally

Rear Garden; Laid To Lawn, Shrub Borders, Paved. Front Garden; Laid To Lawn, Shrub Borders. Driveway.

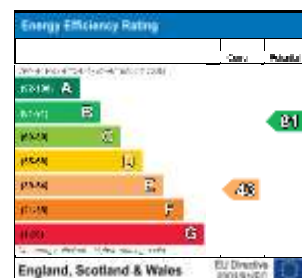

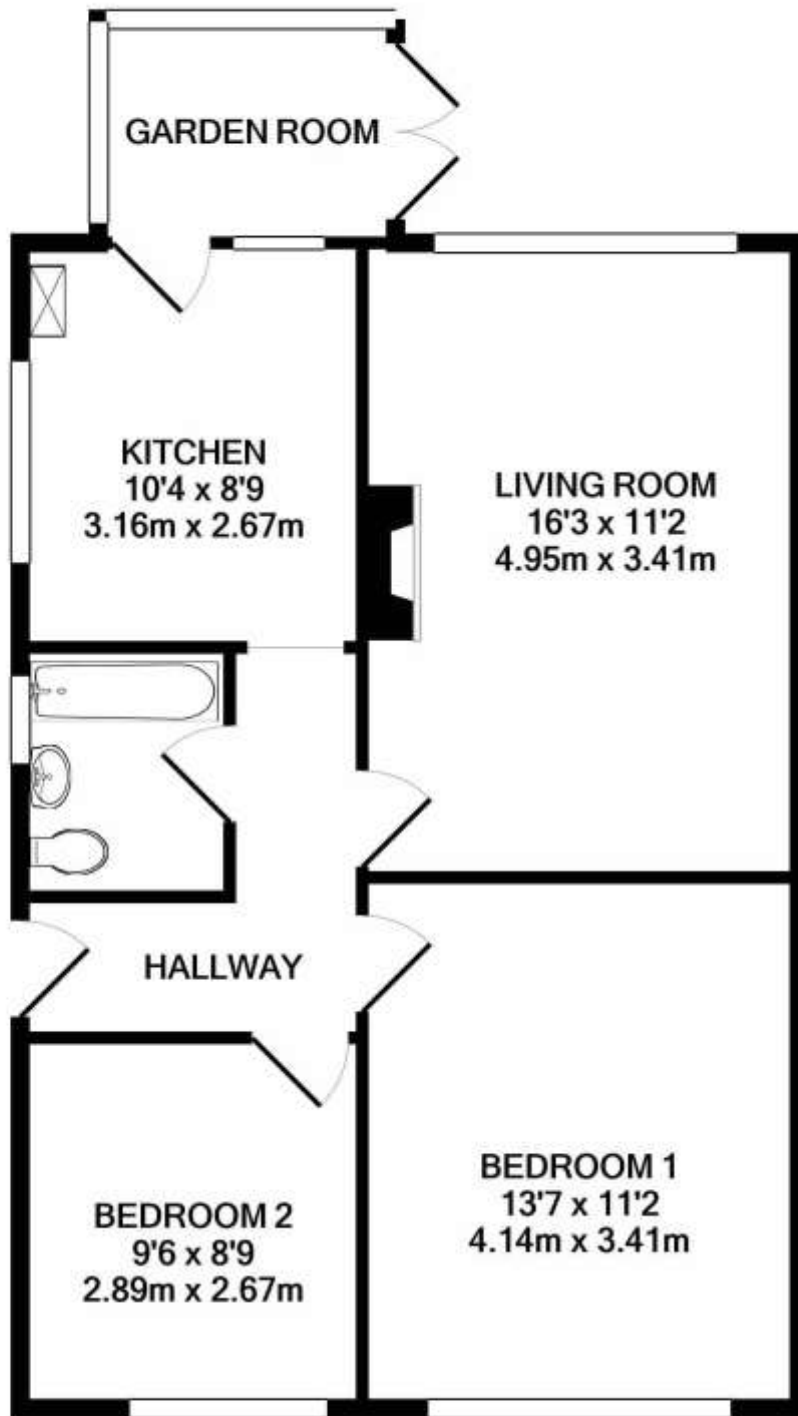

TOTAL APPROX. FLOOR AREA 639 SQ.FT. (59.3 SQ.M.)

Whilst every attempt has been made to ensure the accuracy of the floor plan contained here, measurements of doors, windows, rooms and any other items are approximate and no responsibility is taken for any error, omission, or mis-statement. This plan is for illustrative purposes only and should be used as such by any prospective purchaser. The services, systems and appliances shown have not been tested and no guarantee as to their operability or efficiency can be given

Made with Metropix ©2021

Whilst every care is taken to ensure the accuracy of these details no responsibility for errors or misdescription can be accepted nor is any guarantee offered in respect of the property. These particulars do not constitute any part of an offer or contract.